

Virgin LIMITED
EDITION

PREPARING FOR YOUR STAY

mahali mzuri 

SIR RICHARD BRANSON'S KENYAN SAFARI CAMP

We're delighted that you've chosen to stay with us at Mahali Mzuri

Whether it's your first time on safari or you are a seasoned expert, this document contains some important information to help you prepare for your stay with us.

You can also find out more about our COVID-19 health & safety measures on our [Keeping You Safe](#) page. We hope to answer most of your questions, but please feel free to get in touch if there is anything else. **See you soon!**



HOW DO I GET THERE?



INTERNATIONAL FLIGHTS

The main international airport in Nairobi, Kenya's capital, is Jomo Kenyatta International Airport, with daily direct flights from the main European hubs: London, Paris, Brussels and Amsterdam as well as New York.

There are also daily arrivals from Johannesburg in South Africa as well as from hubs in the Middle East including Dubai and Doha.

Flights from Europe take on average just over 8 hours and direct flights from New York will take 15 hours. For those connecting from any other USA hub will need to travel via one of the cities mentioned above.

ACCOMMODATION IN NAIROBI

Most international flights arrive in the morning however, if your flight arrives in the evening the next available domestic flight to Mahali Mzuri will be the following morning. This will mean that you'll need to stay overnight in Nairobi. Ask our reservation team for our recommended list of Nairobi City hotels.

CHECK-IN / CHECK-OUT

Don't worry if your flight is scheduled before the official check in time of 2pm. Just let us know in advance and we'll be there to collect you from the airstrip. Time to say goodbye is officially 11am on the day of your departure, but we can look after your luggage at camp if your flight isn't until later.

WILSON AIRPORT

Wilson Airport is the domestic airport in Nairobi with scheduled flights to the Olare Orok Airstrip. If you booked a transfer to Wilson Airport a local agent will meet you in the arrivals hall once you've collected your baggage and cleared customs. Look for the Mahali Mzuri logo which will be held up on a board. There are two airstrips close to Mahali Mzuri that we would recommend guests to use.

Both airstrips are served by flights operated by SafariLink Aviation and Air Kenya. Olare Orok is also served by Governor's Aviation. Special charter flights can also be arranged on request and they can land at the private airstrip in the conservancy, roughly 20 minutes' drive from camp.



If you're feeling adventurous arrive in style with a private helicopter transfer which can land right at our front door.

Traffic in Nairobi can be somewhat hectic and travel times can vary from 30 minutes to two hours between Nairobi International and Wilson airport. The longer transit times are down to the volume of traffic during peak periods – effectively the weekday morning and evening rush hours so make sure you leave plenty of time.

The lounge offers a selection of drinks and snacks but does not accept credit cards or American dollars for payment – it's advisable to have some Kenyan Shillings before you arrive as not all ATMs in the airport are friendly to foreign credit and debit cards. We should emphasise that the facilities at Wilson are quite basic, so make sure you've got everything you need before you arrive – there isn't a Duty Free shop!

LUGGAGE

The luggage limit on the flights from Wilson Airport to Mahali Mzuri is 15kg which includes your hand luggage. This is quite strictly enforced as the aircraft used doesn't have a lot of extra space. If you're on a longer trip and have additional luggage you can usually leave this at the terminal free of charge until you return. Please check with your airline before departing. At the other end, when you land at the Olare Orok Airstrip, our team will collect you in Mahali Mzuri vehicles for the 25 minute transfer to the camp.



ARRIVING IN KENYA



HEALTH AND IMMIGRATION

Virtually all visitors will need to apply and obtain an e-visa before travelling to Kenya, which can be done via the portal: www.evisa.go.ke/evisa.html. You can double check if you'll need to apply for an e-visa [here](#). Once approved, you'll be notified on email and sent a copy of your e-visa.

You're also required to have at least two blank pages in your passport, and it must be valid for 6 months beyond your expected departure date from Kenya. We recommend you check with your Foreign Office before you set off on your journey.

No vaccinations are required on entry unless you have just arrived from countries with a risk of yellow fever transmission. Malaria is still a risk in some areas of Kenya including the area where Mahali Mzuri is located so it is important to seek medical advice on appropriate precautions during your stay.

SPECIAL NOTE ON US DOLLARS: Kenyan banks and officials will only accept US dollars which were issued after the year 2000. On the front of each banknote is a note to say 'Series 2009' or similar which indicates the year of issue.



MEDICAL INSURANCE

AMREF, the flying doctors organisation based in Nairobi, provides air evacuation services in medical emergencies across East Africa, as well as air ambulance transfers between medical facilities. Their planes, some fitted with operating theatre and resuscitation room, can take you back to Nairobi and to its modern, efficient private hospitals in less than one hour. All you need to do is to subscribe to their insurance, it costs very little and whilst it's highly unlikely you'll need to use it, it gives you total peace of mind. For those who already have travel or health insurance, it's worth double checking what's included in the existing policy as air evacuation may not be covered. To buy AMREF insurance please visit www.flydoc.org



WHAT TO PACK

For game viewing the Olare Motorogi Conservancy has abundant wildlife year round, and Kenya's position straddling the equator means there isn't a huge amount of variation in temperature throughout the year. You can expect average highs of 30°C/86°F from December to March with cooler temperatures from July to September during the height of the migration. Due to its elevation temperatures in the evening do drop to around 15°C/59°F however the wind can make it feel colder.



As the temperature can vary considerably in a single day we strongly recommend you pack a fleece or something to take the edge off the chill. The key in the bush is layering, as even with the sun shining you may find that it is a little chilly on game drives. Fortunately we have soft blankets to keep you toasty if needed.

For game drives, you should wear pale or neutral colours. In the warmer months these should be lightweight, but take a windbreaker or light jacket for evenings. For the cooler and wetter months take a jumper/sweater, scarf and a fleece or warm jacket. It's a good idea to bring a hat and sunglasses – for all seasons. On game drives we recommend wearing a pair of closed shoes just for ease of movement, flip flops are perfectly suitable for walking around the camp. You can wear whatever you like around the camp, and while formal wear isn't always practical, of course it's up to you. Make sure you don't forget your swimsuit too!

PACK FOR A PURPOSE

We are proud members of Pack for a Purpose, an initiative that allows travellers like you to make a lasting impact in the community at your travel destination. If you save just a few kilos of space in your suitcase and bring supplies for schools or medical clinics in need, you'll make a priceless impact in the lives of our local children and families.

Here at Mahali Mzuri, we are currently supporting the Enkenju - Enkoirien Primary School, located about 4kms from the Mahali Mzuri camp in NAROK county. Donations from local businesses have helped to fund essential items such as solar lights, computers and printers, while local communities and guests have provided stationery including; books, pens and pencils, beads for bead-making, maps and Dictionaries.

For a list of items that you can bring with you visit:
www.packforapurpose.org and search for 'Mahali Mzuri'



ON ARRIVAL we will provide you with your own pair of binoculars which you're welcome to use throughout the duration of your stay to make sure you don't miss out on any action!

WHERE IS EVERYTHING?



WHAT'S IN YOUR TENT

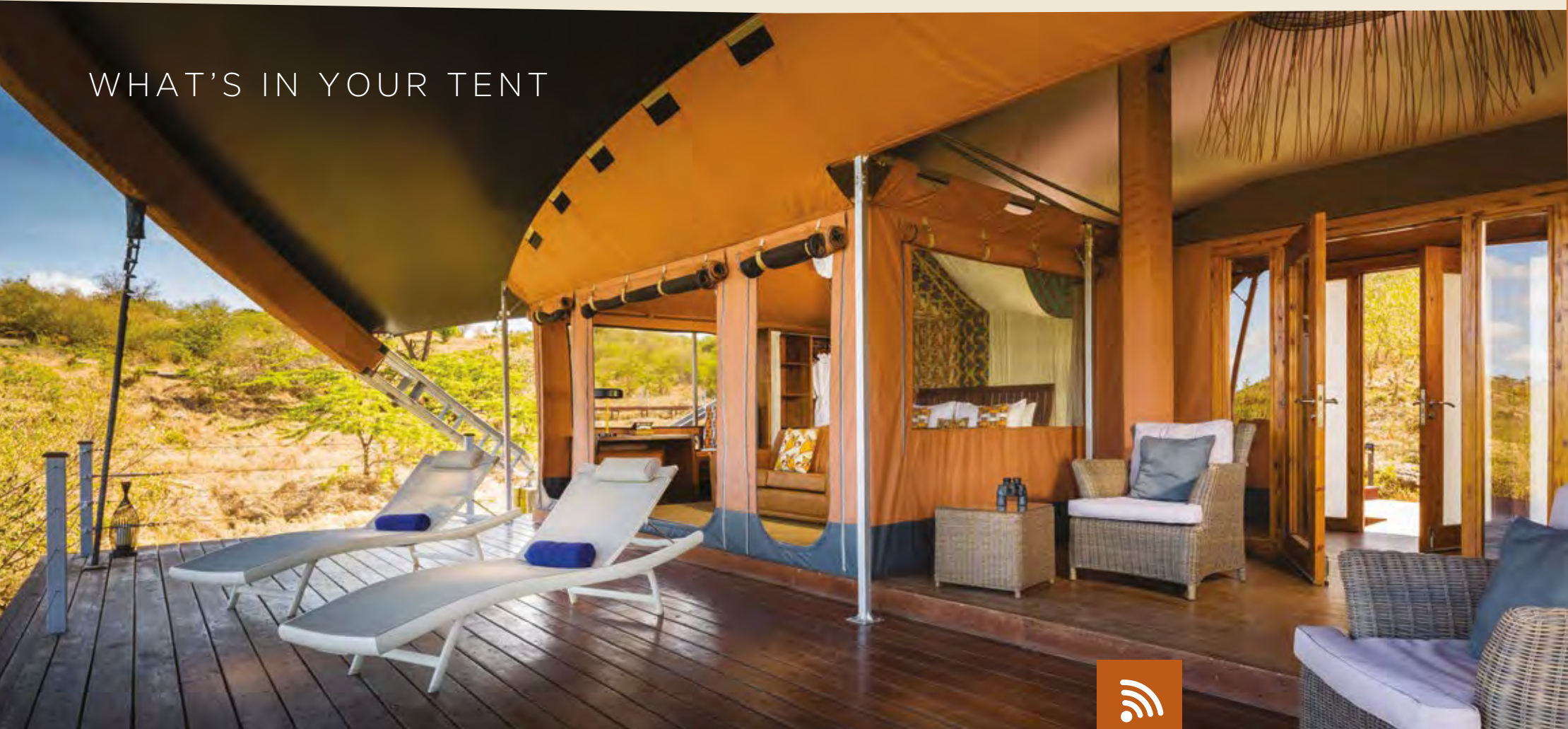

EACH TENT INCLUDES a spacious seating area, en suite bathroom and large deck to maximise those amazing views over the plains. All rooms are equipped with a hairdryer, sunscreen, insect repellent, torches, extra blankets, ponchos, bathrobes, slippers, a complimentary mini-bar, tea and coffee making facilities and hot water bottles. The bathrooms have a selection of toiletries including shower gel, shampoo and conditioner. Pocket sockets in Kenya use the British standard 3-pin arrangement so guests visiting from other parts of the world will need an adaptor which is provided in your room. Please note that the current in Kenya is 240 volts.

KEEPING IN TOUCH

(PHONES AND INTERNET)

WiFi is provided throughout the camp in all tents and in the public spaces, and mobile phone reception is reliable.

EATING & DRINKING



You certainly won't leave us hungry! From early morning snacks prior to game drives to à la carte menus in the evening, the food served at Mahali Mzuri will be one of the highlights of your stay. We can cater for special dietary needs so just let us know in advance and we'll do our best to have exactly what you need.

At breakfast a continental buffet including cereals, muesli bars, yoghurts, fresh pastries, cheese, hams and fruits will be served with hot dishes available to order. Guests typically share tables and it's a great time to chat with your fellow travellers about the wildlife you saw earlier that morning. Lunch is normally served on the main deck with individual tables and guests can order from the menu. Just prior to the afternoon's game drive afternoon tea is served at around 4pm with a selection of fruit, cakes and drinks. Later in the evening dinner could be around a large communal table, out in the bush, somewhere private just for two!

If your departure time is later on in the afternoon we'll be happy to accommodate you for lunch (additional charge applies).



CHILDREN AT MAHALI MZURI



LITTLE WARRIORS, WE'LL SEE YOU SOON

Little Warriors (that's the kids!) aged two years or older are welcome at Mahali Mzuri and can join in the fun on game drives with their parents. The smaller ones aged two to six years old can accompany their parents on game drives, but only in a private closed vehicle (*available to hire for \$350 a day with children's car seats*). When not on game drives we ask parents to keep an eye on their little warriors at all times. We're also happy to arrange special menus for the younger ones in the pack on request.



ACCOMMODATION FOR CHILDREN

We have two tents which are able to accommodate children in a separate enclosed sitting room. Children under the age of 12 are not permitted to sleep in a tent without parental supervision. Children between the ages of 12-15 are allowed to stay in their own tent, however we strongly recommend that any child under the age of 15 shares a tent with their parent. For younger children we can provide a cot and roll away bed for a nanny if required.

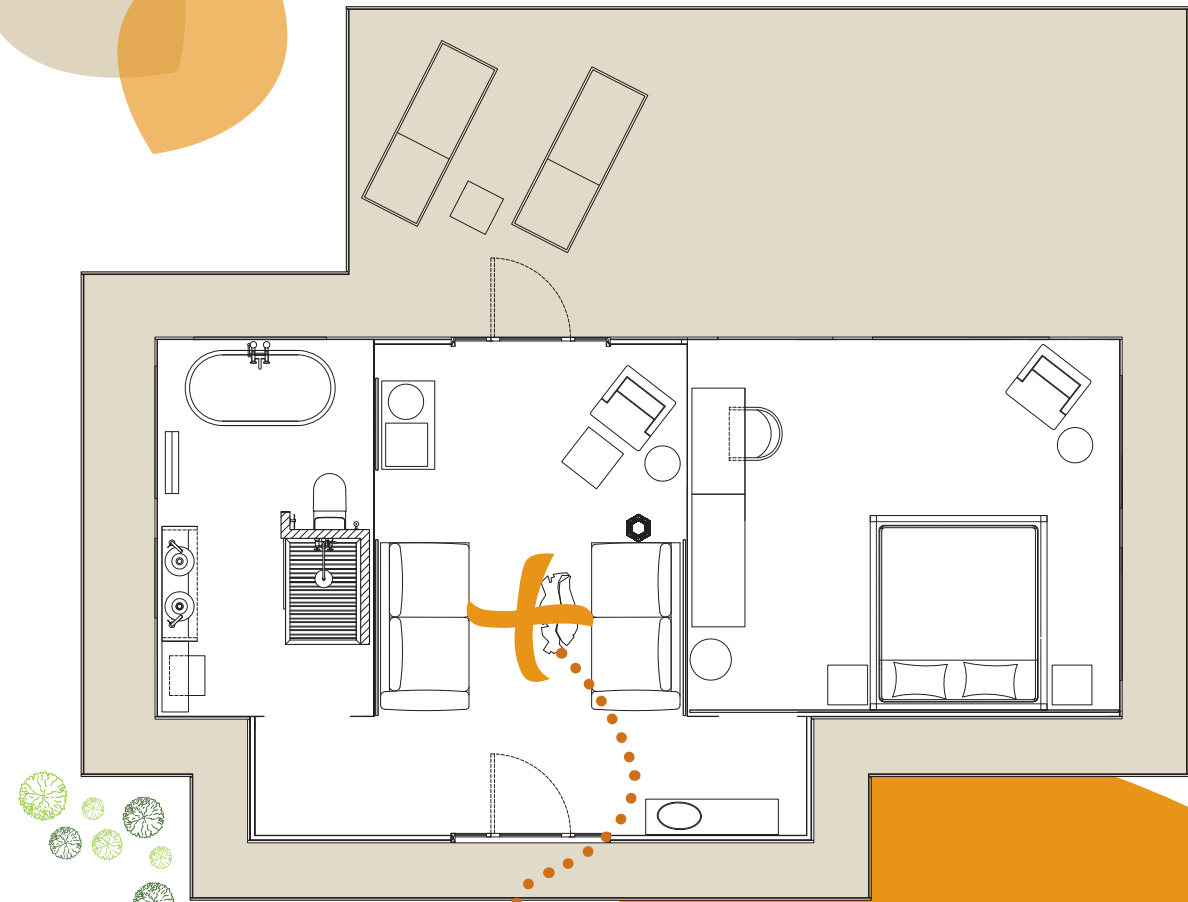

These two sofas can also be adapted into two comfortable twin beds for children to rest their heads after a busy day on safari



GAME DRIVES

The timings will vary but morning game drives tend to depart at 6am and we can arrange for a wakeup call to your tent. Your Field Guide will stop for teas and coffees during the drive and you'll be back at the camp after a few hours for breakfast. Afternoon game drives typically depart at 4.30pm and you'll stop in the bush for sundowners before returning to the camp for dinner.

Our vehicles, like everything else, will be meticulously cleaned, before and after every game drive. To ensure safe social distancing, guests on game drives will be reduced to four people per vehicle, unless travelling as one larger family or group. We also kindly ask that you follow Government guidelines and wear a face mask during game drives.

LEISURE ACTIVITIES

Spot the game from the comfort of your own tent - the views from the deck are spectacular and your binoculars are likely to get a good work out. Our infinity edged pool is a perfect respite from the midday heat and the game viewing is just as intense. In the main lounge there are board games and a TV. Make sure you bring a book or two. For the active types we can provide exercise equipment including yoga mats, skipping ropes, weights and a step board either in the tents or by the pool.



SPA TREATMENTS

While you're with us take advantage of our spa treatment room, located down on the valley floor and a short walk from the infinity pool. The spa is open from early morning to later in the evening. Our spa therapist can take you through the different treatments available (additional charges apply for treatments) and these can be booked in advance or on arrival.

COMMUNITY VISITS

MAASAI COMMUNITY TOURS

While you're staying at Mahali Mzuri you're welcome to visit one of the Maasai villages in the local area to get a flavour for daily life in the Mara and to learn about the local Maasai Tribe whose traditional pastoralist customs are still very much in practice. The village is only 10 minutes' drive from Mahali Mzuri and the best times to go are first thing in the morning when you can help milk the cattle or in the evening when the cattle, goats and sheep are being herded back to their enclosures for the night.

The local school is a further 5 minute drive from the village. This is where the Maasai children aged 3-15 years attend. You are welcome to visit the school, please let your guide know in advanced of your trip. Your Guides at Mahali Mzuri will take you on a tour and introduce you to their families while explaining some of the cultures and traditions.

To keep both you and the community safe, we kindly ask that you wear a face mask throughout the tour, use hand sanitiser before and after and follow social distancing guidelines.



LANGUAGE

The local Maasai will speak Maa and usually Swahili which is used across several countries in East Africa. That's in addition to English of course! Your in-room directory in your tent has a few phrases in Maa and Swahili which you're welcome to try out.





CONTACT

United Kingdom

0800 716 919 *(UK toll free)*
+44 (0) 208 600 0430
enquiries@virginlimitededition.com

United States

+1 877 577 8777 *(USA toll free)*
+1 929 526 3034
enquiriesusa@virginlimitededition.com

www.mahalimzuri.virgin.com

Virgin LIMITED
EDITION