

# MARA EXPEDITION CAMP

MARA NORTH CONSERVANCY | MAASAI MARA NATIONAL RESERVE



**“Mara Expedition Camp is positioned in a grove of typical East African acacia trees overlooking a valley in the Masai Mara Reserve.**

It is on private land, so very exclusive but with access to some of the region’s best wildlife. The camp tells the story of early day explorers with touches of campaign furniture and open-air space under light canvas. It is an ideal camp, from which to start your safari looking for big cats such as cheetah and lion. Most days you don’t even have to go very far!” - Dereck Joubert, CEO.

The camp is a magical revisiting of the past, drawing from Africa’s original explorers’ designs and designed for those who search for East Africa’s romantic safari era. Here, you will experience the best of both worlds: the intense action of the Maasai Mara ecosystem, as well as the more private 28,000-hectare Mara North Conservancy. Mara Expedition Camp is a stylish experience and adventure camp unique to the industry and fits the service levels, specialised guiding and design that has become associated with Great Plains Conservation.

It is safari chic with five light and airy, spacious canvas tents, plus one 2-bedroom family tent. It is set down low, hidden from lights and noise from other camps or properties or any sign of mankind. Under the grove of Africa acacia trees, its humble main area is lit by lantern and candlelit, simple in design, but just enough for all the comforts. This camp’s ambience and ‘back to the classic’ safari design will be a sure hit with private groups and safari enthusiasts alike.

The camp is locally famous for its leopard residents wandering nearby and is positioned to take the best advantage of two migrations – the famous annual Serengeti migration and the green season migration from Loita Plains, an additional 50,000 wildebeest and over 100,000 zebras vying for grazing rights. Mara Expedition Camp is a place for the ardent safari-goer. Full days, with picnic breakfast (and often lunch, too), traverse some of Africa’s richest wildlife country, renowned for extraordinary predator density and frequent hunts. Access to Mara North Conservancy give guests options of more privacy when not out exploring the Masai Mara Reserve.



# MARA EXPEDITION CAMP

MARA NORTH CONSERVANCY | MAASAI MARA NATIONAL RESERVE

## CAMP FEATURES

Mara Expedition Camp can accommodate up to 12 adult guests.

### Total Number of Bedrooms:

- 5 twin or double guest tents
- 1 two-bedroomed family tent
- 1 Guide tent with a bed and bathroom

### Type of Lodge:

Explorers Collection Safari Camp

### Lodge Season & Opening:

Year Round

### Ideal length of stay:

3 / 4 Nights

## CHECK OUT TIME

We maintain a high level of flexibility when it comes to check-out times at our camps. However, due to some scheduled air transfer schedules, there are instances where we may kindly request guests to check out of their rooms by 9:00am. In such situations, our lodges and camps are set up to ensure that guests can utilise the facilities located in the central area. This includes access to Wi-Fi, the provision of complimentary drinks and lunch in the event of any unexpected delays, and access to hides or other activities if available.



## CAMP CO-ORDINATES

1°22'03.0"S 35°11'38.0"E

## ACCESS DIRECTIONS

- Daily scheduled light aircraft transfers to the ol Kiombo Airstrip;
- Flight Time from Nairobi's domestic Wilson Airport is approximately 1 hour;
- The camp is a 45-minute drive from the airstrip;
- Co-ordinates: S1°24'31.0" E35°06'38.0";
- Airstrip length: 1200m.

## ACTIVITIES

### Wildlife viewing

Early morning, late afternoon and early evening safari drives take place in the Masai Mara Reserve and the private Mara North Conservancy. Mara Expedition Camp's two specially designed Land Cruisers are totally open-sided (a rarity in the region), offering 300-degree views, which provide ideal photography opportunities. Under our top guides' guidance, each vehicle comes fully equipped with a stocked fridge.

The Maasai Mara and surrounding conservancies are ideal for some of Africa's most spectacular wildlife and birding scenes. A limited number of high-quality binoculars are also available for guest's complimentary use during their stay.

# MARA EXPEDITION CAMP

MARA NORTH CONSERVANCY | MAASAI MARA NATIONAL RESERVE



## Hot Air Ballooning

Hot-air ballooning over the Maasai Mara is available at additional cost and is a truly stunning way to experience the landscape and an unforgettable sunrise.

## Cultural Experience

The Naboisho Women's Group cultural experience is supported by the Great Plains Foundation, enabling the group to purchase raw materials in bulk including a tailor hired to work on leather products. Available to guests staying at Great Plains Conservation camps all profits from the sale of their wares are ploughed back into the women's business training to ensure this group is self-sustainable. Items available for purchase include, but are not limited to, beaded & leather products, coasters, bracelets, necklaces, belts, dog collars, earrings, and decorated dawa sticks for example.

## Private vehicle option

Available for more flexibility upon request at extra cost, not compulsory for families travelling with children.

## Private Guides

Private guides are encouraged and welcomed.

## CENTRAL FACILITIES

- Central lounge and dining room;
- Coffee and tea station;
- Bar/drinks area;

- Unique swimming pool near the main area for guests to enjoy;
- Outdoor fire area with seating.

## FOOD AND BEVERAGE

- Three delicious meals a day are provided;
- We are incredibly flexible on timings. Picnic breakfasts or lunch (or both) are the norm due to very active safari drives;
- All drinks and beverages are included, including imported spirits and champagnes;
- Group meals or private dining in separate locations under the trees on decks;
- Private dining in guest's rooms on request;
- All dietary requirements are catered for from regular to vegan to children, prior notice required.

## ACCOMMODATION DETAILS

### Bedroom features

- Uniquely designed custom tents on slightly raised platforms;
- Large bedroom with attached bathroom;
- Either twin or double bed configuration;
- Classic in style, the shaded tents are of light tan canvas with plenty of netted windows and high ceilings;
- Tea and Coffee station;
- One 2-Bedroom Family custom-designed canvas tent on a slightly raised platform consisting of two bedrooms, each with their own separate bathroom and dressing area;

# MARA EXPEDITION CAMP

MARA NORTH CONSERVANCY | MAASAI MARA NATIONAL RESERVE

## Bathroom features

- En-suite with flush loo, double brass basins and a campaign-styled indoor shower;
- Hot water is provided;
- Soap, shampoo, conditioner and lotion provided;
- The power system does not support hairdryers, shavers or any high wattage device.

## ACCOMMODATING CHILDREN AND SHARING ACCOMMODATION

- We look forward to having children stay with us who are 6 years and older;
- The family tent can accommodate a family of 4 guests;
- No triples possible;
- Families with children may be accommodated in the same vehicle as other guests unless a private vehicle is booked and paid for;
- Young children must be supervised as the camp is open, with high predator densities in and around camp;
- Great Plains Young Explorers Kid's program is available – thoughtfully designed to explore various experiences and topics from birding to cooking to art to tracking wildlife.

## FITNESS

Yoga mats are provided in each tent.

## LAUNDRY

Included in nightly tariff - next day service, weather permitting.

## POWER AND COMMUNICATION

### Power

- The camp is run by an impressive solar farm;
- This system produces 240V, 24-hour electricity to the tents and main area;
- Plug points in each tent;
- Type of plug: large British three-pin; converters available for most international plugs;
- The power system does not allow hairdryers, shavers or any high-wattage device.

### Internet & Mobile

- Mobile reception is relatively reasonable;
- Each guest tent has access to complimentary Wi-Fi;
- No cell phones or computers are allowed in the public areas of camp or on safari vehicles, only in guest tents' privacy.

## HEALTH AND SAFETY

### Health

- Malaria: Minimal exposure risk– Malaria prophylaxis are recommended if guests are concerned; however, this is a remote area with little occurrence;
- Kenya is considered a Yellow Fever Zone. Consult your medical practitioner prior to travel;
- Guests must hold comprehensive medical insurance and emergency evacuation insurance;
- Senior staff all has first aid training;
- Nearest decent medical facility is in Nairobi.



# MARA EXPEDITION CAMP

MARA NORTH CONSERVANCY | MAASAI MARA NATIONAL RESERVE

## Possibility of Disabled Access

The camp layout is not always conducive to guests who use wheelchairs (in the wet season), but many wheelchair-bound guests feel quite comfortable in this camp.

## Safety

- Safety: The camp is unfenced to wild animals that do move through the property especially at night. Security guards are armed with traditional spears;
- Fire extinguishers in each tent.

## MONEY MATTERS

### Safes

Safes are provided in every room.

### Accepted Payment on Location

- All-inclusive. Staff gratuities can be paid in Kenyan Shillings, US Dollars or GB Pounds;
- There are no credit card facilities available.

### The Team

Lodge Owners

**Great Plains Conservation**

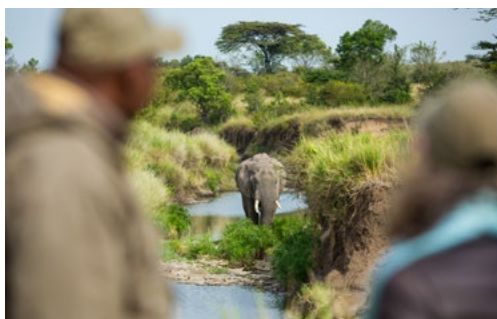

## FOUNDATION INITIATIVE

### Conservation Roots

Great Plains is on a mission to restore ecosystems, improve food security and support climate change mitigation and adaptation through tree planting. Through Conservation Roots, Great Plains is partnering with local communities to plant indigenous trees and, where appropriate, non-native, non-invasive, fruit trees in Kenya, Botswana, and Zimbabwe. Working with local communities, partner organizations and school systems, Conservation Roots plants and distributes trees and teaches their value and critical role in functioning ecosystems. Learn more at

[www.greatplainsfoundation.com/conservation-roots/](http://www.greatplainsfoundation.com/conservation-roots/)

In addition to our own programs Great Plains Foundation keeps a list of school needs in the countries where we work. Needed items can be hand-carried by travelers or we can help purchase them locally. To learn more or to help support students and educators as part of your trip please reach out [info@greatplainsfoundation.com](mailto:info@greatplainsfoundation.com)

# GUEST TENT

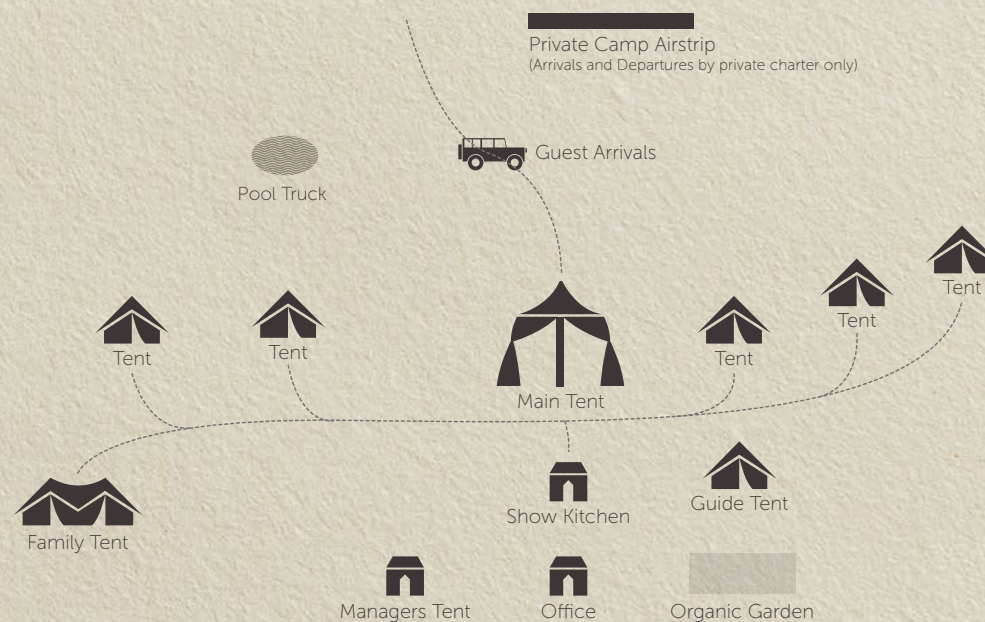
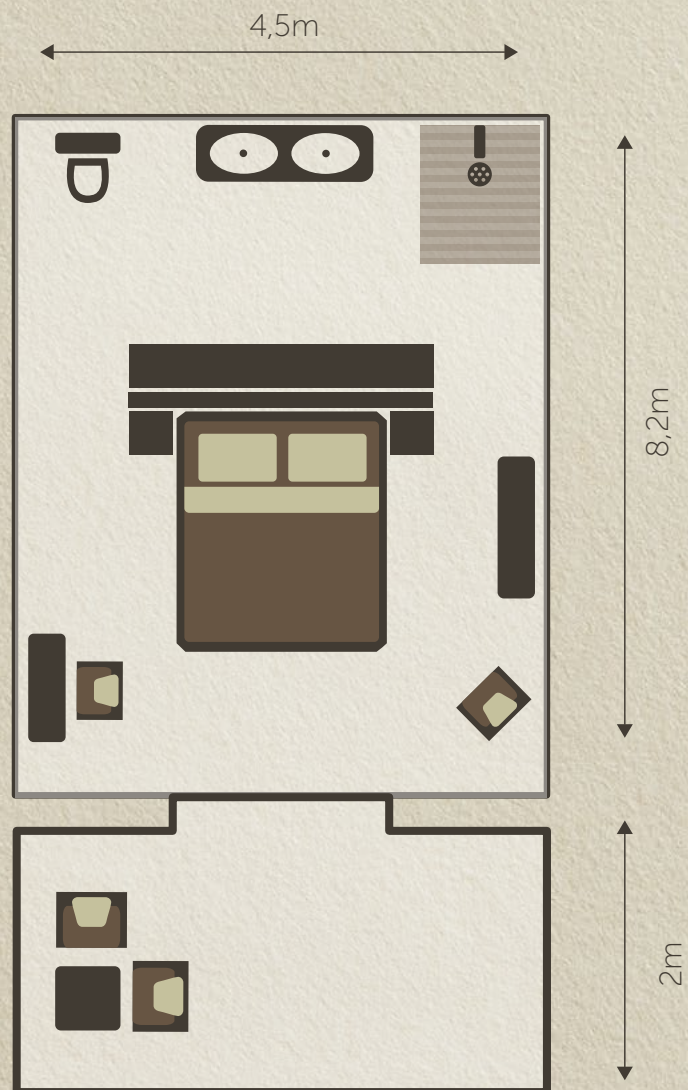

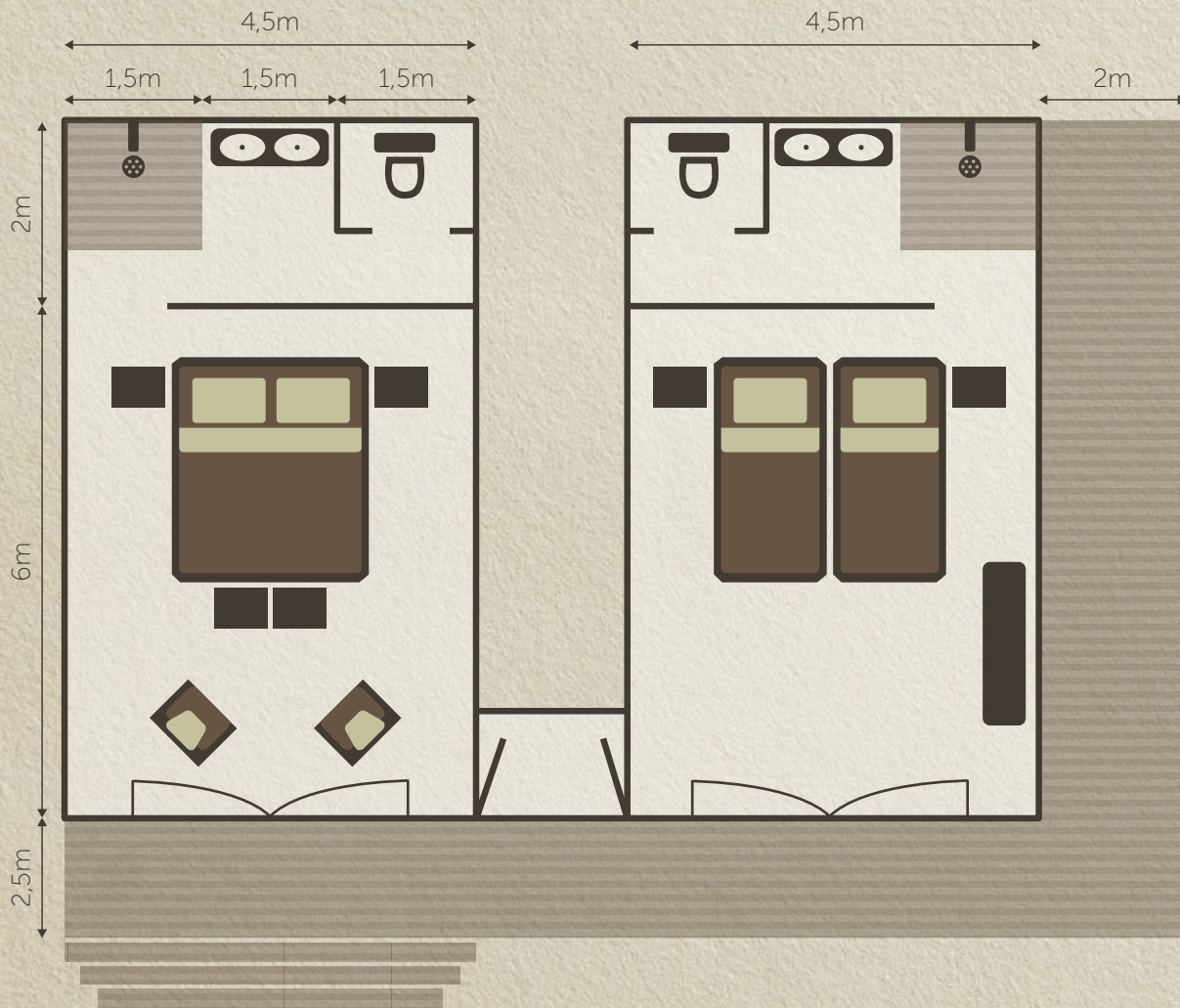

## FAMILY TENT

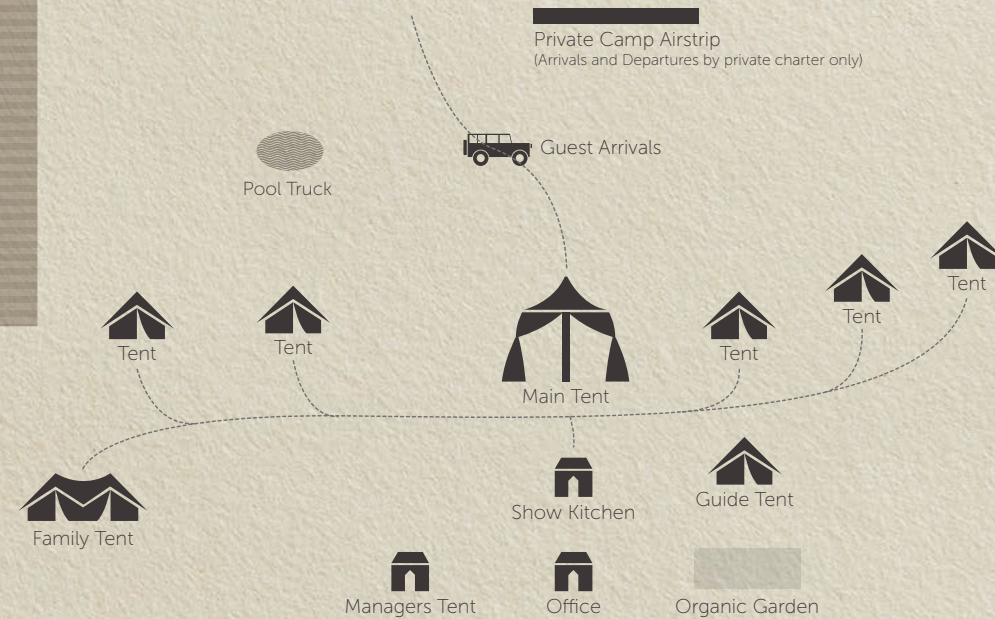

# GREAT PLAINS

CONSERVING AND EXPANDING NATURAL HABITATS



GREAT PLAINS CONSERVATION  
STRIVES TO FIND THE RIGHT FORMULA OF  
CONSERVATION, COMMUNITIES AND COMMERCE  
THAT MAKES A LASTING, SUSTAINABLE DIFFERENCE  
TO THE WORLD'S ICONIC WILDLIFE HABITATS



# GREAT PLAINS CONSERVATION

## QUICK CAMP FACTS



## KENYA CAMPS

ACTIVITY	OL DONYO LODGE	MARA PLAINS CAMP & THE JAHAZI SUITE AT MARA PLAINS	MARA NYIKA CAMP & THE SAMBUK SUITE AT MARA NYIKA	MARA TOTO TREE CAMP OPENING JULY 1, 2024
Camp Classification	Réserve-Collection	Réserve-Collection	Réserve-Collection	Réserve-Collection
Location	Mbirikani Group Ranch	Olare Motorogi Conservancy	Naboisho Conservancy	Maasai Mara National Reserve
Size of concession / reserve	110 000 Hectares / 275 000 Acres	13 300 Hectares / 33 000 Acres	20 000 Hectares / 50 000 Acres	28 000 Hectares / 69 000 Acres
Traversing	Mbirikani Group Ranch	Olare Motorogi Conservancy & Maasai Mara National Reserve	Naboisho Conservancy & Maasai Mara National Reserve	Mara North Conservancy & Maasai Mara National Reserve
Number of Suites / Tents	8 Suites	5 Suites	3 Suites	4 Suites
Family Accommodation	One 2-bedroom suite	The 2-bedroom Jahazi Suite at Mara Plains	The 2-bedroom Sambuk Suite at Mara Nyika. One two-bedroom suite	n/a
Children can be accommodated from:	5 Years	6 Years	6 Years	6 Years
Day Drives	Yes	Yes	Yes	Yes
Night Drives	Yes	Yes	Yes	Yes (water level dependent)
Cultural Experience	Yes	Yes	Yes	Yes
Private Vehicle (at an additional charge)	Yes	Yes	Yes	Yes
Guided Walks	Yes	No	No	No
Horseback Riding	Yes	n/a	n/a	n/a
Hot-Air Ballooning (at an additional charge)	n/a	Yes	Yes	Yes
Mountain Biking	Yes	n/a	n/a	n/a
Hide	Yes	n/a	n/a	n/a
Main Swimming Pool / Private Plunge Pools	Yes (Main Pool & Private Plunge Pools)	Yes (Jahazi Suite only)	n/a	n/a
Shower	Indoor & Outdoor	Indoor	Indoor	Indoor
Bath	Yes	Yes	Yes	Yes
Hairdryers (low voltage)	Yes	Yes	Yes	Yes
Mosquito Nets	Yes	Yes (On all tent sides)	Yes (On all tent sides)	Yes (On all tent sides)
Fans	Standing fan	Overhead fan	Standing fan	Standing fan
Wi-Fi – in-room (complimentary)	Yes	Yes	Yes	Yes
Safe - In-room	Yes	Yes	Yes	Yes
Spa treatments (at an additional charge)	Yes (In-room only)	Yes	Yes (In-room only)	Yes (In-room only)
Fitness	In-room Equipment	In-room Equipment	In-room Equipment	In-room equipment
Boutique on site	Yes	Yes	Yes	Yes

# GREAT PLAINS CONSERVATION

## QUICK CAMP FACTS

### KENYA CAMPS

ACTIVITY	MARA EXPEDITION CAMP
Camp Classification	Explorers Collection
Location	Maasai Mara National Reserve
Size of concession / reserve	28 000 Hectares / 69 000 Acres
Traversing	Mara North Conservancy & Maasai Mara National Reserve
Number of Suites / Tents	5 Tents
Family Accommodation	One 2-bedroom family tent
Children can be accommodated from:	6 Years
Day Drives	Yes
Night Drives	Yes (water level dependent)
Cultural Experience	Yes
Private Vehicle (at an additional charge)	Yes
Guided Walks	No
Horseback Riding	n/a
Hot-Air Ballooning (at an additional charge)	Yes
Mountain Biking	n/a
Hide	n/a
Main Swimming Pool / Private Plunge Pools	Main swimming pool
Shower	Indoor
Bath	n/a
Hairdryers (low voltage)	n/a
Mosquito Nets	Yes (On all tent sides)
Fans	Standing fan
Wi-Fi – in-room (complimentary)	Yes
Safe - In-room	Yes
Spa treatments (at an additional charge)	n/a
Fitness	Yoga mats
Boutique on site	n/a