



ANGAMA

AMBOSELI

Fact Sheet

'An oasis within the Amboseli ecosystem, the safari experience here will complement the wide open plains of the Maasai Mara perfectly, and be a gentle addition to any itinerary to East Africa. We are excited to bring the Angama brand of hospitality to this corner of Kenya, and to partner with Big Life Foundation and the local community landowners to sustain this fragile conservation area.'

– Steve Mitchell, Co-Founder



ANGAMA.COM

ALL YOU NEED TO KNOW:

- Angama Amboseli is in the 5,700-acre Kimana Sanctuary, the jewel of the greater Amboseli ecosystem renowned for its lush landscape and remarkable diversity of wildlife, set against the famed backdrop of Mount Kilimanjaro (Kili)
- With just 10 Guest Suites, it's an intimate lodge with all of Angama's signatures: incredible views, contemporary African design, intuitive guiding and warm Kenyan service
- Another Angama signature: floor-to-ceiling screened doors of the Suites make the most of the views of Kili. In fact, Kili, the tallest free-standing mountain in the world, is always in the picture, seen from anywhere and everywhere in camp and on game drives
- In the Guest Area, enjoy indoor-outdoor dining and of course, a baraza with a fire pit for telling stories while sipping cocktails or roasting marshmallows. There's also the Studios with a Safari Shop, Games Room, Photographic Studio, Art Gallery and a Weaving Studio
- Angama Amboseli has its own Photographic Studio with photographers on hand to assist with equipment hire, tutorials, editing sessions, printing and photoshoots
- One of our favourite spots is the Swimming Pool, with a drinking trough created specifically for our special guests: the elephants that also like to spend time in this area of camp. These are the stars of the Angama Amboseli show, both the hefty herds and the Super Tuskers – enormous bulls sporting tusks weighing 100lbs each
- Kimana means 'stay a while' and this place is perfect for that: explore the Sanctuary, visit Amboseli National Park, take a pyjama safari (the best views of Kili are first thing in the morning when she peeks out from behind the clouds). Or just pull up a rocking chair and take in the view
- Angama Amboseli has exclusive traversing access to the Sanctuary, which is the heart of a vital migratory path for wildlife that connects Amboseli National Park to two other protected areas, the Chyulu Hills and Tsavo West National Park. With unrestricted access to the Sanctuary, guests can depart early in the morning and return after dark (night drives are encouraged)
- Amboseli National Park is a 45-minute drive from camp. Our guests can enjoy Amboseli on a half- or full-day excursion with a picnic lunch. Part of this journey visits the 'pinch point' – the narrowest part of a centuries-old migratory path connecting the entire Greater Amboseli ecosystem. This complex ecosystem is shared between humans and wildlife, agriculture and elephants, and highlights the realities of conservation in the 21st century

HOW TO GET HERE:

Access is easy: it's a 3h30min drive on a paved road straight from Nairobi to the gate. There are also scheduled flights with Safarilink landing at Kimana Airfield in the Sanctuary, as well as Amboseli National Park and the Chyulu Hills, both about 1h30min drive away. Private charters are always welcome at the Sanctuary's airfield.

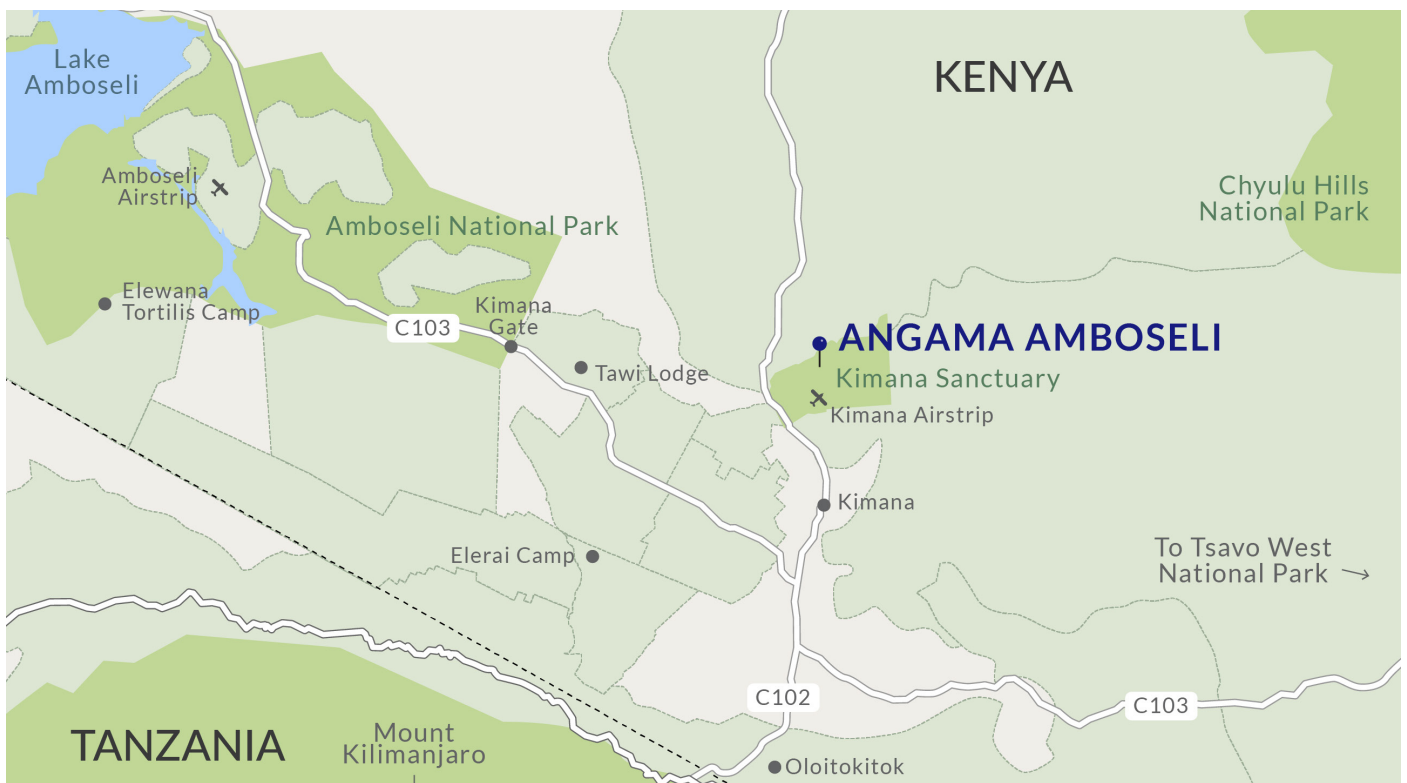

LODGE INFORMATION

Number of Guest Suites:	10 Suites
Maximum Number of Guests:	20 guests
Interconnected Family Suites:	2 sets of 2 interconnected Guest Suites
Children:	Children of all ages are welcome year round There are 3 triples available for children aged 12 and under
Childminding:	Yes – female staff
Security:	24-hour Aside from an elephant trip wire, the lodge is unfenced and guests are not permitted to walk unattended around camp after sunset
Check In:	12h00
Check Out:	10h00 Changeroom available for guests with early arrivals and late departures Early check-in and late check-out subject to availability
Swimming Pool:	Yes
Electricity:	220 / 240 V AC
Kosher Facilities:	No
Plug Points:	Yes – multiple international, 240v
Mobile Network:	Yes – several service providers
WiFi:	Yes – widespread complimentary coverage
Private Dining:	Yes
Outdoor Dining:	Yes
Credit Cards:	Yes – Visa, Mastercard and American Express

LODGE INFORMATION

In-Suite Massage:	Yes
Fitness Room:	No
Games Room:	Yes – equipped with TV, small library, DVDs and games
Safari Shop:	Yes
Photographic Equipment:	Yes – available for hire from the Photographic Studio

ACTIVITIES

Private Vehicle:	Yes – available on request at an additional cost
Morning Safaris:	Yes
Afternoon Safaris:	Yes
All-day Safaris:	Yes
Night Safaris:	Yes
Walking Safaris:	Yes – in Kimana Sanctuary

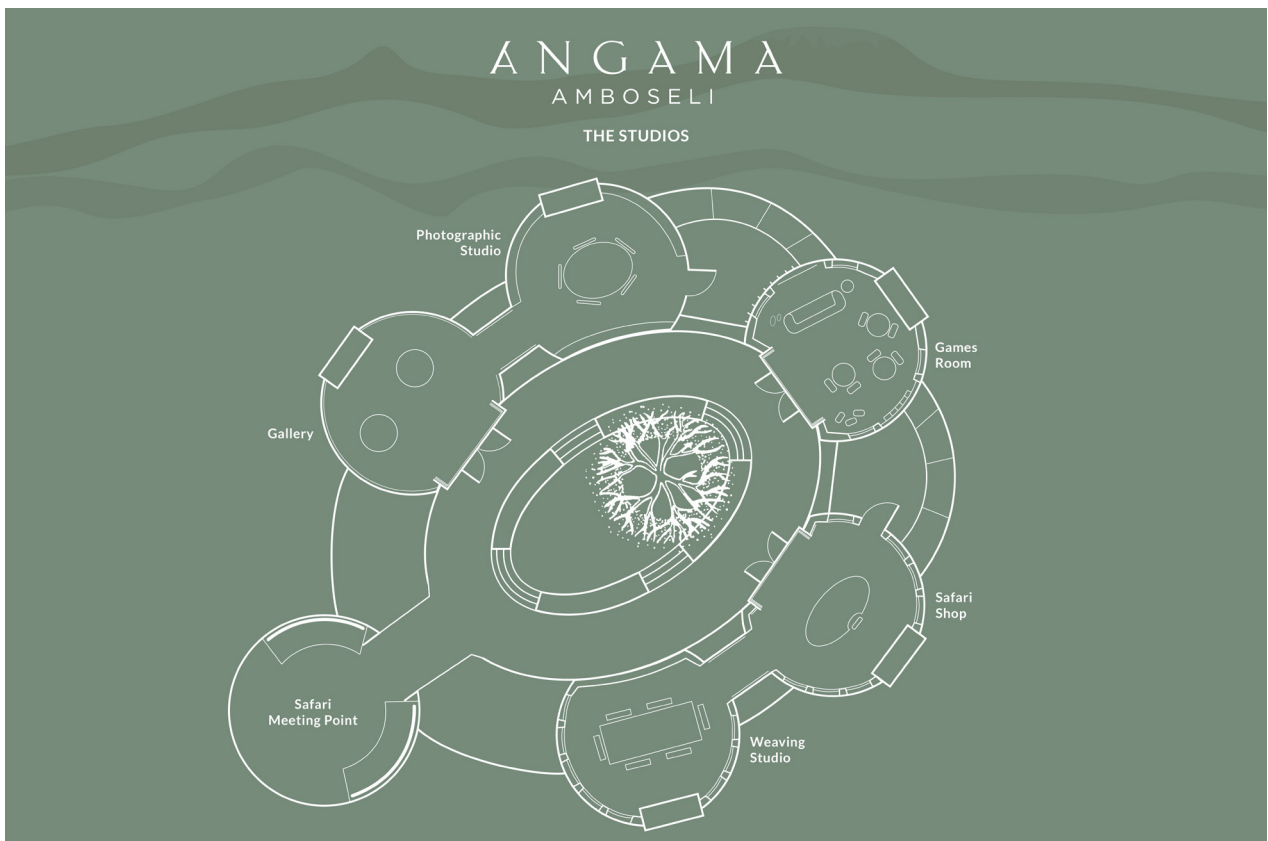

GUEST SUITE INFORMATION

Bed Size:	Super king, extra length All Guest Suites can be configured with European twin bed set-up
Fans:	Yes
Air conditioning:	No
Mosquito Nets:	No
Bath:	No – a tub is available for families with young children
Shower:	Yes – both indoor and outdoor
Twin Vanities:	Yes
Separate W/C:	Yes
Personal Bar:	Yes – complimentary
Safe:	Yes
In-Suite Communication Device:	Yes
Emergency Siren:	Yes
Hairdryer:	Yes
Disabled Access:	Yes – one Guest Suite fully wheelchair-enabled
Laundry:	Yes – complimentary
Binoculars:	Yes
Butler's Lobby:	Yes
In-Suite Tea and Coffee:	Yes
Size of Guest Suite Interior:	65 sqm (700 sqft)
Size of Guest Suite Exterior:	34 sqm (366 sqft)

ANGAMA

AMBOSELI

GUEST SUITE

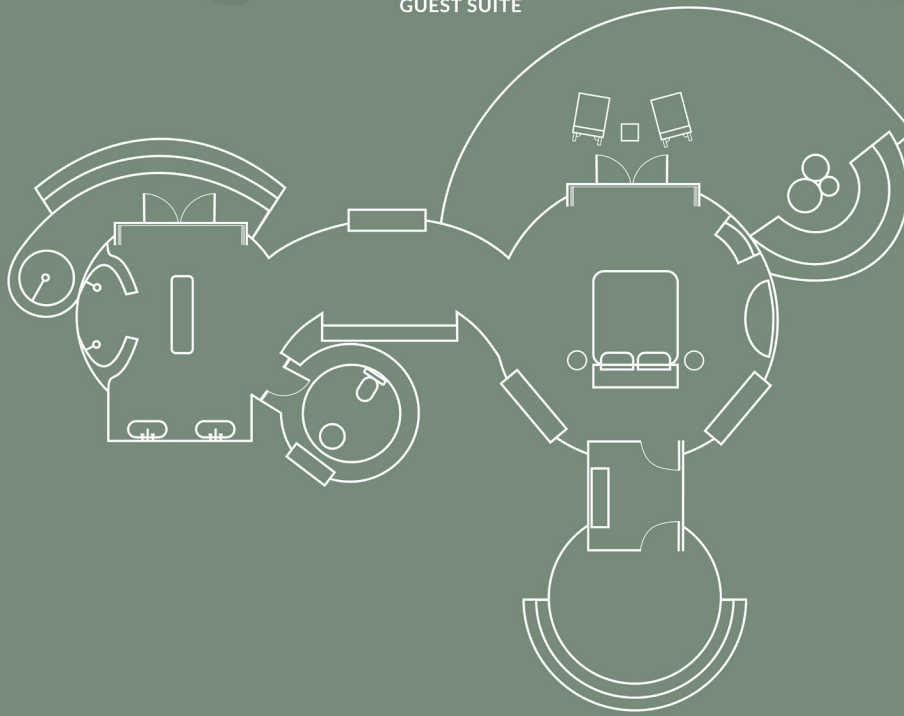

ANGAMA

AMBOSELI

INTERCONNECTED SUITES

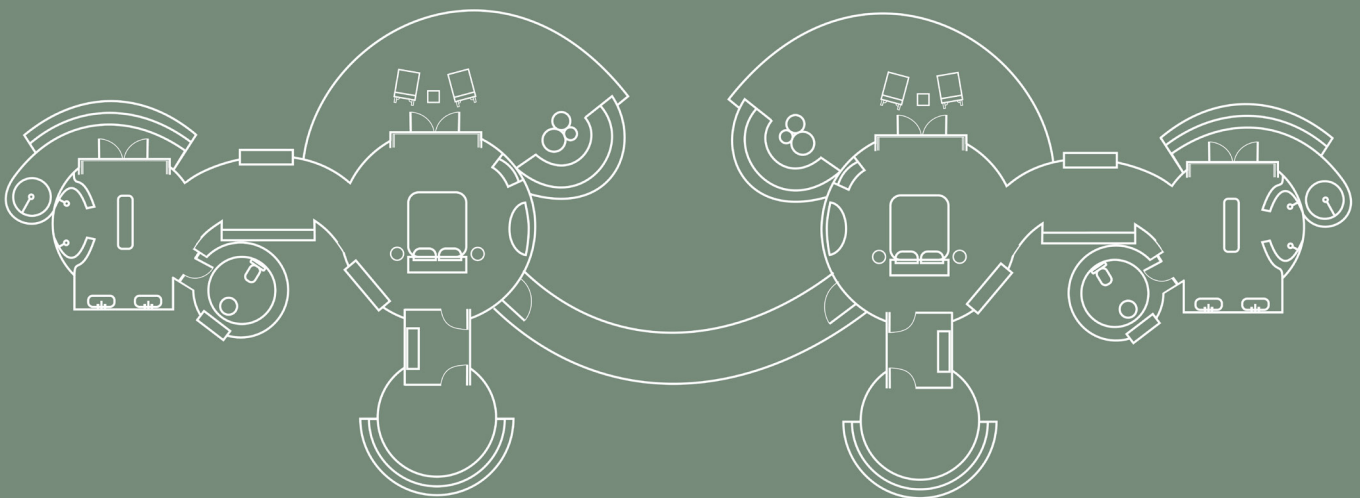

TRAVEL INFORMATION

Climate:	Warm and dry all year round
Altitude:	1,100m (3,608ft) above sea level
Rainfall:	Long rains: March – May Short rains: October – November Please note: rain generally occurs in brief afternoon thunder showers
Temperature:	Summer temperatures: min 17°C/62°F and max 30°C/86°F Summer: October – April Winter temperatures: min 14°C/57°F and max 24°C/75°F Winter: May - September
GPS Coordinates:	2°44' 30" S, 37° 32' 5" E
Malaria Protection:	Amboseli is classified as a malaria area particularly during the rainy seasons (March-May; October-November), seek medical advice prior to travel
Yellow Fever:	Many countries require travellers to have a Yellow Fever certificate prior to returning from a visit to Kenya
Currency:	USD, GBP, EUR & Kenyan Shillings
Travel Requirements:	All foreign visitors, including infants and children, who travel to Kenya are required to have an approved Electronic Travel Authorization (eTA) before the start of their journey. The processing fee of USD \$30 is applicable for many nationalities, including the US and UK, payable online at the time of application through the online portal. Please make sure your passport is valid for a minimum of six months after arrival in Kenya, with a minimum of three consecutive blank pages

CONTACT

Reservations	enquiry@angama.com
Travel Partners	rates@angama.com

