

# SIMBAVATI

LODGE COLLECTION

*Safari*

FACT SHEET



## SIMBAVATI HOMESTEAD

KLASERIE GAME RESERVE  
GREATER KRUGER NATIONAL PARK  
SOUTH AFRICA

Comfortable,  
contemporary and  
expansive interiors  
invite you to

*totally relax*

The spacious Simbavati Homestead is our self-catered lodge, which combines the intimacy and warmth of a holiday home with the game experience of a traditional safari lodge.

## Contact

### Reservations

+27 (0)87 151 4520 | [res@simbavati.com](mailto:res@simbavati.com)

### Simbavati Homestead

All messages for Homestead can be relayed to Camp George on +27 (0)15 004 1400

[simbavati.com](http://simbavati.com)

*Africalon*  
IS OUR PROMISE

# At a Glance



## Number of Rooms

- Self-catering Villa with 5 rooms



## Room Types

- Suites



## Children Policy

- We welcome children of all ages, but regrettably do not offer a babysitting service



## Ideal For...

- Families
- Groups of friends

## UNIQUE SELLING POINTS

# Why We *love it*



**Homely:**  
Modern African farmhouse, with a casual, contemporary style



**Family:**  
The home-in-the-bush ambience in a fenced environment make this perfect for family or friends



**Self-Catering:**  
Booked as a self-catered unit, this is your own personal safari, with private guide and vehicle (we are able to assist in stocking food and beverages at an additional cost)

**Relaxing:**  
Great connection with the bush with expansive verandas and terraces for daytime relaxation

## WHY VISIT?

# Klaserie



The Klaserie Game Reserve was established in 1972 as part of the greater Kruger National Park. It is one of the largest private reserves in South Africa, being 60,000 hectares (or 148,000 acres). This vast tract of preserved land has some beautiful trees and riverine vegetation near the magnificent Klaserie River. It has an open fenceless border to the Kruger National Park in the north, and the Timbavati to the south-east.

The Klaserie also protects sustainable populations of many endangered species such as wild dog, saddle-billed storks and southern ground hornbills. This is a raw wilderness experience. With limited lodges and vehicles, this is the original non-commercialised safari experience.



# Lodge Facilities

- Two lounge areas
- Outdoor dining area
- Outdoor entertainment area with extensive deck
- Swimming pool
- Thriving waterhole for game viewing
- Open air bar
- Complimentary Wi-Fi
- TV in the lounge, with DSTV channels
- Fully equipped kitchen

## Room *Types*

1 X 5 BEDROOM  
VILLA

- King beds (convertible to twin) • 2 x En suite bathrooms with bath and shower
- 1 x Shared bathroom with bath, shower and separate toilet • Private balcony in certain rooms • Views over waterhole



*Africalm*  
IS OUR PROMISE



VILLA

# In-Room Facilities & *Amenities*

- Air-conditioning
- Eco-friendly amenities
- Daily housekeeping
- Room equipped with electronic eco-friendly insect spray (subtly sprayed at 10 minute intervals)



# Daily *Programme*

*Each day is designed around the guest's preference, and may include:*

- Morning game drive
- Time to relax, cool down in the pool or soak up the sun next to the pool on a sun lounger overlooking the waterhole
- Afternoon/evening game drive
- Meals are enjoyed at guest's leisure
- Spa can be booked at Simbavati Camp George (subject to availability)



*Africalm*  
IS OUR PROMISE

# Lodge Layout

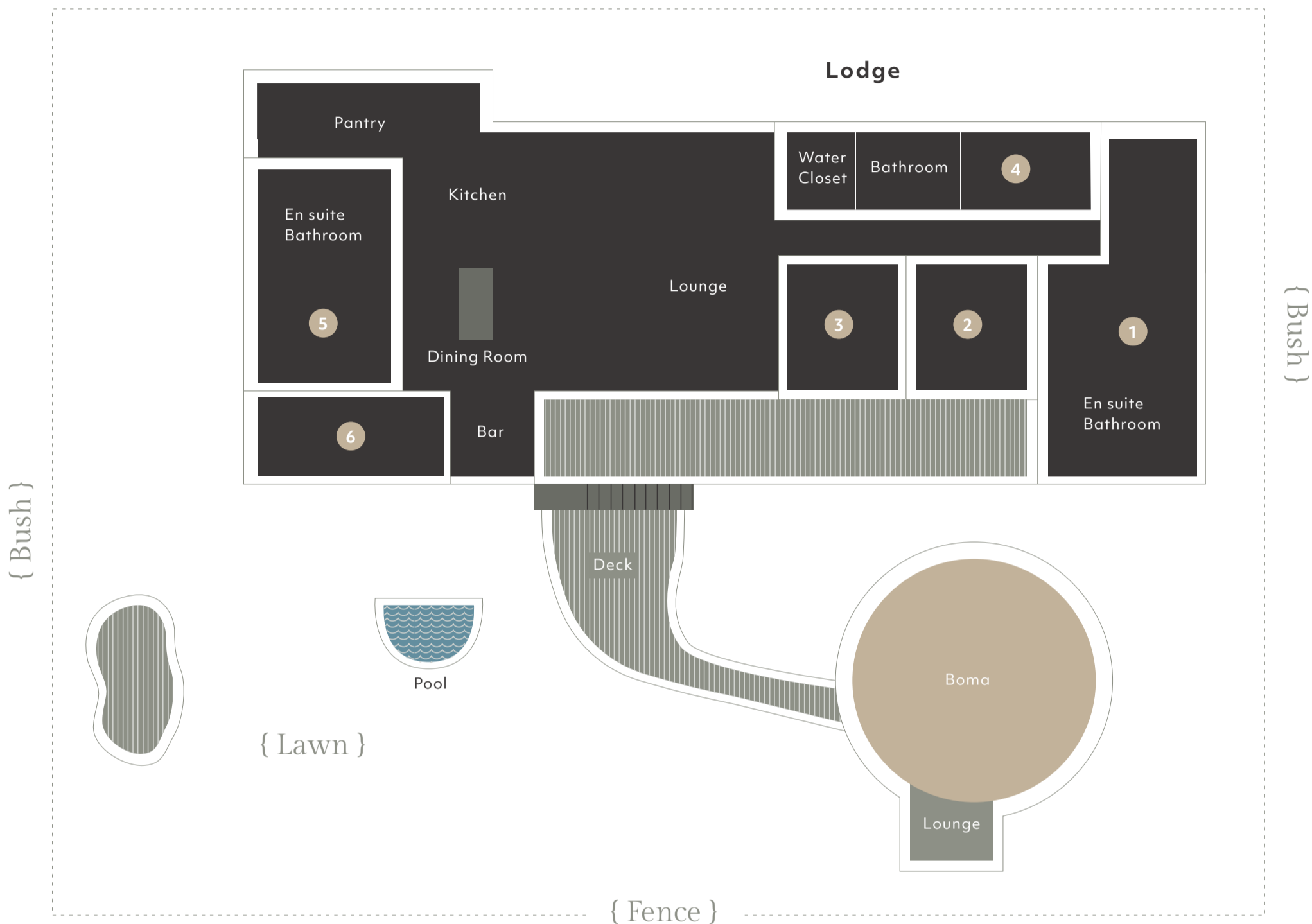

## Activities

- Game drives (late afternoon into the evening and early morning)
- Star-gazing (to be booked with guide)
- Boma or campfire self-catered dining

## GETTING THERE

# Travel Options

Simbavati Homestead is ±60 to 90 minutes from Hoedspruit Eastgate Airport, and can be accessed by car on gravel roads.

±6½ to 7 hours' drive from Johannesburg N1 via Polokwane (recommended route) or via Dullstroom, and 2 to 3 hours from Kruger Mpumalanga International Airport or Hazyview.



KLASERIE

# Location

