

# TEMBO PLAINS CAMP

SAPI PRIVATE RESERVE | GREATER MANA POOLS UNESCO WORLD HERITAGE SITE

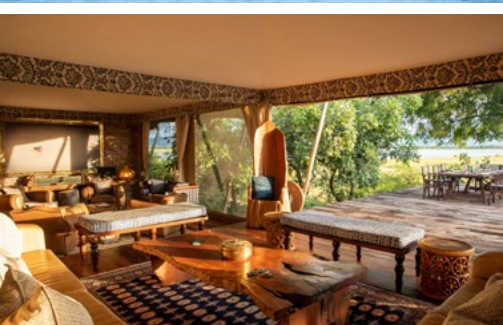

**“Tembo” meaning Elephant and reflects more than just a place and a name honouring the animals on these plains. It speaks to long and unique relationships we have with elephants. We draw on their pace and their essence for the atmosphere in camp.**

The camp is built into the thick riverine forest located on the Zambezi River’s edge, in the private 128,000 hectares (316,000 acres) Sapi Private Reserve east of Zimbabwe’s Mana Pools National Park. Tembo Plains Camp fits into our highest level brand, the Réserve Collection of camps alongside our other camps like Zarafa Camp, Selinda Camp, Duba Plains in Botswana; Mara Nyika, Mara Plains and ol Donyo Lodge in Kenya. It is also a proud member of Relais & Châteaux – the only camp in the whole of Zimbabwe given this honour.

Tembo Plains has four suites plus a beautiful 2-bedroomed Zanji Suite at Tembo Plains Camp, ideal for two couples, a family or a couple looking for the ultimate private safari. “When I designed Tembo Plains Camp it was with a view to reference the famous Zimbabwe Ruins but not lose sight of our love of canvas and exploring. So, we ended up with a unique combination of canvas and stone walls. The semi-circular walls inside each tent isolate the bath and shower from the bedroom, and indoor lounge areas bringing that architectural reference inside as well. Outside this pack-stone wall design continues along the back of the guest bedroom, and that really gives you a greater sense of privacy, often an issue in tents. Still, I didn’t want a completely ‘built room’, so the front has these uninterrupted views of Zambezi river flowing just meters away from the canvas ‘tented’ suite.” - Dereck Joubert, Great Plains CEO

Painted dogs (wild dogs), lions and leopards are seen around Tembo Plains Camp whilst buffalo, and of course, elephants, are often seen up and down the river, sometimes swimming the river itself.

The Sapi Private Reserve, established by Great Plains Conservation as part of our mission to convert vast tracts of Africa into pure conservation land, is now a beautiful private photographic reserve that borders the Mana Pools National Park. It is recognised as one of the finest wildlife destinations in Africa today. This fantastic wildlife sanctuary and the Mana Pools National Park that we can access if we want to, offer a combined range of over 337,000 hectares of prime, protected wilderness for our guests. It is a part of the UNESCO World Heritage Site and a core area of the middle-Zambezi biosphere reserve.

# TEMBO PLAINS CAMP

SAPI PRIVATE RESERVE | GREATER MANA POOLS UNESCO WORLD HERITAGE SITE

## CAMP FEATURES:

Tembo Plains Camp can accommodate a maximum of 12 adult guests.

## Total Number of Bedrooms:

4 double or twin configuration suites,  
1 x 2-bedroom The Zanzi Suite at Tembo Plains,  
1 guide tent with 2 three-quarter beds and a shared en-suite bathroom.

## Type of Lodge:

Réserve Collection Safari Camp

## Lodge Season & Opening:

April to November

## CAMP CO-ORDINATES

15°39'17.6"S 29°41'05.3"E

## ACCESS DIRECTIONS

- Light aircraft transfers from Harare International Airport (1 hour 35 mins);
- Victoria Falls International Airport (3 hours 50 mins);
- Private Air charters are available;
- Transfer time from a Sapi Private Reserve airstrip to camp is approximately 45 mins with wildlife viewing opportunities en-route;
- Please note that to fly from Sapi to Victoria Falls or Harare and then connect to some same-day international departure flights, guests may be required to book a private charter. We can confirm this at the time of enquiry.



## ACTIVITIES

### Wildlife viewing

The focus of your stay is centred around exploration and adventure. Many activities involve day and night wildlife viewing drives and walking with some canoeing and excellent boating opportunities on the Zambezi River. Your wildlife viewing vehicle is available to conduct safari drives for those who prefer to cover greater land distances and who do not wish to venture out into the wilds on foot.

We use custom-built, open Toyota Land Cruisers specially designed for our conditions and photography, including fold-down windscreens, raised roofs, photographic bars, and multi-plug inverters. Each of the Land Cruisers is fully stocked with reference books, drinks, and snacks.

Guests have the opportunity to experience up-close encounters with elephants, lions, leopards, hyenas, wild dogs, buffalo, eland, zebra, and other ungulate species. This is a prime bird-watching country, and opportunities abound for guests to spot resident and migrant species, especially in the early morning and late afternoons.

### Photography

Each suite comes complete with a professional camera and lenses, plus high-quality binoculars for guests to use whilst they are with us in Sapi.



# TEMBO PLAINS CAMP

SAPI PRIVATE RESERVE | GREATER MANA POOLS UNESCO WORLD HERITAGE SITE



## Fishing

Enjoy the thrill of heading out on the Zambezi River with your guide to try your hand at catch and release fishing.

## Private vehicle option

Available at an extra charge.

## Private Guides

Private guides are encouraged and welcomed.

## CENTRAL FACILITIES

- Tented safari main area which includes lounge, dining, interactive kitchen, library and wine cellar;
- Coffee/tea station;
- Fire pit with seating;
- Great Plains Safari Boutique selling locally and regionally produced crafts, many of which support local community. The Boutique also stocks the d&b clothing line: Dereck and Beverly Joubert have inspired this bespoke range of clothing they typically wear, and which is perfect and cool while on safari yet elegant when in the city. All materials are responsibly sourced.

Visit [www.greatplainsconservation.com/safariboutique](http://www.greatplainsconservation.com/safariboutique)

## FOOD AND BEVERAGE

- All drinks and beverages are included, including imported spirits and sparkling wines;
- Three delicious meals a day are provided;
- We are incredibly flexible on timings;

- Picnic breakfasts or lunch (or both) are the norms due to wildlife viewing activities;
- Group or individual dining;
- Outdoor and/or under canvas dining locations;
- All dietary requirements are catered for from regular to vegan to children, prior notice required.

## ACCOMMODATION DETAILS

### BEDROOM FEATURES

- Four large canvas suites with outdoor sitting area;
- One large 2-bedroomed family suite with common outdoor sitting area; Each bedroom features its own en-suite bathroom;
- Canvas is light sand coloured, with netted windows;
- Private plunge pool and wrap around decking;
- Bar fridge with drinks of choice;
- Tea/Coffee station;
- Each bed has a mosquito net and suites have netted windows;
- Solar powered Air Conditioning (heating and cooling) facility located over the guest's bed in each suite;
- Standing Fans;
- Charging facilities in each suite;
- Suites are ideally appointed for Honeymooners;
- Either twin or double bed configuration.



# TEMBO PLAINS CAMP

SAPI PRIVATE RESERVE | GREATER MANA POOLS UNESCO WORLD HERITAGE SITE



## Bathroom features

- Each suite has an en-suite bathroom with a bath, an inside and outdoor shower, flush loo, and a basin.
- Soap, shampoo, conditioner, lotion, low voltage hairdryers provided.

## ACCOMMODATING CHILDREN AND SHARING ACCOMMODATION

- Recommend for children older than 6 years;
- The Tembo Plains Suite is a dedicated 2-bedroom family suite and can accommodate a maximum of four adults sharing or two adults and up to three children sharing, in two separate en-suite bedrooms;
- Children 16 and older will pay applicable adult rates and be accommodated in a separate suite;
- Triples are possible: Child rates are applicable for one child aged 15 and younger sharing with two adults in a suite;
- Families will be combined with other guests on all activities unless a private vehicle has been booked and paid for;
- Children of 6 years and older are welcome to participate in all scheduled camp activities;
- Young children must be supervised as the camp is open with high predator densities in and around camp and there is water surrounding camp; Pools are not covered;
- Great Plains Young Explorers program – thoughtfully designed to explore a range of experiences and topics from birding to cooking to art to tracking wildlife.

## SPA

A quiet, serene area for one to come and relax whilst your therapist pampers you with a range of treatments with products inspired and personally chosen by Dereck and Beverly Joubert. Spa treatments are excluded from the nightly rate.

## FITNESS

Each suite has an exercise bike on a wide veranda as well as small weights and yoga mats.

## LAUNDRY

- Included in nightly tariff - next day service, weather permitting;
- Due to cultural sensitivities, our staff would prefer not to wash guests' underwear. Washing powder is provided if you would like to wash your own.



# TEMBO PLAINS CAMP

SAPI PRIVATE RESERVE | GREATER MANA POOLS UNESCO WORLD HERITAGE SITE

## POWER AND COMMUNICATION

### Power

- The camp is run by a Tesla solar plant with generator back-up;
- The system produces 220V, 24-hour electricity.

### Internet & Mobile

Wi-Fi available. No mobile signal.

## HEALTH AND SAFETY

### Health

- Medium risk – Malaria prophylaxis are recommended;
- Tsetse flies are found in the area - it is advisable to avoid wearing dark blue and black clothing which can attract them. We recommend bringing along antihistamine tablets and creams;
- Guests must hold comprehensive medical insurance and emergency evacuation insurance;
- Senior staff all have first aid training;
- Nearest decent medical facility is in Harare or Victoria Falls in Zimbabwe and then Johannesburg in South Africa.

### Possibility of Disabled Access

The camp layout and experiences are not conducive to guests who use wheelchairs due to the terrain.



## SAFETY

- This is a remotely located camp and is unfenced to wild animals that do move through the property especially at night;
- Night Watchmen for wildlife;
- Fire extinguishers in the main camp areas and every suite.

## MONEY MATTERS

### Safes

Safes are provided in the guest suites.

### Accepted Payment on Location

- Staff gratuities and extras can be paid by credit card or in US Dollars (2004 bills or later only), Euro or GB Pounds;
- Visa and MasterCard credit cards are accepted (No Amex or Diners).

The Team

Lodge Owners

**Great Plains Conservation**

# TEMBO PLAINS CAMP

SAPI PRIVATE RESERVE | GREATER MANA POOLS UNESCO WORLD HERITAGE SITE



## FOUNDATION INITIATIVE

### Sapi Restoration

In Zimbabwe, Great Plains is securing the Sapi Reserve, an expansive and fragile landscape that forms the heart of a UNESCO World Heritage Site and the Middle-Zambezi Biosphere Reserve. The goal of the Sapi Restoration Initiative is to restore this depleted landscape through a combination of strategic protections, a comprehensive conservation plan, species reintroduction and conservation tourism.

Our landscape restoration efforts in Zimbabwe's Sapi Reserve follow in the footsteps of our nearly 15-years managing and protecting the Selinda Reserve in Botswana. In late 2016 Great Plains Conservation was awarded the 290,000-acre Sapi Reserve to conserve and manage. Hunted since 1957, this important area of Zimbabwe is set on the Zambezi River and borders Mana Pools National Park. Working with teams of world-renowned experts, the Great Plains strategy for the Sapi Restoration Initiative includes developing basic infrastructure, roads and communications systems, a strategic wildlife management plan, wildlife monitoring teams (including female rangers), support for ZimParks, species reintroduction, on-going flora and fauna surveys, and photographic tourism; all with a single goal in mind: to restore and protect this essential ecosystem.

The Sapi Restoration Initiative represents large landscape conservation at its best, combining best practices in land management and sound business principals through the tourism. Learn more at [www.greatplainsfoundation.com](http://www.greatplainsfoundation.com)

In addition to our own programs Great Plains Foundation keeps a list of school needs in the countries where we work. Needed items can be hand-carried by travelers or we can help purchase them locally. To learn more or to help support students and educators as part of your trip please reach out [info@greatplainsfoundation.com](mailto:info@greatplainsfoundation.com)





2m 11.5m 2.5m

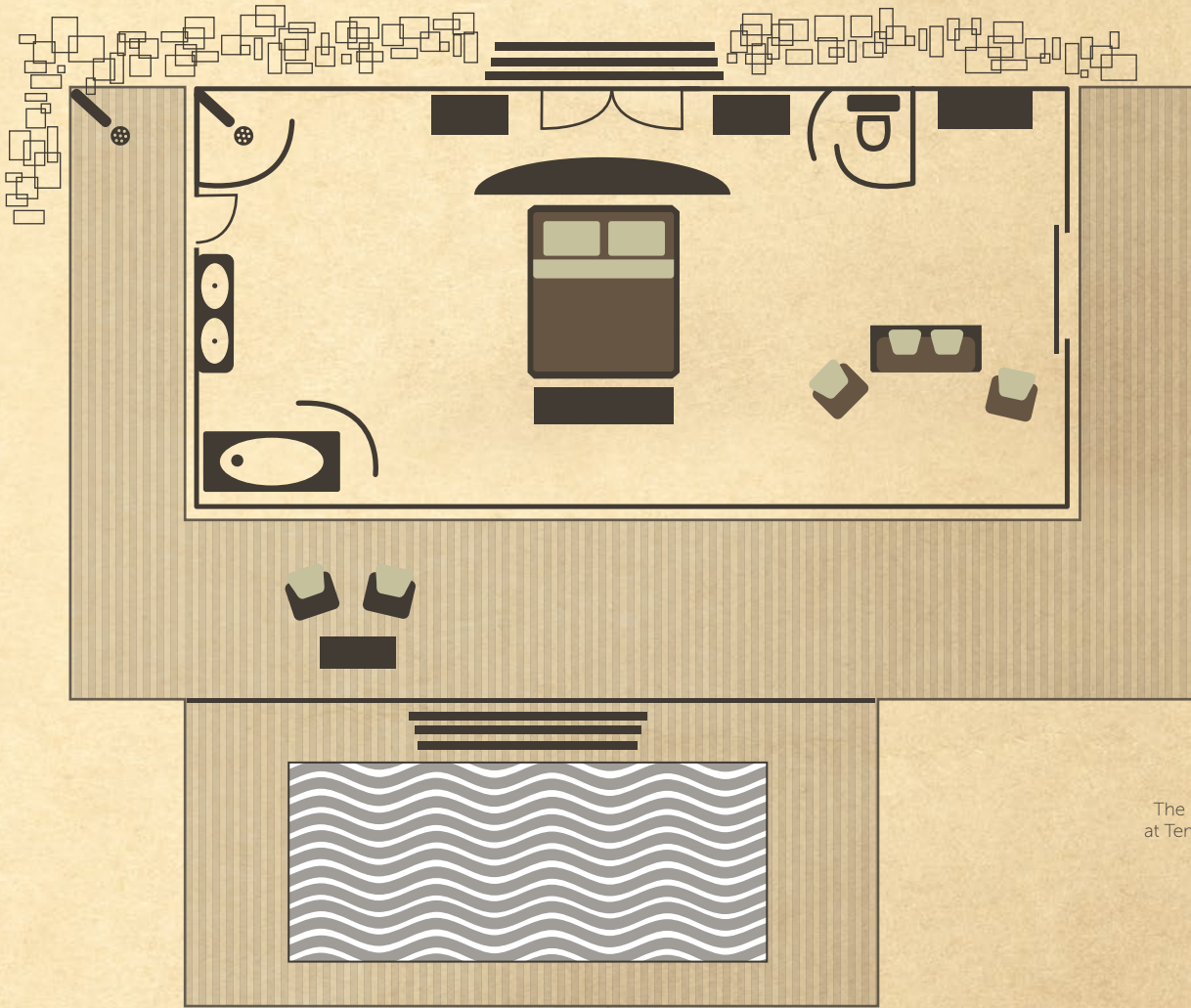

1.9m  
6m  
7m

ZIMBABWE  
GREAT PLAINS

TEMBO PLAINS

GUEST SUITE

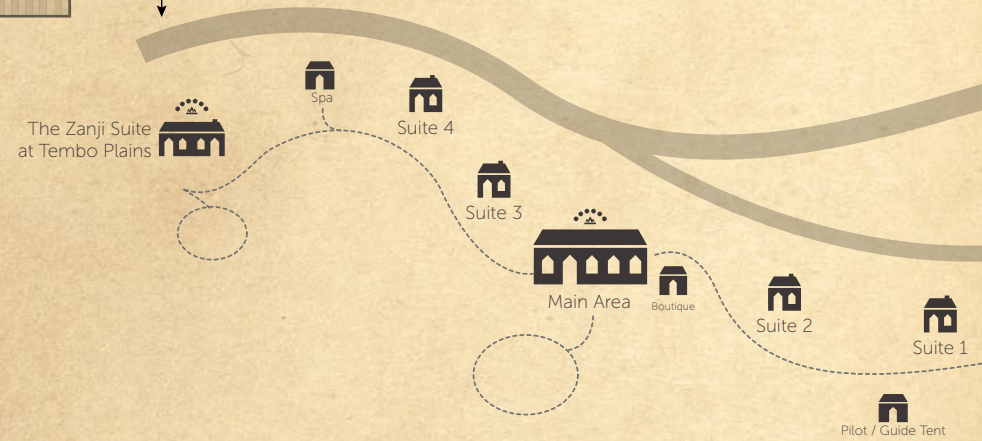



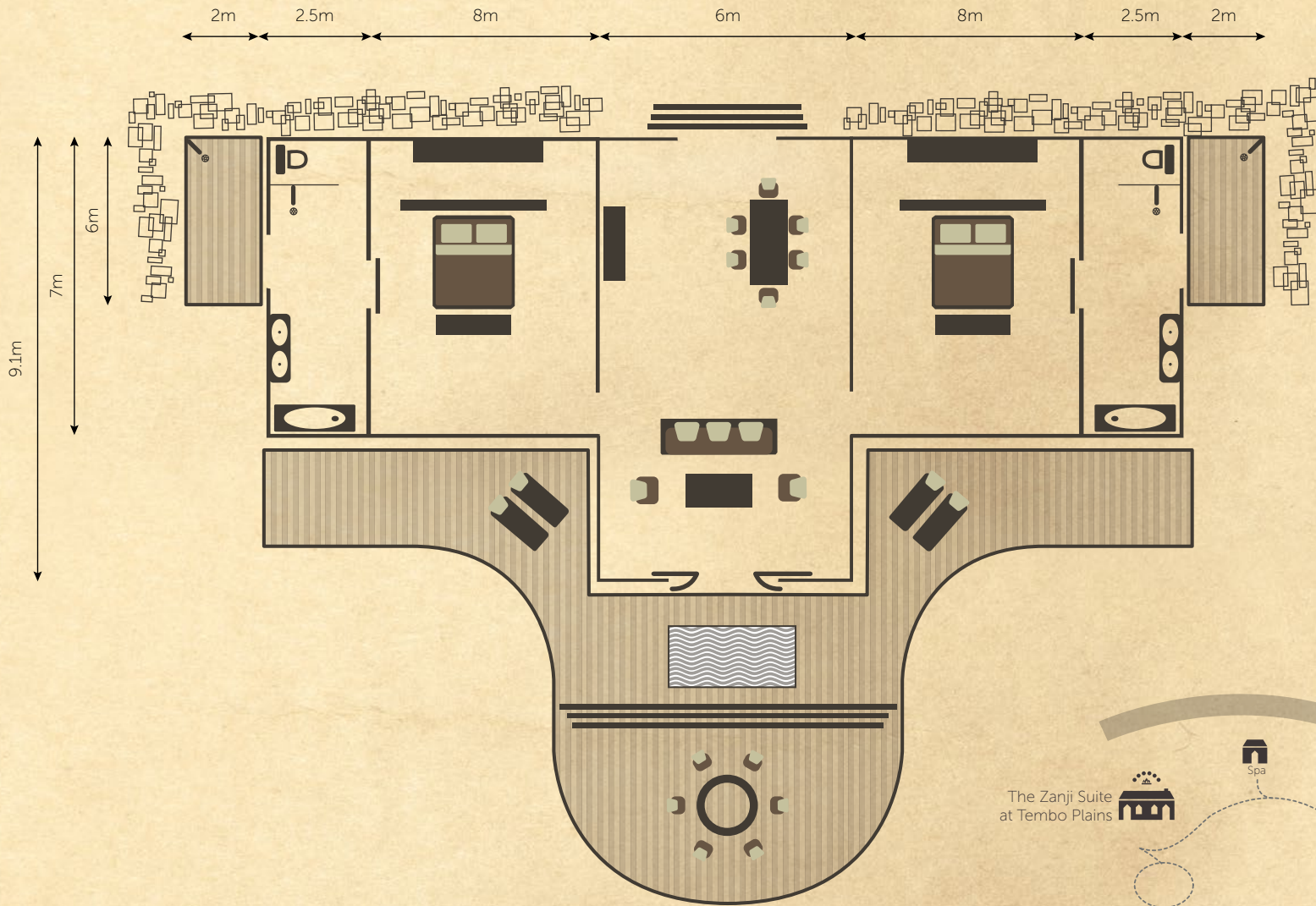

ZIMBABWE  
**GREAT PLAINS**  
 THE ZANJI SUITE AT TEMBO PLAINS

**THE ZANJI SUITE AT TEMBO PLAINS**

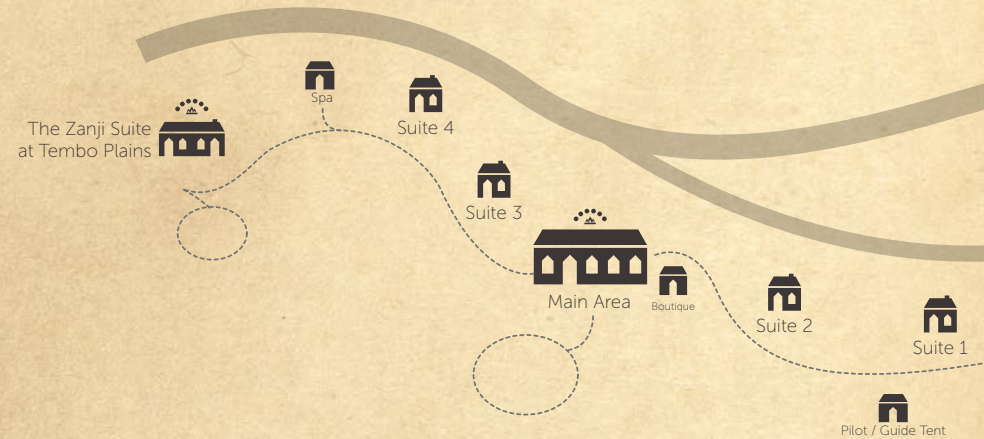



# GREAT PLAINS

CONSERVING AND EXPANDING NATURAL HABITATS

Zambia

Zimbabwe

Botswana

● Tembo Plains Camp &  
The Zanji Suite at Tembo Plains

*Sapi Private Reserve*

*Mana Pools National Park*

*Lake Kariba*

*Matusadona National Park*

*Chirinda Safari Area*

Mpala Jena

Kasane

Livingstone

Victoria Falls

*Zambezi River*

*Kasane Forest Reserve*

*Zambezi National Park*

*Matetsi Safari area*

*Sibuyu Forest Reserve*

*Hwange National Park*



GREAT PLAINS CONSERVATION  
STRIVES TO FIND THE RIGHT FORMULA OF  
CONSERVATION, COMMUNITIES AND COMMERCE  
THAT MAKES A LASTING, SUSTAINABLE DIFFERENCE  
TO THE WORLD'S ICONIC WILDLIFE HABITATS

● Harare



### ZIMBABWE CAMPS

| ACTIVITY                                       | TEMBO PLAINS CAMP & THE ZANJI SUITE AT TEMBO PLAINS | MPALA JENA                                     |
|--|---|--|
| Camp Classification                            | Réserve Collection                                  | Preferred Partner of Great Plains Conservation |
| Location                                       | Private Sapi Reserve                                | Zambezi National Park                          |
| Size of concession / reserve                   | 128 000 Hectares / 280 000 Acres                    | 56 000 Hectares / 138 000 Acres                |
| Traversing                                     | Private Sapi Reserve & Mana Pools National Park     | Zambezi National Park                          |
| Number of Suites                               | 4 Suites  | 3 Suites                                       |
| Family Accommodation                           | One 2-bedroom suite                                 | 2 Family Suites                                |
| Children can be accommodated from:             | 6 Years   | 6 Years  |
| Safari Drives                                  | Yes   | Yes  |
| Private Vehicle (at an additional charge)      | Yes (Included with The Zanji Suite at Tembo Plains) | Yes  |
| Guided Walks                                   | Yes   | Yes  |
| Boating  | Yes   | Yes (water level dependent)                    |
| Canoeing                                       | Yes   | n/a  |
| Fishing (Seasonal)                             | Yes   | Yes  |
| Main Swimming Pool and/or Private Plunge Pools | Private plunge pools                                | Main swimming pool                             |
| Shower   | Indoor & Outdoor                                    | Indoor & Outdoor                               |
| Bath   | Indoor  | Outdoor  |
| Hairdryers (low-voltage)                       | Yes   | n/a  |
| Mosquito Nets                                  | Yes   | Yes  |
| Eco cooling system over bed                    | Yes   | n/a  |
| Fan  | Yes (Standing)                                      | Yes (Ceiling)                                  |
| Wi-Fi – in-room (complimentary)                | Yes   | Yes  |
| Safe - In-room                                 | Yes   | Yes  |
| Spa treatments (at an additional charge)       | Yes   | Yes (In-room only)                             |
| Fitness  | In-room equipment                                   | Yoga mats in each room                         |
| Boutique on site                               | Yes   | Yes  |