

# Singita

MALILANGWE, ZIMBABWE

Suite Layouts & Site Plans

# Singita Pamushana Lodge

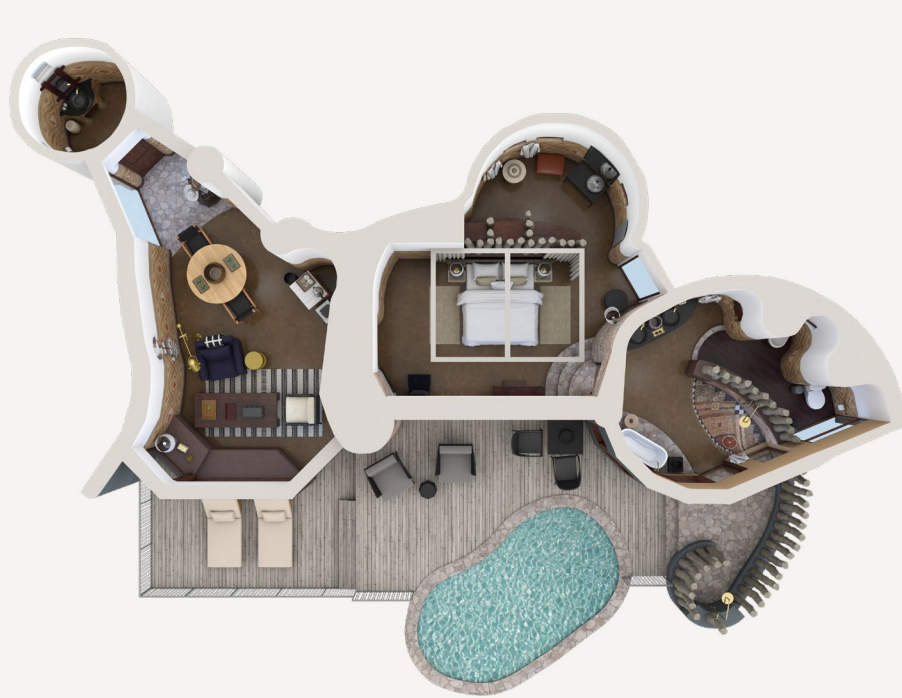

## 4 X ONE-BEDROOM SUITES

DIMENSIONS		
Total	Bedroom	Lounge area
70m <sup>2</sup>	32m <sup>2</sup>	35m <sup>2</sup>



## 2 X TWO-BEDROOM SUITES

\*Suitable for three adults or two adults and two children.

DIMENSIONS			
Total	Master bedroom	Second bedroom	Lounge area
69m <sup>2</sup>	21m <sup>2</sup>	17m <sup>2</sup>	31m <sup>2</sup>

# Singita Pamushana Lodge



## 1 X TWO-BEDROOM FAMILY SUITE

\*Suitable for two adults and two children (0-12 years)

DIMENSIONS			
Total	Master bedroom	Second bedroom	Lounge area
79m <sup>2</sup>	31m <sup>2</sup>	17m <sup>2</sup>	31m <sup>2</sup>

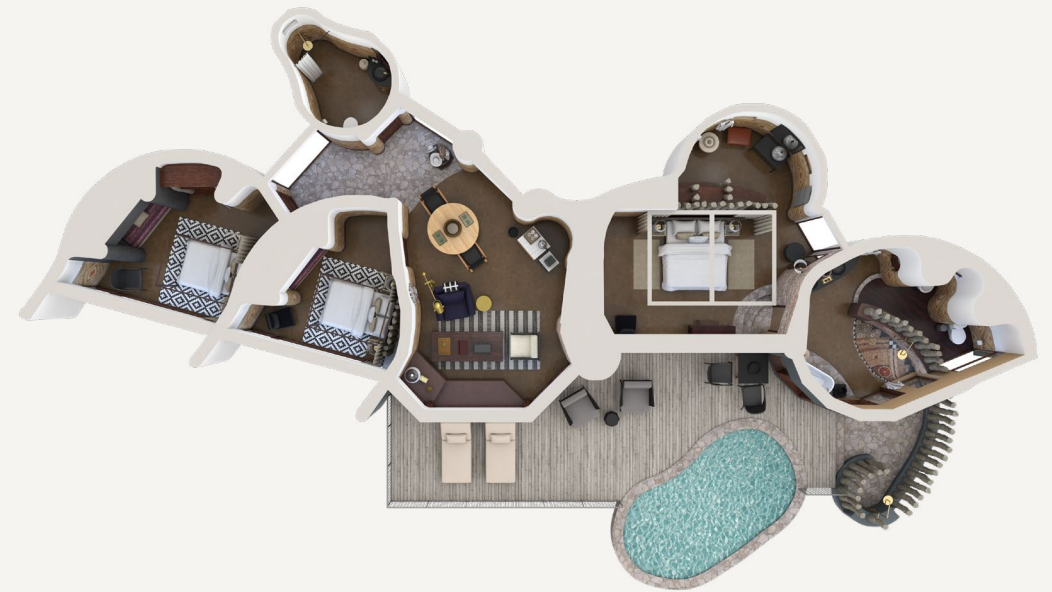

## 1 X THREE-BEDROOM FAMILY SUITE

\*Suitable for two adults and three children (0-12 years)

DIMENSIONS				
Total	Master bedroom	Second bedroom	Third bedroom	Lounge area
101m <sup>2</sup>	35m <sup>2</sup>	16m <sup>2</sup>	19m <sup>2</sup>	31m <sup>2</sup>

# Singita Malilangwe House



## 1 X FIVE-BEDROOM VILLA

\*Max 10 adults, exclusive use.

DIMENSIONS								
Total	Master bedroom	Bedroom 2	Bedroom 3	Bedroom 4	Junior master bedroom	Lounge area	Dining room	Outdoor dining space
301m <sup>2</sup>	59m <sup>2</sup>	26m <sup>2</sup>	27m <sup>2</sup>	23m <sup>2</sup>	29m <sup>2</sup>	63m <sup>2</sup>	26m <sup>2</sup>	48m <sup>2</sup>

\*All dimensions are approximate and room layouts are for illustrative purposes only.





- A Main lodge
- B Swimming pool
- C Lounge
- D Bar & deli
- E Dining
- F Boutique & gallery
- G Boma
- H Centre lawn
- I Fitness centre
- J Spa
- K Singita Malilangwe House
- 1 1 bedroom suite
- 2 1 bedroom suite
- 3 1 bedroom suite
- 4 1 bedroom suite
- 5 2 bedroom family suite
- 6 3 bedroom family suite
- 8 2 bedroom suite
- 9 2 bedroom suite

MALILANGWE  
DAM

Singita

PAMUSHANA LODGE &  
MALILANGWE HOUSE