



LEWA WILDERNESS

— Est. 1972 —

COTTAGE FLOOR PLAN

EMAIL:
reservations@lewawilderness.com

TELEPHONE:
+254 (0) 796 035 177

WEBSITE:
www.lewawilderness.com

Floor plan is not 100% accurate / fit-to-scale

Garden Cottage One

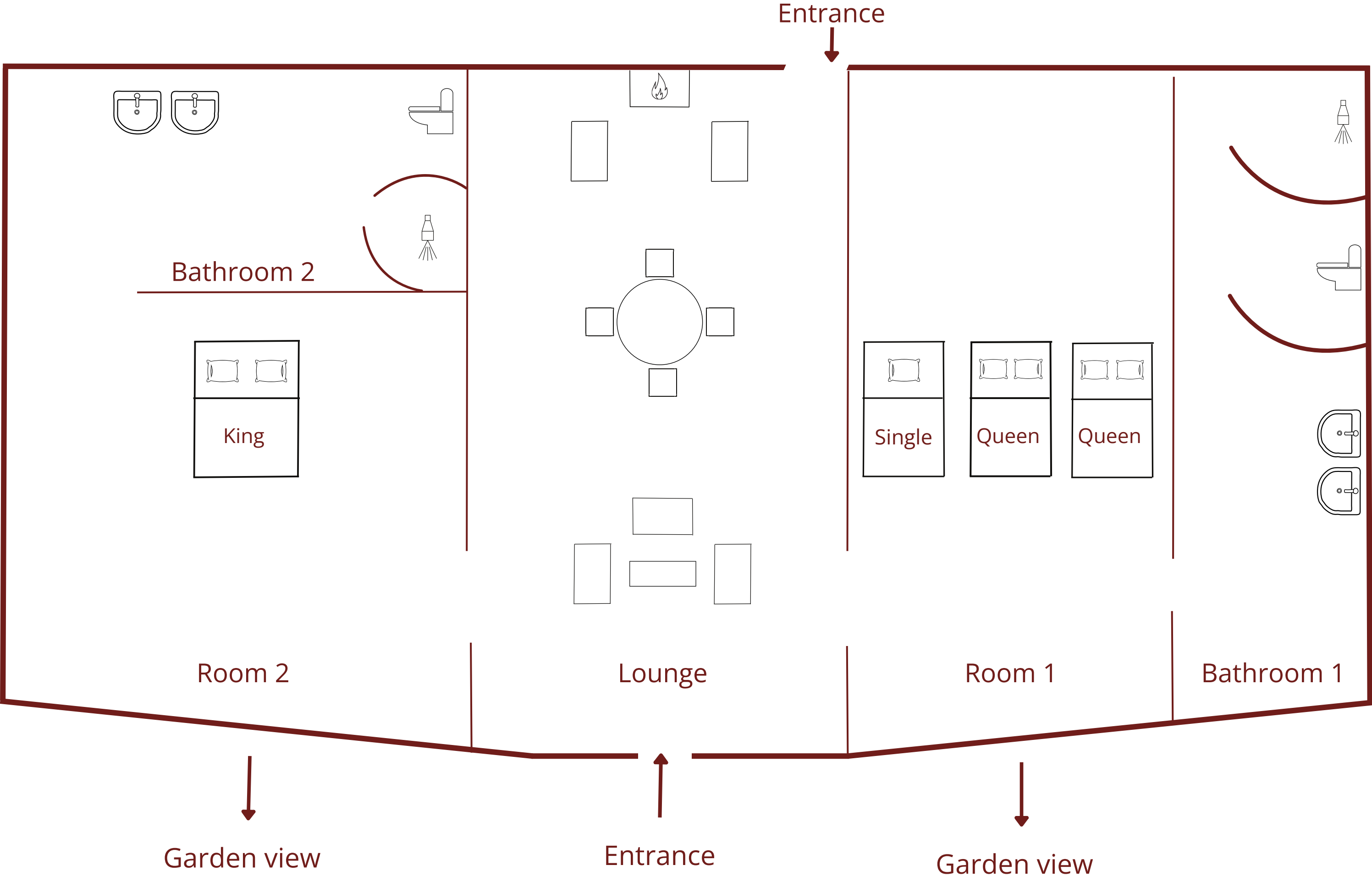

KEY

King: 76" x 84"

Queen: 60" x 80"

Single: 38" x 78"

Click [here](#) for walk-through

Garden Cottage Two

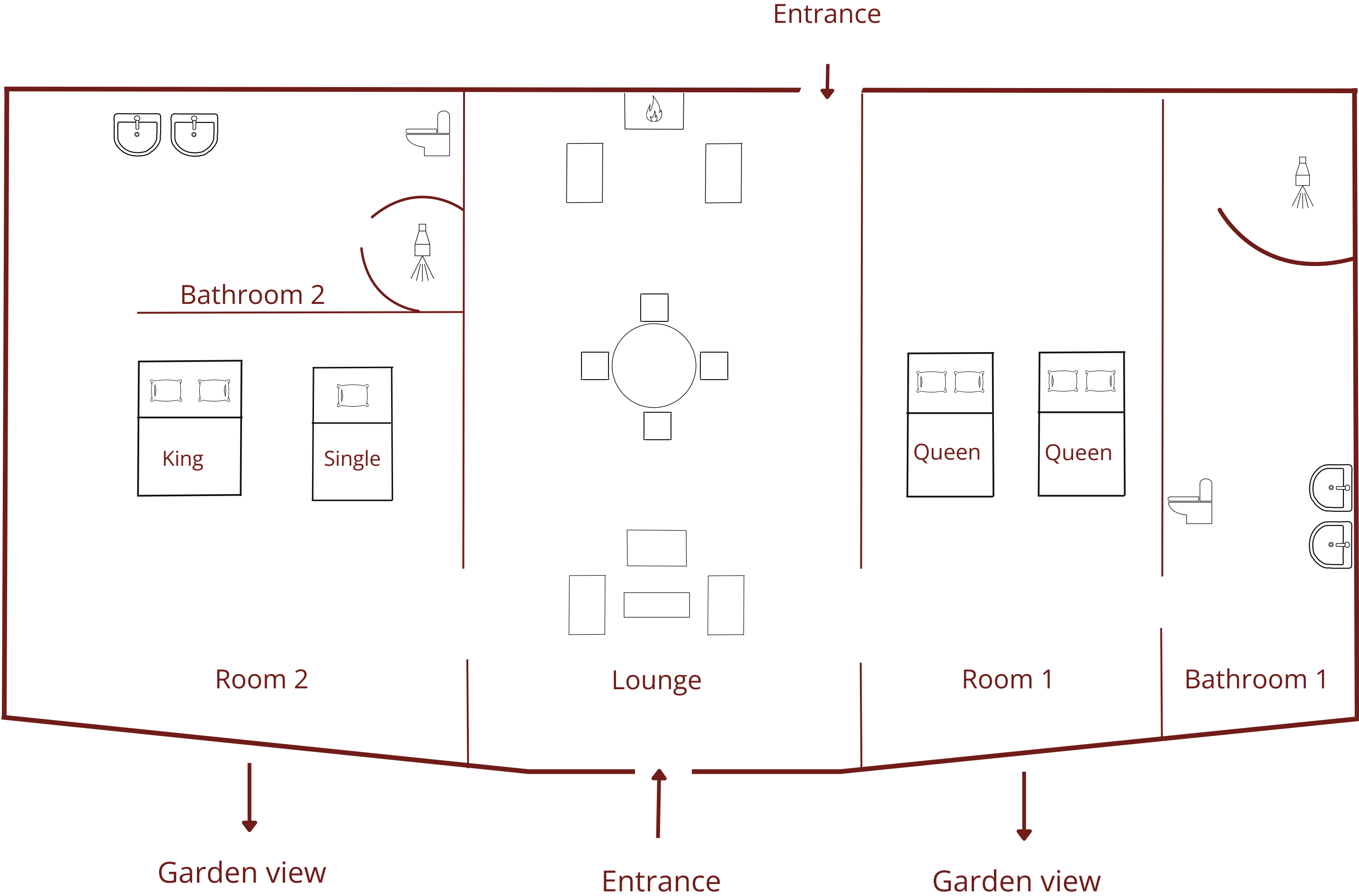

KEY

King: 76" x 84"

Queen: 58" x 80"

Single: 39" x 75"

Click [here](#) for walk-through



LEWA
WILDERNESS

— Est. 1972 —

Garden Cottage Three

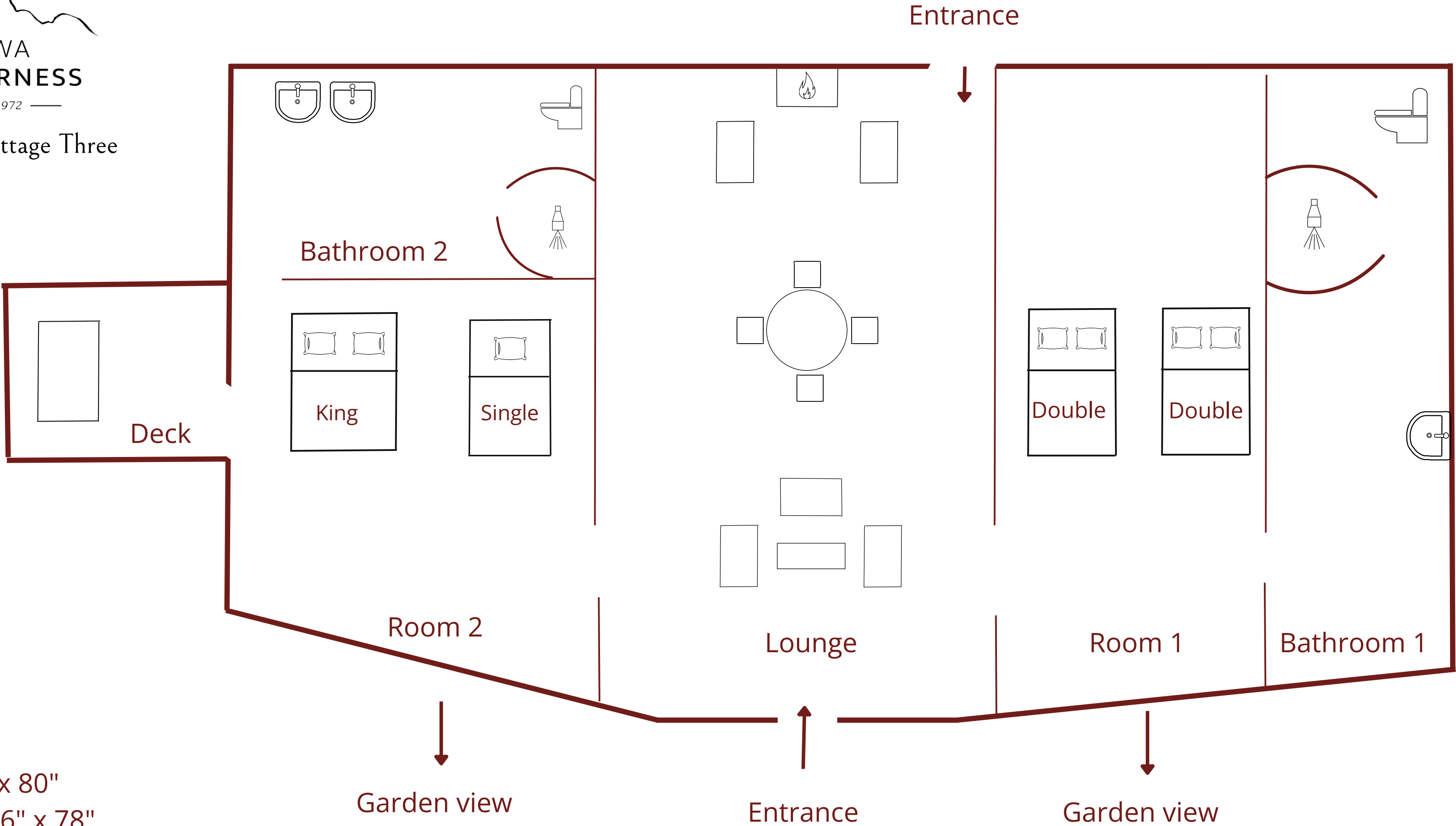

KEY

King: 76" x 80"

Double: 56" x 78"

Single: 40" x 79"

Click [here](#) for walk-through



Hillside Cottage Seven

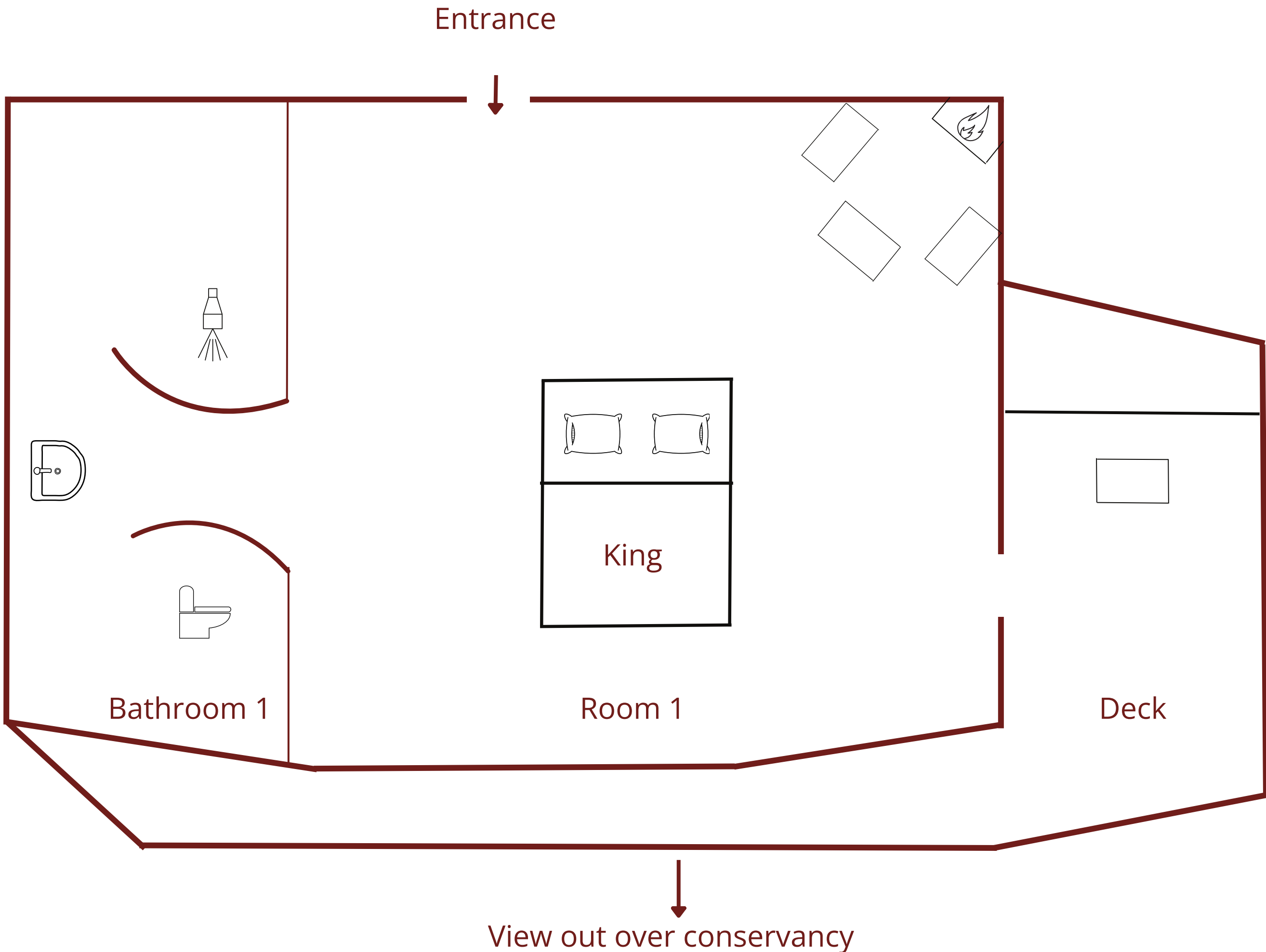

KEY
King: 76" x 80"
Click [here](#) for walk-through



Hillside Cottage Eight

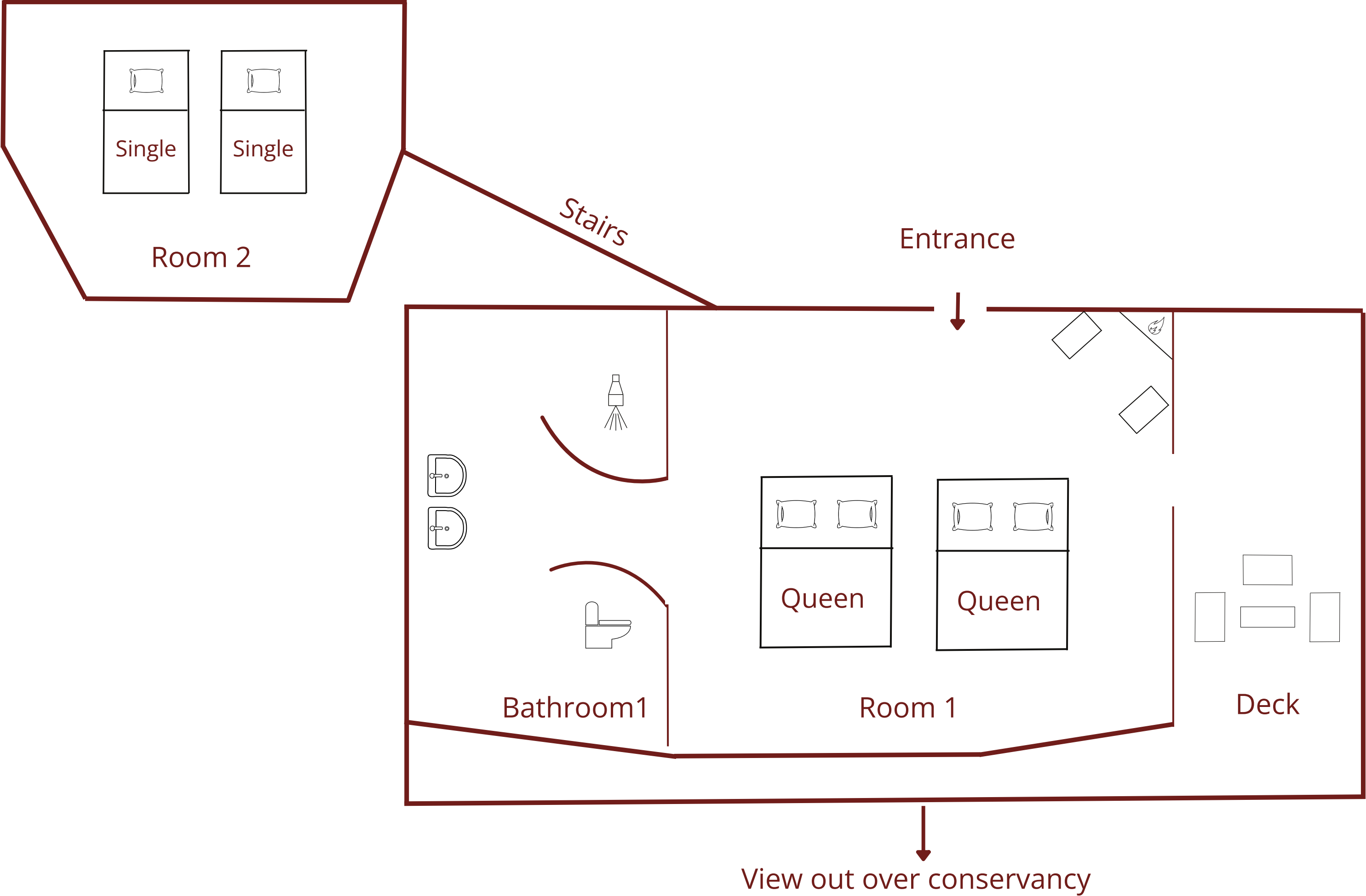

KEY
Queen: 60" x 76"
Single: 43" x 75"
Click [here](#) for walk-through

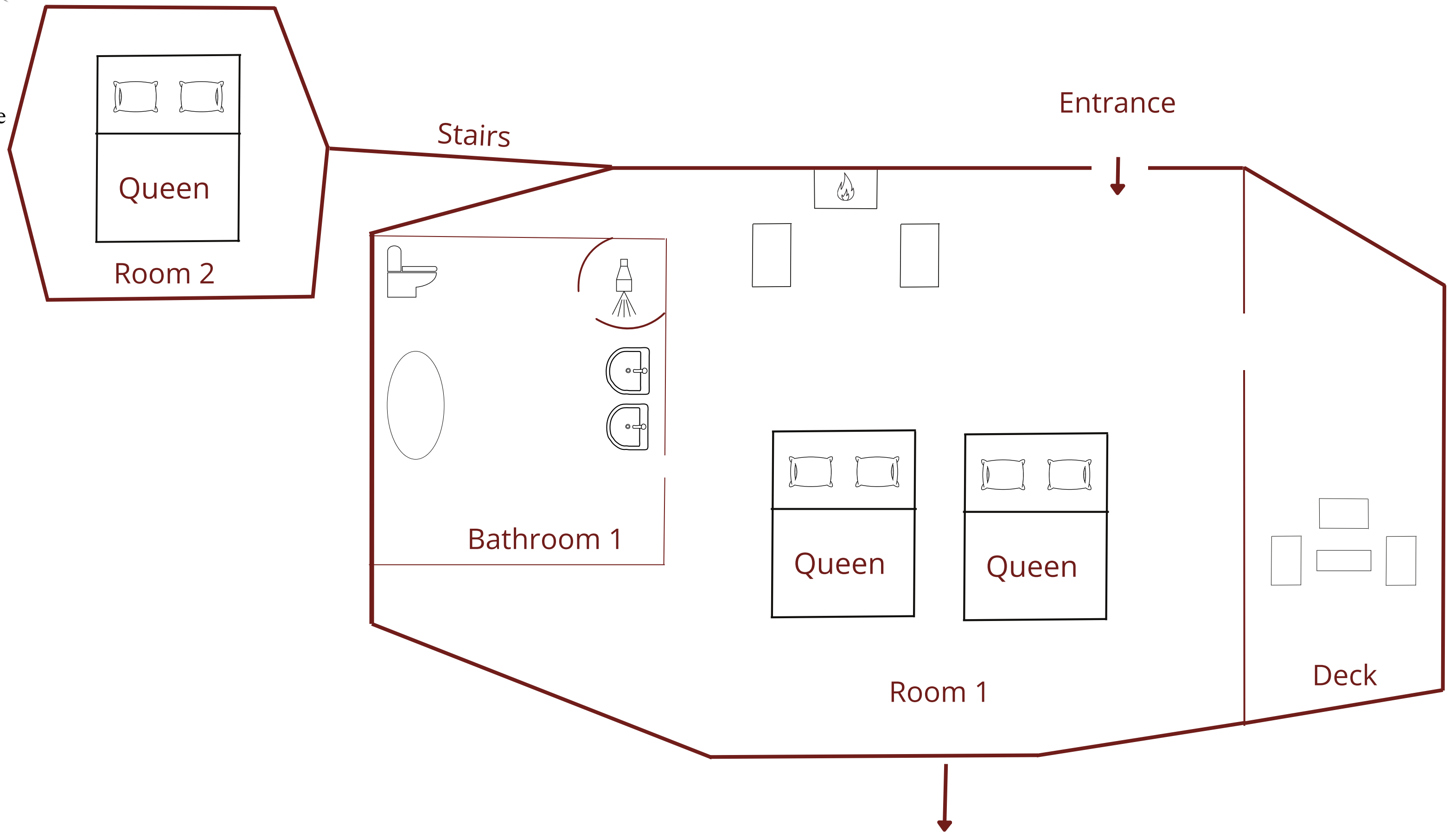

KEY

Queen: 59" x 78"

Click [here](#) for walk-through

Hillside Cottage Ten

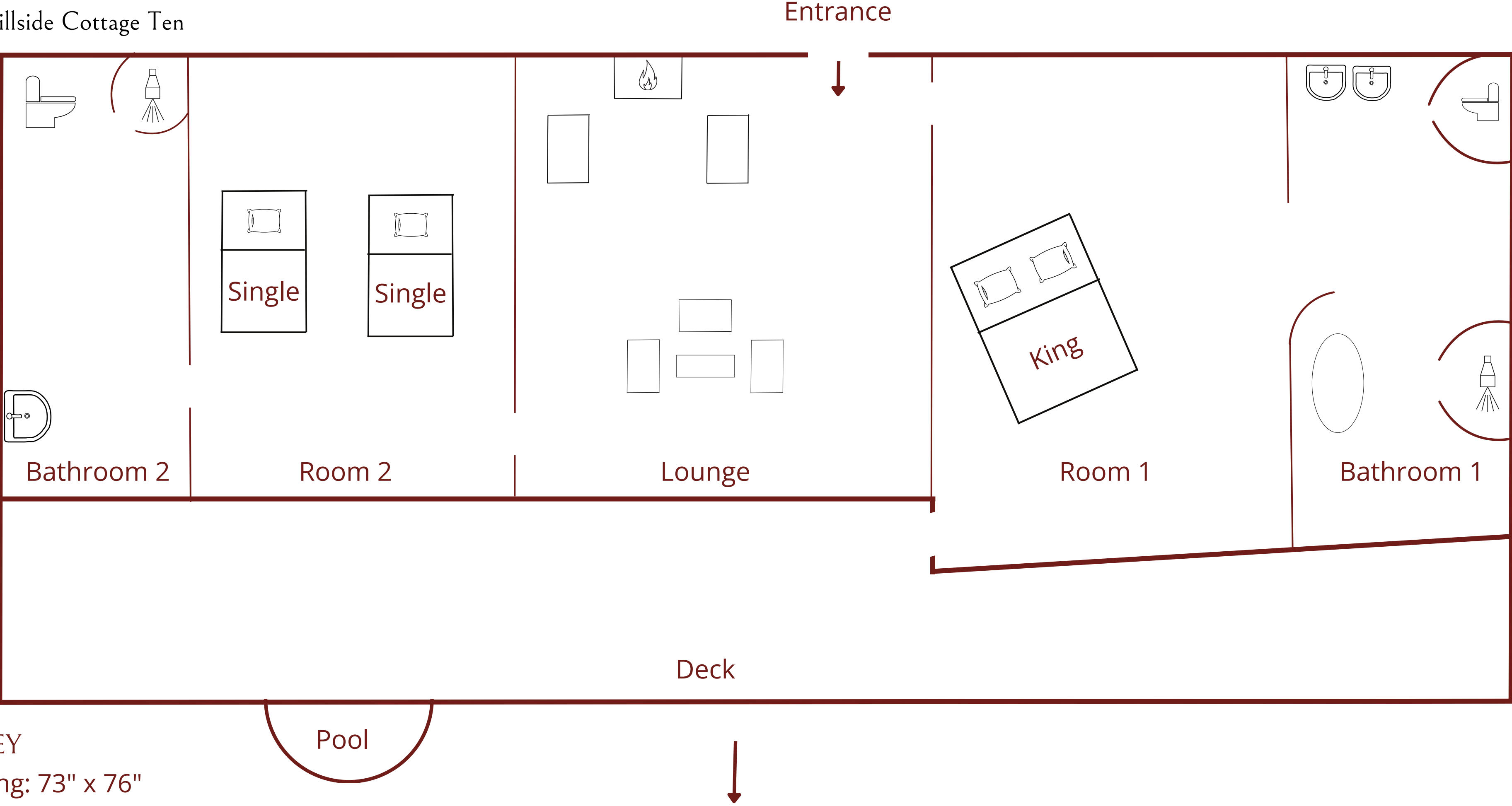

KEY
King: 73" x 76"
Single: 43" x 78"
Click [here](#) for walk-through

View out over conservancy



Hillside Cottage Eleven

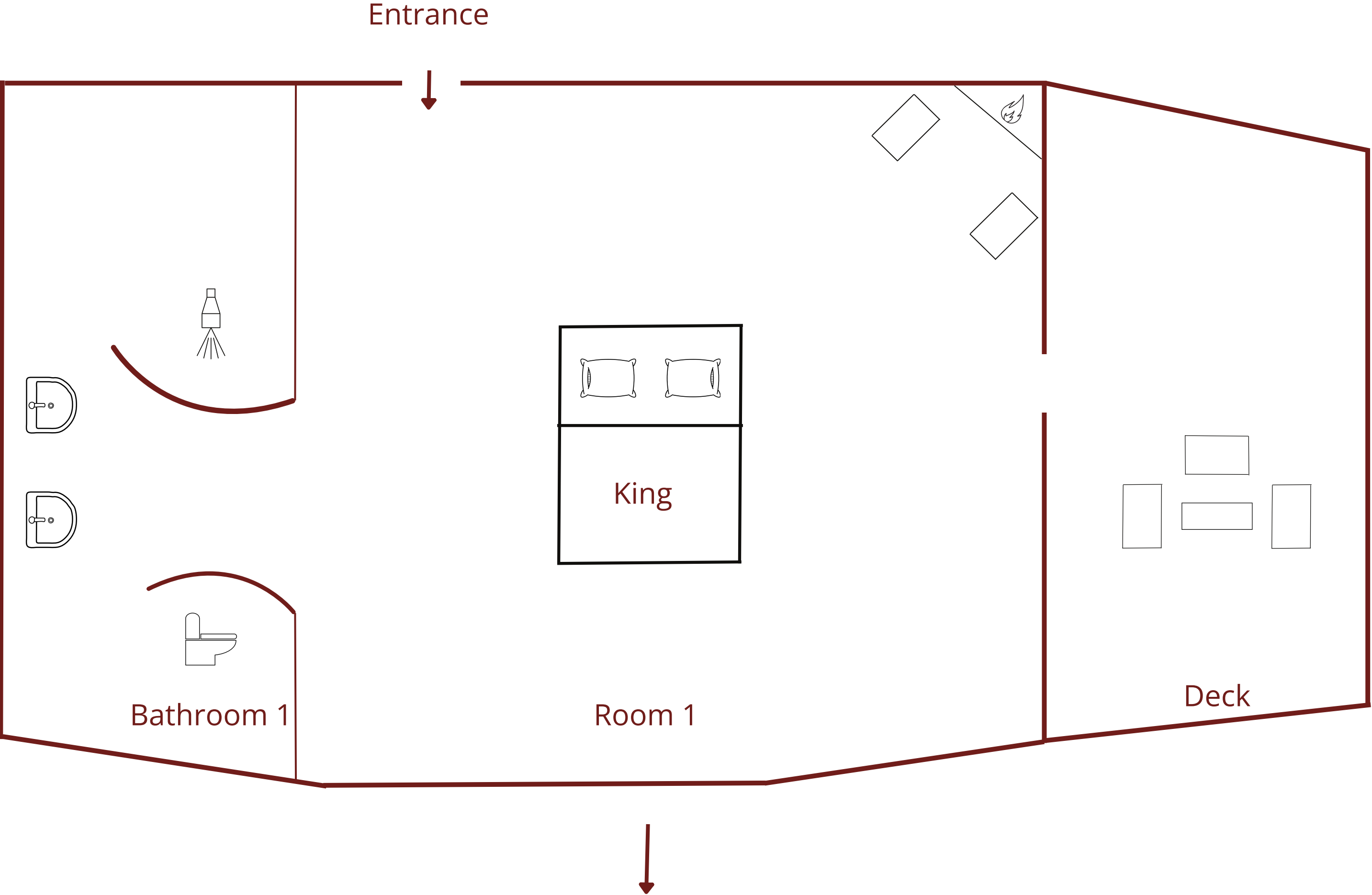

KEY
King: 75" x 78"
Click [here](#) for walk-through

View out over conservancy



Hillside Cottage Twelve

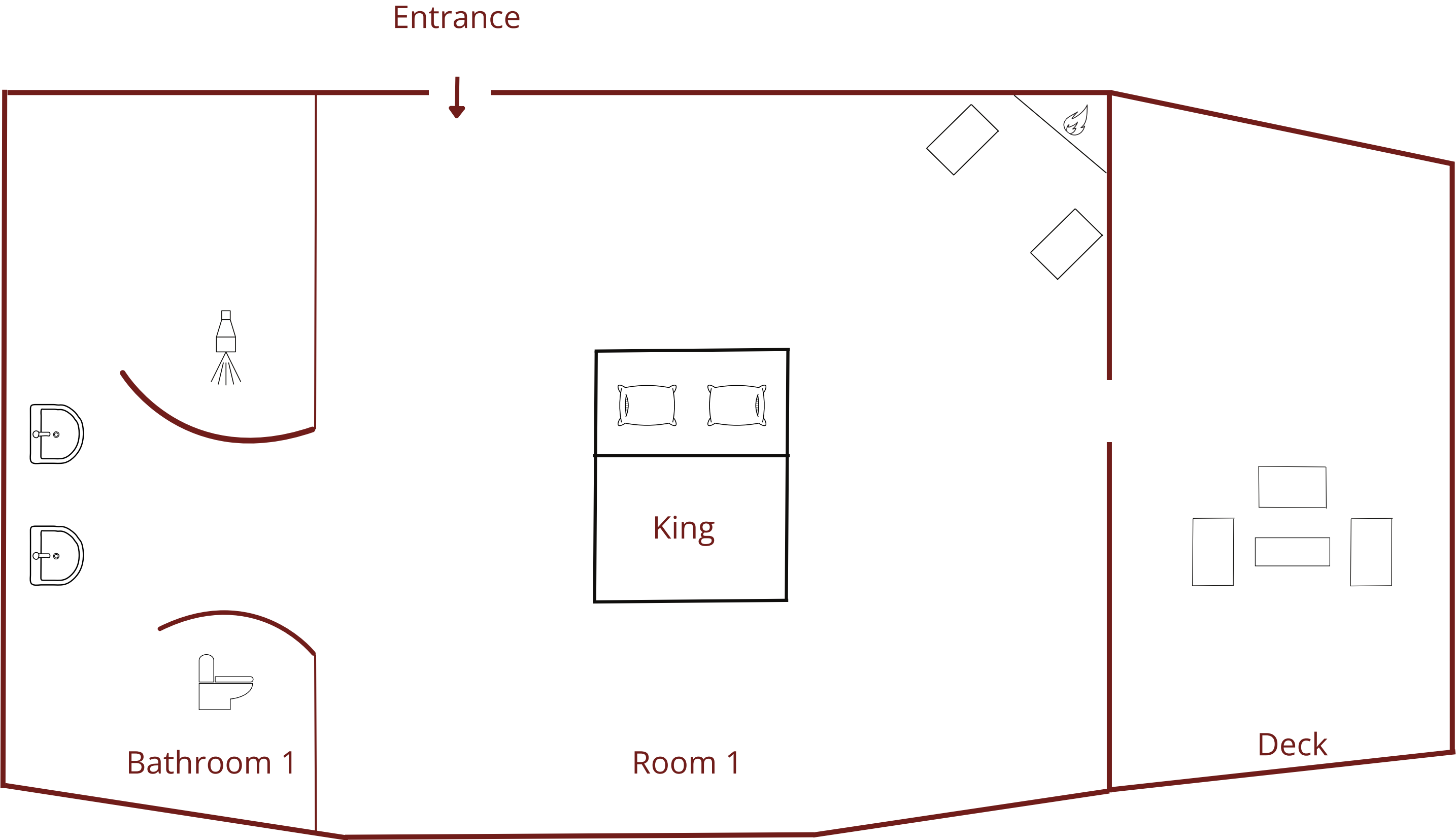

KEY
King: 75" x 78"
Click [here](#) for walk-through

↓
View out over conservancy