

# MARA NYIKA CAMP

NABOISHO CONSERVANCY | MAASAI MARA



**“Nyika” means “Large Plains or Great Plains,” and Mara Nyika Camp is the perfect sister camp to Mara Plains in Kenya.**

It rings with the romance of the vast open plains of East Africa from a time when light canvas flapped in the light breeze across those plains as wildebeest and zebras call to each other and at twilight, “Simba,” the great lion’s roar across the Nyika.

“I spent over three years circling the site of the camp, identifying one site and then another, looking for light or noise pollution and finally settling on an exceptional place,” says Dereck Joubert. “One where each time we visited, we saw a male leopard or a lioness and cubs. A site where no one else will see our lights or canvas. A safari is about creating a story, an ideal dream, and we want to create our own without eroding someone else’s.”

Typical of the Maasai Mara’s ancient Nyika is the flat-topped Acacia kirkii trees. The Dereck Joubert designed guest suites take advantage of these umbrella thorn tree’s shade. While the camp is in a valley, actually straddling a small stream, the suites are set up high under the tree’s canopy to offer guests awe-inspiring views out over the bush.

Many may think of Mara Nyika Camp as a treetop camp, with the suites’ walkways to the main area giving a feel of a treehouse under canvas. However, the camp’s ethic and inspiration are still one of exploration and adventure - a sense of impermanence in this ever-changing world. Privacy in this camp is the key to understanding it. Privacy to live, think, explore, be romantic, and be pampered – all the while with one of the most spectacular backdrops Africa can provide. The camp is a proud Relais & Châteaux member.

Mara Nyika Camp, located in the private and exclusive 20 000-hectare Naboisho Conservancy, is unique because it allows guests to explore the conservancy and further afield with safari drives into the Maasai Mara Reserve. Guest’s stay enables us to support over 500 Maasai families with a sustainable livelihood through the payment of conservation fees, which ultimately ensures the conservation of the wildlife in this vital corridor of the Maasai Mara eco-system.





# MARA NYIKA CAMP

NABOISHO CONSERVANCY | MAASAI MARA

Many Mara Nyika's guests spend a few days here before extending their safari to either our Mara Expedition or Mara Plains Camps. Combining these camps ensures a more comprehensive wildlife experience as guests explore all three wildlife areas: the private Olare Motorogi and Naboisho Conservancies and Maasai Mara Reserve. Each wildlife experience from our camps is unique and offers different Mara faces, which is an unbelievable bonus.

## CAMP FEATURES

Mara Nyika Camp can accommodate up to 12 adult guests.

### Total Number of Bedrooms:

- 3 double or twin configuration guest suites;
- One 2-bedroom family suite;
- The 2-bedroom private Sambuk Suite at Mara Nyika can accommodate a family of 5 with 2 adults and 3 children (aged 6 – 15 years), or 4 adults traveling together;
- 1 guide tent with a bed and bathroom

### Type of Lodge:

Réserve Collection Safari Camp

### Lodge Season & Opening:

Year Round

### Ideal length of stay:

3 / 4 Nights



## CHECK OUT TIME

We maintain a high level of flexibility when it comes to check-out times at our camps. However, due to some scheduled air transfer schedules, there are instances where we may kindly request guests to check out of their suites by 9:00am. In such situations, our lodges and camps are set up to ensure that guests can utilise the facilities located in the central area. This includes access to Wi-Fi, the provision of complimentary drinks and lunch in the event of any unexpected delays, and access to hides or other activities if available.

## CAMP CO-ORDINATES

1°22'30.6"S 35°17'24.6"E

## ACCESS DIRECTIONS

- Scheduled aircraft transfers to the nearby Naboisho (Ol Seki) airstrip, from Nairobi's Wilson domestic airport (flying time 1hr 15mins) and other locations in Kenya;
- Private Air charter access available;
- Mara Nyika Camp is an approximate 40-minute drive from the airstrip with often wildlife viewing opportunities en route;
- Co-ordinates: S01°22.557', E035°17.649';
- Olseki Airstrip length: 1300m



# MARA NYIKA CAMP

NABOISHO CONSERVANCY | MAASAI MARA



## ACTIVITIES

### Wildlife viewing

Safari drives (day & night) in some of the most luxurious wildlife viewing vehicles are available.

Each Toyota Land Cruiser is open-sided, canopied, and customised for photographers with fold-down screens, raised roofs, photographic bars, multi-plug invertors, all in keeping with the origins of Dereck & Beverly Joubert as National Geographic photographers. With just four to six guests each, these vehicles also have fridges stocked with drinks and snacks, ready for longer days out if the wildlife viewing is exciting and just too hard to leave.

No two days are the same on safari. Wildlife viewing often starts at sunrise, returning to camp for a late breakfast and departing again in the mid-afternoon after tea before returning just after sunset.

However, we can often go out all day with a packed breakfast, lunch, and beverages should you wish. One visit per guest's 3- or 4-night stay includes heading into the famous Maasai Mara Reserve. Should you want to visit the Mara on more occasions, these would be subject to additional park fees payable. Very often, our safaris will continue into the night, a possibility because of our location on the private Naboisho Conservancy. Night drives are incredibly prolific, and while they take patience, sightings commonly include lesser-known nocturnal mammals and even lion and hyena hunts.

### Hot Air Ballooning

Hot air ballooning is available but should be booked in advance, subject to availability, and additional cost. Departures are very early in the morning to allow time to transfer to the nearest launching point.

### Cultural Experience

The Naboisho Women's Group cultural experience is supported by the Great Plains Foundation, enabling the group to purchase raw materials in bulk including a tailor hired to work on leather products. Available to guests staying at Great Plains Conservation camps all profits from the sale of their wares are ploughed back into the women's business training to ensure this group is self-sustainable. Items available for purchase include, but are not limited to, beaded & leather products, coasters, bracelets, necklaces, belts, dog collars, earrings, and decorated dawa sticks for example.

### Photography

Each of Mara Nyika's guest suites comes with a pair of high-quality binoculars for guests to enjoy in addition to a professional camera set, including a camera body and 100-400mm and 24-70mm lenses. Our team will download all the guest's photos to a memory stick on the guest's departure.



# MARA NYIKA CAMP

NABOISHO CONSERVANCY | MAASAI MARA

## Private vehicle option

Available for more flexibility upon request at extra cost;  
Not compulsory for families travelling with children.

## Private Guides

Private guides are encouraged and welcomed.

## CENTRAL FACILITIES

- Main lounge;
- Dining room, wine cellar, and bar;
- Coffee/tea station;
- Outdoor fire pit with seating;
- Great Plains Safari Boutique: Selling locally and regionally produced crafts, many of which support local community projects in the nearby Maasai communities. The Boutique also stocks the d&b clothing line: Dereck and Beverly Joubert have inspired this bespoke range of clothing they typically wear, and which is perfect and cool while on safari yet elegant when in the city. All materials are responsibly sourced.

Visit [www.greatplainsconservation.com/safariboutique/](http://www.greatplainsconservation.com/safariboutique/)

## FOOD AND BEVERAGE

- Our world-class meals are Relais & Chateaux recognised;
- All meals included and prepared by our Executive Chefs and their teams in a state-of-the-art kitchen that guests are welcome to visit;

- All drinks and beverages are included, including imported spirits and champagnes;
- Group meals and/or individual tables, a la carte menu options;
- Indoor and outdoor dining;
- Private dining on guest's private verandah on request;
- All dietary requirements are catered for from regular to vegan to children; prior notice required;
- We are extremely flexible on timings. Picnic breakfasts or lunch (or both) are the norm due to very active safari drives, often delivered to the bush!

## ACCOMMODATION DETAILS

### Bedroom features

- 3 Guest suites each measuring 1,000 sq. foot, with private verandah (of nearly equal size);
- The Family Suite enjoys a common lounge area, flanked by two bedrooms (one with double bed and other with twin bed configuration), and two en-suite bathrooms (one with bath and shower and one with only shower);
- The 2-bedroom private Sambuk Suite at Mara Nyika offers private wildlife viewing vehicle & guide - separate fact sheet available;
- Customized, large, elevated, tree house-styled canvas tented suites on raised wooden decking and linked to main area by raised wooden walkways;





# MARA NYIKA CAMP

NABOISHO CONSERVANCY | MAASAI MARA

- Desk and dressing area as well as small lounge;
- Bar fridge with drinks of choice;
- Tea/Coffee station;
- Suites are light beige in colour with high ceilings and netted windows, so are airy and bright;
- Overhead ceiling fan;
- Either twin or double bed configuration.

## Bathroom features

- En-suite with flush loo, shower (indoor), copper bathtub and double basins;
- Hot and cold running water.

## ACCOMMODATING CHILDREN AND SHARING ACCOMMODATION

- We look forward to having children stay with us that are 6 years and older;
- Triples for children sharing with adults may be arranged upon request;
- The Nyika Family Suite is perfectly suited to accommodate a family of 4 guests;
- The private Sambuk Suite at Mara Nyika can cater for a maximum of four adults sharing or two adults and up to three children (aged 6 – 15), sharing in two separate bedrooms;
- Families with children may be accommodated in the same vehicle as other guests;



- Young children must be supervised as the camp is open, with high predator densities in and around camp and there is a river nearby;
- Great Plains Young Explorers Kid's program is available – thoughtfully designed to explore various experiences and topics from birding to cooking to art to tracking wildlife.

## SPA TREATMENTS

Locally inspired wellness spa treatments are available for in-room treatments.

## FITNESS

Yoga mats and bands are provided in each suite.

## LAUNDRY

Included in nightly tariff - next day service, weather permitting.

## POWER AND COMMUNICATION

### Power

- The camp is run by an impressive solar farm;
- This system produces 240V, 24-hour electricity to the suites and main area;
- Plug points in each suite;
- Type of plug: Universal plug points;
- Power system does not support hairdryers, shavers or any high wattage device (low voltage hairdryers provided).

# MARA NYIKA CAMP

NABOISHO CONSERVANCY | MAASAI MARA



## Internet & Mobile

- Cell service is relatively good;
- Wi-fi available in guest suites;
- No cell phones or computers are allowed in the public areas of camp or on safari drive vehicles, only in the privacy of guest suites.

## HEALTH AND SAFETY

### Health

- Malaria: Minimal exposure risk– Malaria prophylaxis are recommended if guests are concerned; however, this is a remote area with little occurrence;
- Kenya is considered a Yellow Fever Zone. Consult your medical practitioner prior to travel.
- Guests must hold comprehensive medical insurance and emergency evacuation insurance;
- Senior staff all has first aid training;
- Nearest decent medical facility is in Nairobi.

### Possibility of Disabled Access

The camp layout is conducive to guests who use wheelchairs due to interconnected raised decking and pathways between suites and the main area. There are steps between the main entrance and arrival bridge, but our staff will be on hand to assist;

## Safety

- Safety: The camp is unfenced to wild animals that do move through the property especially at night. Security guards are armed with traditional spears;
- Fire extinguishers in each suite.

## MONEY MATTERS

### Safes

Safes are provided in every suite.

### Accepted Payment on Location

- Staff gratuities can be paid in Kenyan Shillings, US Dollars, Euros or GB Pounds;
- Credit card facilities are available in camp (except American Express) subject to 3.5% charge.

The Team

Lodge Owners

**Great Plains Conservation**



# MARA NYIKA CAMP

NABOISHO CONSERVANCY | MAASAI MARA



## FOUNDATION INITIATIVE

### Naboisho Womens Group

Great Plains supports the Naboisho Women's Bead

Group, based in the community of Nkoilale not far from Mara Nyika. Great Plains' support for the project helps the group to bulk purchase beads and other raw materials for their products and provides training, sales & marketing support. The project enables women in the local community to bolster household income, in turn supporting food security, education, health and more for their families. The project directly impacts the 105 households of the women in the group which means that nearly 1000 people are directly impacted by the money the program generates.

In addition to our own programs Great Plains Foundation keeps a list of school needs in the countries where we work. Needed items can be hand-carried by travelers or we can help purchase them locally. To learn more or to help support students and educators as part of your trip please reach out [info@greatplainsfoundation.com](mailto:info@greatplainsfoundation.com)





# GUEST SUITE

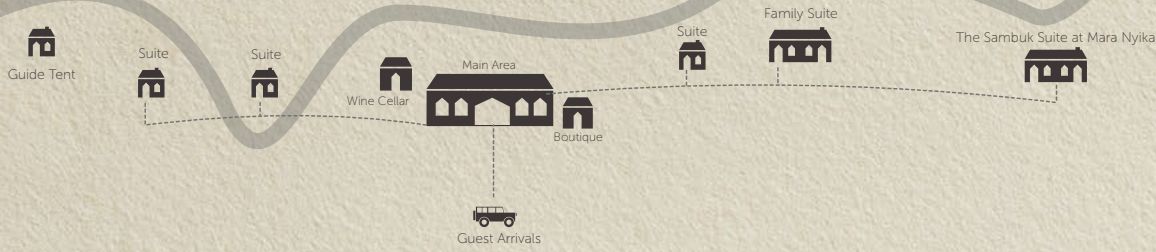



**2 BEDROOM  
 FAMILY SUITE**

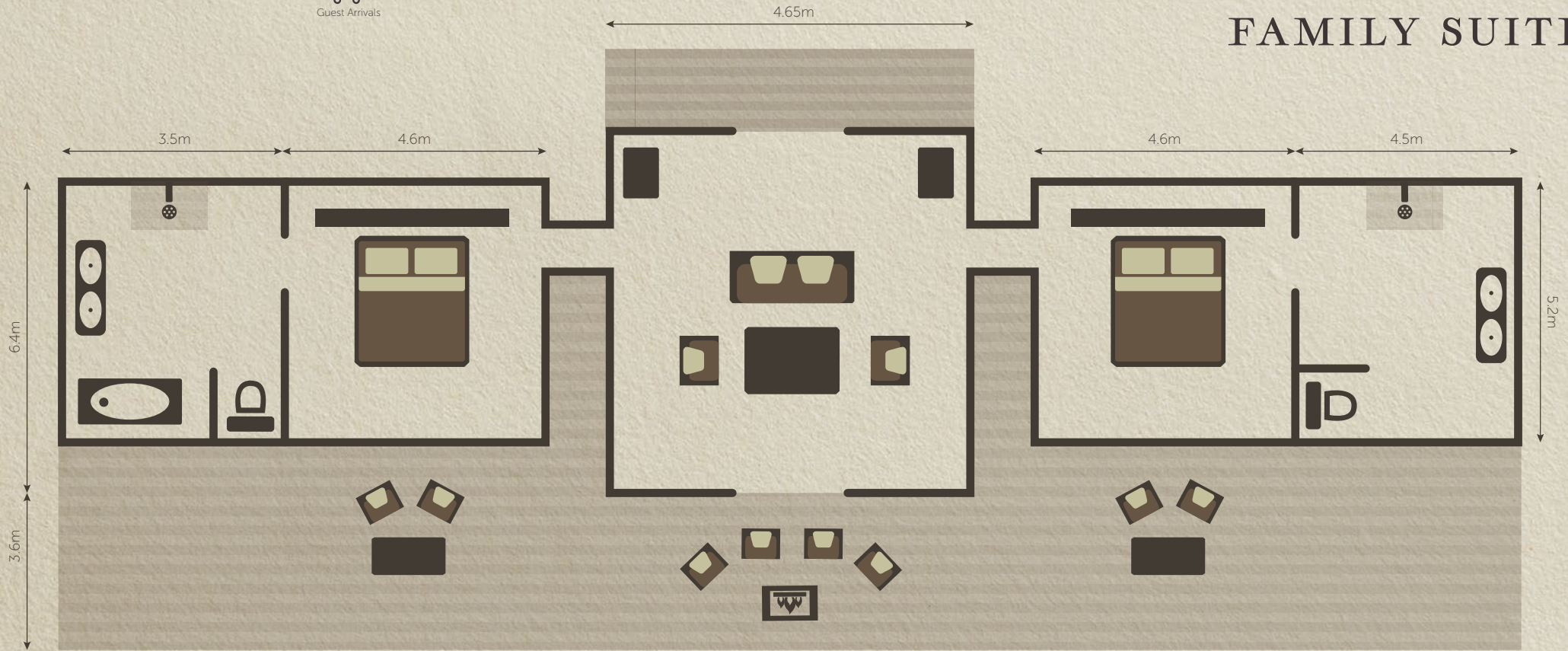
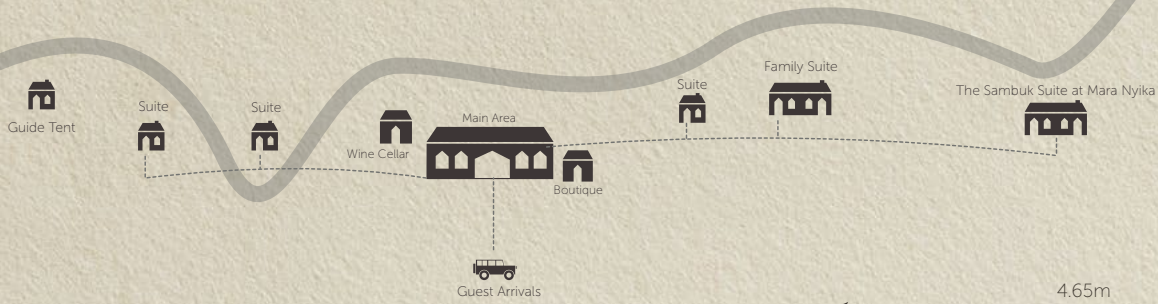



**THE SAMBUK SUITE AT MARA NYIKA**

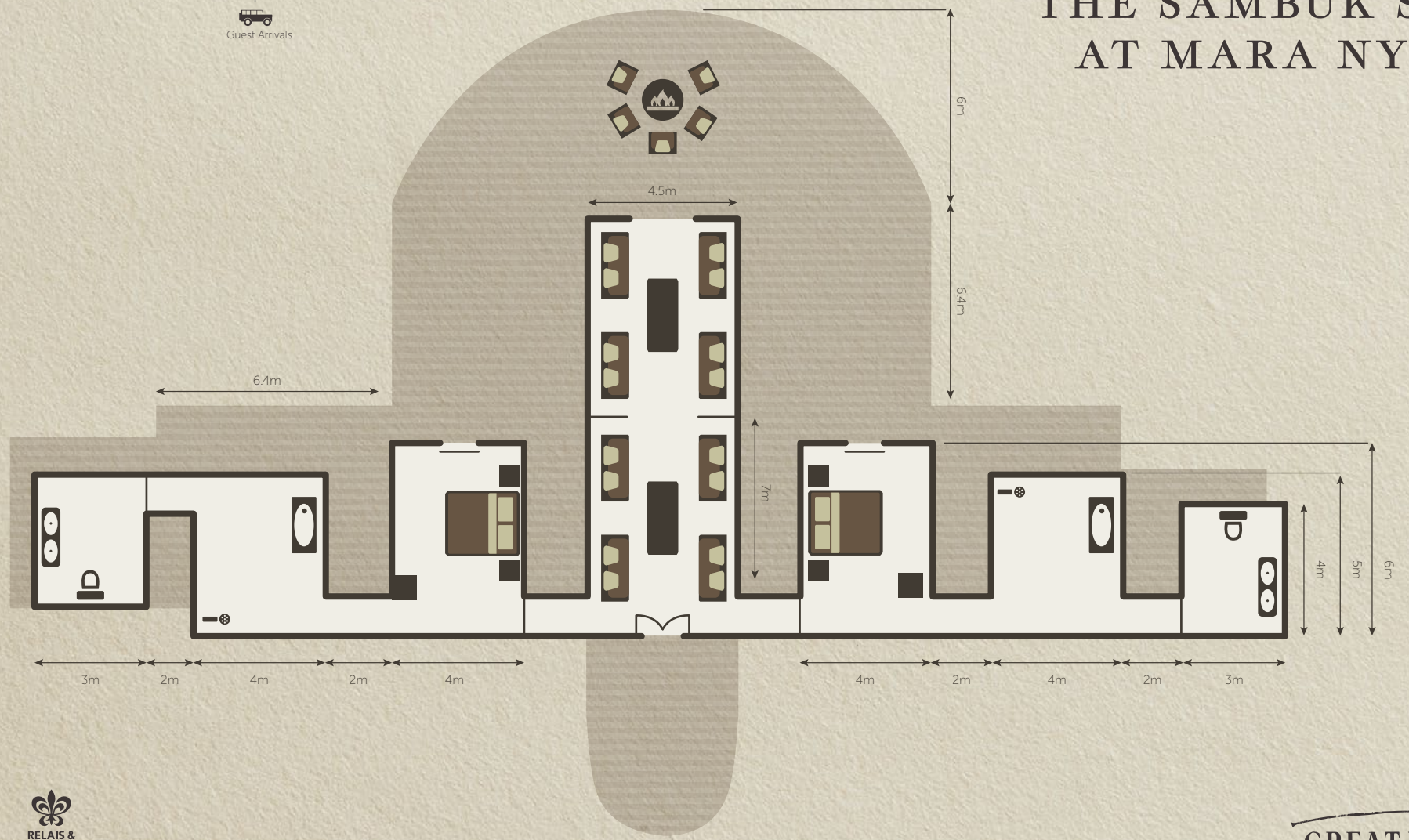



# GREAT PLAINS

CONSERVING AND EXPANDING NATURAL HABITATS



GREAT PLAINS CONSERVATION STRIVES TO FIND THE RIGHT FORMULA OF CONSERVATION, COMMUNITIES AND COMMERCE THAT MAKES A LASTING, SUSTAINABLE DIFFERENCE TO THE WORLD'S ICONIC WILDLIFE HABITATS



Mara Toto Tree Camp • Mara Expedition Camp • Mara Triangle  
Mara Plains Camp & The Jahazi Suite at Mara Plains  
Mara Nyika Camp & The Sambuk Suite at Mara Nyika

Camp Kunji

Nairobi

Kenya

Shompole

Ol Donyo Lodge

Tanzania

Mount Kilimanjaro



### KENYA CAMPS

ACTIVITY	OL DONYO LODGE	MARA PLAINS CAMP & THE JAHAZI SUITE AT MARA PLAINS	MARA NYIKA CAMP & THE SAMBUK SUITE AT MARA NYIKA	MARA TOTO TREE CAMP OPENING JULY 1, 2024
Camp Classification	Réserve-Collection	Réserve-Collection	Réserve-Collection	Réserve-Collection
Location	Mbirikani Group Ranch	Olare Motorogi Conservancy	Naboisho Conservancy	Maasai Mara National Reserve
Size of concession / reserve	110 000 Hectares / 275 000 Acres	13 300 Hectares / 33 000 Acres	20 000 Hectares / 50 000 Acres	28 000 Hectares / 69 000 Acres
Traversing	Mbirikani Group Ranch	Olare Motorogi Conservancy & Maasai Mara National Reserve	Naboisho Conservancy & Maasai Mara National Reserve	Mara North Conservancy & Maasai Mara National Reserve
Number of Suites / Tents	8 Suites	5 Suites	3 Suites	4 Suites
Family Accommodation	One 2-bedroom suite	The 2-bedroom Jahazi Suite at Mara Plains	The 2-bedroom Sambuk Suite at Mara Nyika. One two-bedroom suite	n/a
Children can be accommodated from:	5 Years	6 Years	6 Years	6 Years
Day Drives	Yes	Yes	Yes	Yes
Night Drives	Yes	Yes	Yes	Yes (water level dependent)
Cultural Experience	Yes	Yes	Yes	Yes
Private Vehicle (at an additional charge)	Yes	Yes	Yes	Yes
Guided Walks	Yes	No	No	No
Horseback Riding	Yes	n/a	n/a	n/a
Hot-Air Ballooning (at an additional charge)	n/a	Yes	Yes	Yes
Mountain Biking	Yes	n/a	n/a	n/a
Hide	Yes	n/a	n/a	n/a
Main Swimming Pool / Private Plunge Pools	Yes (Main Pool & Private Plunge Pools)	Yes (Jahazi Suite only)	n/a	n/a
Shower	Indoor & Outdoor	Indoor	Indoor	Indoor
Bath	Yes	Yes	Yes	Yes
Hairdryers (low voltage)	Yes	Yes	Yes	Yes
Mosquito Nets	Yes	Yes (On all tent sides)	Yes (On all tent sides)	Yes (On all tent sides)
Fans	Standing fan	Overhead fan	Standing fan	Standing fan
Wi-Fi – in-room (complimentary)	Yes	Yes	Yes	Yes
Safe - In-room	Yes	Yes	Yes	Yes
Spa treatments (at an additional charge)	Yes (In-room only)	Yes	Yes (In-room only)	Yes (In-room only)
Fitness	In-room Equipment	In-room Equipment	In-room Equipment	In-room equipment
Boutique on site	Yes	Yes	Yes	Yes



### KENYA CAMPS

ACTIVITY	MARA EXPEDITION CAMP
Camp Classification	Explorers Collection
Location	Maasai Mara National Reserve
Size of concession / reserve	28 000 Hectares / 69 000 Acres
Traversing	Mara North Conservancy & Maasai Mara National Reserve
Number of Suites / Tents	5 Tents
Family Accommodation	One 2-bedroom family tent
Children can be accommodated from:	6 Years
Day Drives	Yes
Night Drives	Yes (water level dependent)
Cultural Experience	Yes
Private Vehicle (at an additional charge)	Yes
Guided Walks	No
Horseback Riding	n/a
Hot-Air Ballooning (at an additional charge)	Yes
Mountain Biking	n/a
Hide	n/a
Main Swimming Pool / Private Plunge Pools	Main swimming pool
Shower	Indoor
Bath	n/a
Hairdryers (low voltage)	n/a
Mosquito Nets	Yes (On all tent sides)
Fans	Standing fan
Wi-Fi – in-room (complimentary)	Yes
Safe - In-room	Yes
Spa treatments (at an additional charge)	n/a
Fitness	Yoga mats
Boutique on site	n/a