

&BEYOND NGALA SAFARI LODGE

# Lodge rooms



# DISCOVER NGALA PRIVATE GAME RESERVE

&Beyond Ngala Safari Lodge Layout

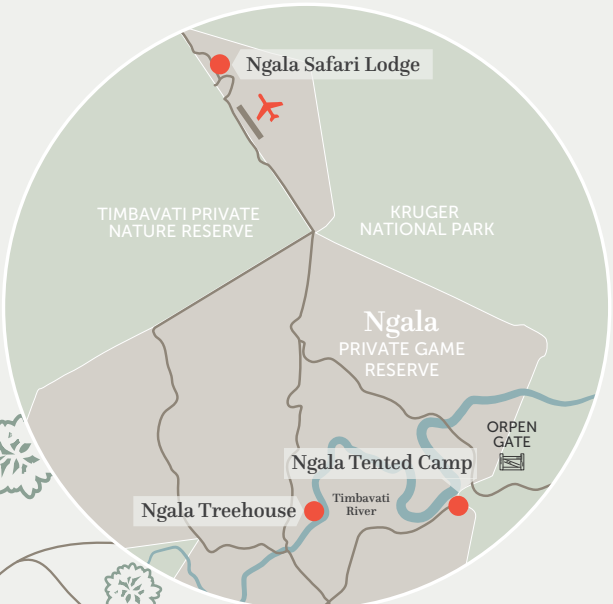
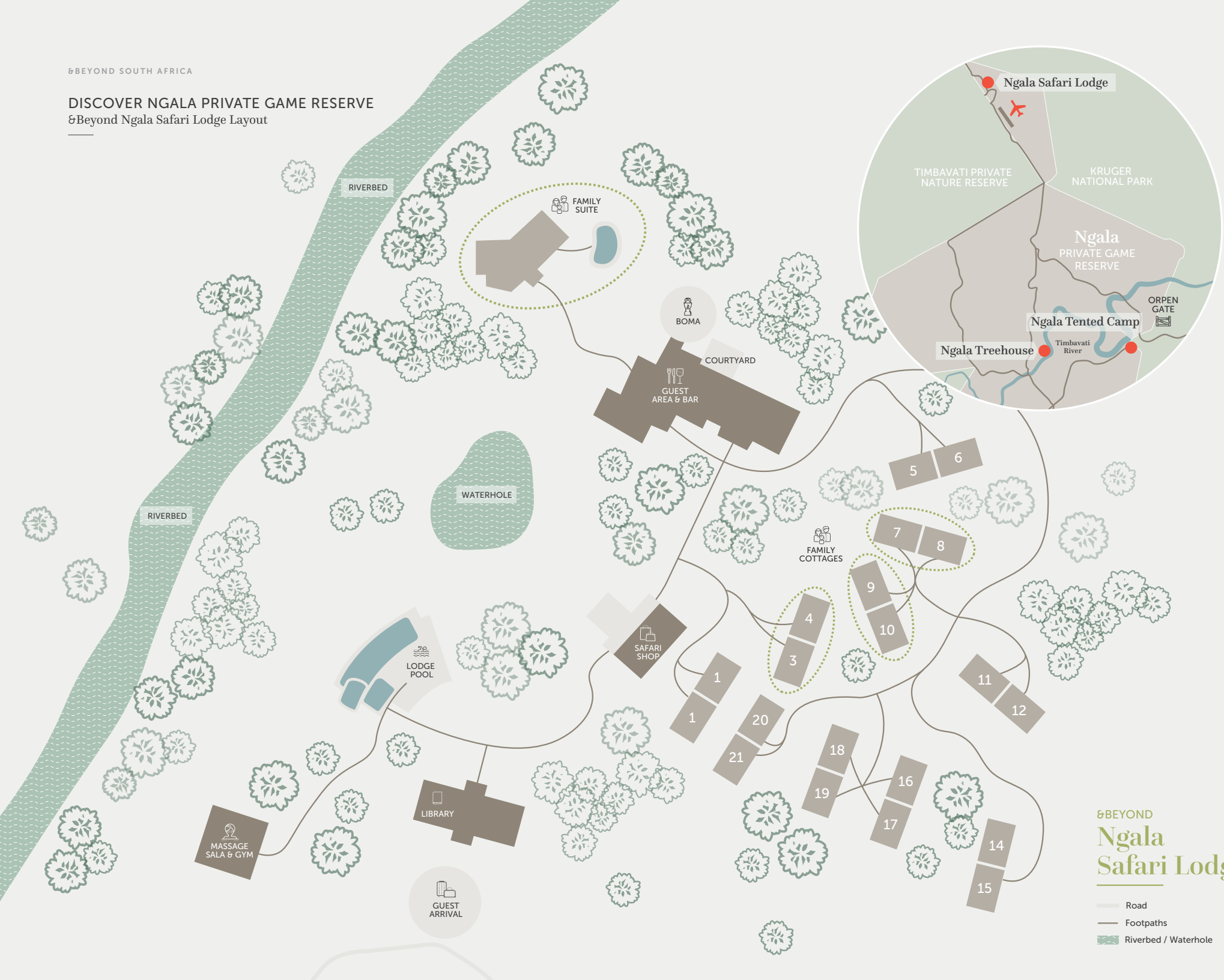

## &BEYOND Ngala Safari Lodge

- Road
- Footpaths
- Riverbed / Waterhole

DISCOVER NGALA PRIVATE GAME RESERVE  
Beyond Ngala Safari Lodge Accommodation

# Sheer safari elegance

The spectacular accommodation options of Ngala Safari Lodge offer a contemporary take on safaris of old; mixing a luxuriously spacious and modern design with evocative accessories.



SPACIOUS FAMILY SUITE INTERIORS



UNWIND ON THE FAMILY SUITE VERANDA



A CLASSIC COTTAGE BATHROOM WITH A VIEW

DISCOVER NGALA PRIVATE GAME RESERVE  
 Beyond Ngala Safari Lodge Accommodation

# COTTAGE

20 Classic Cottages / Max. 2 guests per cottage



**A CLASSIC SAFARI**  
 Beyond Ngala Safari Lodge boasts 20 thatched Classic Cottages, each exuding a romantic colonial ambience with nostalgic safari memorabilia throughout.

Each Cottage boasts a luxurious ensuite bathroom, complete with a bath chamber and both indoor and outdoor showers. Comfortable lounge chairs on private verandas allow for post-safari contemplation or even an afternoon siesta.

## ROOM FACILITIES

Room sizes (Square meters)	48 m <sup>2</sup> (517 f <sup>2</sup> )
Private veranda	Yes, some rooms may overlook walkways
Private plunge pool	No
Personal bar	Yes
Personal coffee station	Yes
Air conditioning / heating	Yes
Overhead fans	Yes
Mosquito nets	No, sealed rooms
Bath	Yes
Shower	Yes, indoor and outdoor
Seperate W.C	Yes
Telephone	Yes
Hairdryer	Yes
Internet access	Yes
In-room safe	Yes
Plug type	220V AC Plug Type C, D, M, N Adapters available
Triple bed option	1 triple room only
Twin bed option	Yes
Double bed option	Yes
Accessibility	Yes, with assistance



Typical cottage layout

DISCOVER NGALA PRIVATE GAME RESERVE  
 Beyond Ngala Safari Lodge Accommodation

# FAMILY COTTAGES

3 Family Cottages / Max. 2 adults & 2 children per Family Cottage



**SAFARI RECONNECTION**  
 Beyond Ngala Safari Lodge boasts three Family Cottages, each consisting of two identical regular cottages that are conveniently interlinked via a door, behind the beds, for easy access. The cottages each have an ensuite bathroom, with a bath, indoor and additional al fresco shower. Beds are convertible to twin. The Family Cottages can accommodate a maximum of two adults and two children.

## ROOM FACILITIES

Room sizes (Square meters)	96 m <sup>2</sup> (1 033 f <sup>2</sup> )
Private veranda	Yes, some rooms may overlook walkways
Private plunge pool	No
Personal bar	Yes
Personal coffee station	Yes
Air conditioning / heating	Yes
Overhead fans	Yes
Mosquito nets	No, sealed room
Bath	Yes
Shower	Yes, indoor and outdoor shower
Seperate W.C	Yes
Telephone	Yes
Hairdryer	Yes
Internet access	Yes
In-room safe	Yes
Plug type	220V AC Plug Type C, D, M, N Adapters available
Triple bed option	No
Twin bed option	Yes
Double bed option	Yes
Accessibility	Yes, with assistance

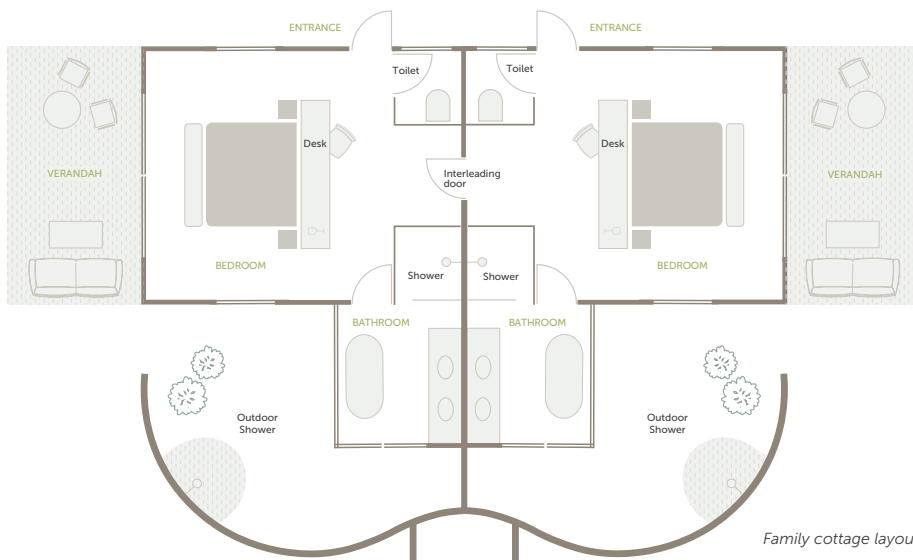

Family cottage layout

DISCOVER NGALA PRIVATE GAME RESERVE  
 &Beyond Ngala Safari Lodge Accommodation

# FAMILY SUITE

1 Family Suite / Max. 2 adults & 2 children (1 adult room & 1 children room)



### RIVERBED VIEWS

The Family Suite at &Beyond Ngala Safari Lodge consists of two ensuite bedrooms, a cosy dining area and a full-sized private swimming pool. It is the only guest suite at the lodge with views of the Maponi riverbed. During your stay, you will have access to a dedicated butler, a ranger and tracker team and a private safari vehicle.

### ROOM FACILITIES

Room sizes (Square meters)	98 m <sup>2</sup> ( 1055 f <sup>2</sup> )
Private veranda	Yes
Private pool	Yes
Personal bar	Yes
Personal coffee station	Yes
Air conditioning / heating	Yes
Overhead fans	Yes
Mosquito nets	No, sealed room
Bath	Yes
Shower	Yes, indoor only
Seperate W.C	Yes
Telephone	Yes
Hairdryer	Yes
Internet access	Yes
In-room safe	Yes
Plug type	220V AC Plug Type C, D, M, N Adapters available
Triple bed option	No
Twin bed option	Yes
Double bed option	Yes
Accessibility	Yes, with assistance

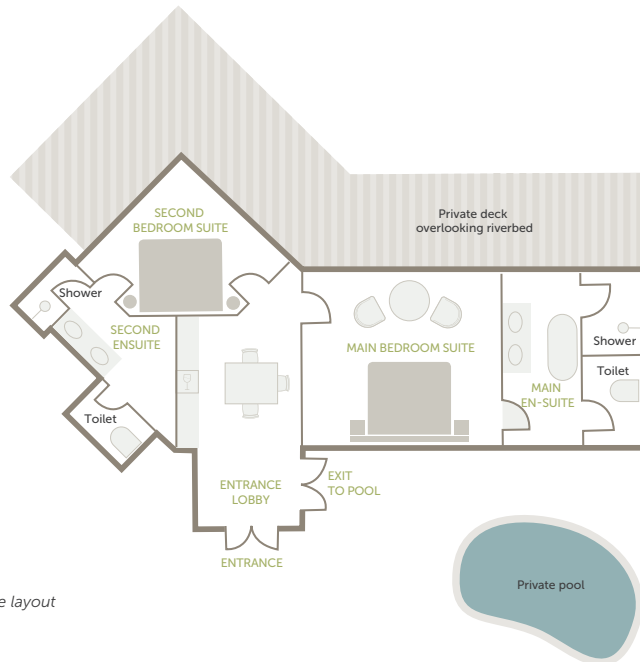

Family suite layout