



THE ROYAL PORTFOLIO

ROYAL MALEWANE

Africa House
FACTSHEET



CONTENTS

| | |
|--------------------------------------|--------|
| WELCOME TO AFRICA HOUSE | 1 |
| ROYAL MALEWANE LODGES AND VILLAS MAP | 2 |
| AFRICA HOUSE VILLA MAP | 3 |
| FLOOR PLAN OF AFRICA HOUSE | 4 |
| BIGGER, BOLDER, BRIGHTER | 6 |
| AFRICA HOUSE GUEST ROOMS | 7 |
| GUEST ROOMS 1 - 6 | 8 - 13 |
| GUIDE / PILOT'S ROOM | 14 |
| COURTYARD | 16 |
| A FAMILY SAFARI | 19 |
| ACTIVITIES | 20 |
| EXCURSIONS | 21 |
| GUIDES AND TRACKERS | 22 |
| WELLNESS | 23 |
| SUSTAINABILITY | 24 |
| GETTING TO AFRICA HOUSE | 25 |
| ROYAL MALEWANE LODGES COMPARISON | 26 |
| CONTACT US | 27 |

WELCOME TO
Africa House

Bigger, bolder and brighter than ever, Africa House has been completely refurbished by Liz Biden as the ultimate expression of her eclectic style. Liz has effortlessly created unique and exciting spaces that bring people together, and help them connect with the magic of the bushveld.

At the heart of the reimagined Africa House, the long room provides a focal point for families and friends to meet, eat, play and relax.

Children of all ages are welcome at Africa House. The 1448m² (15583ft²) villa offers ample space for up to 12 guests. Private services (including a private Chef, Guide, Tracker and up to two safari vehicles) let you determine the shape of each day and night that you spend there.



Royal Malewane Lodges and Villas



Royal Malewane

AFRICA HOUSE

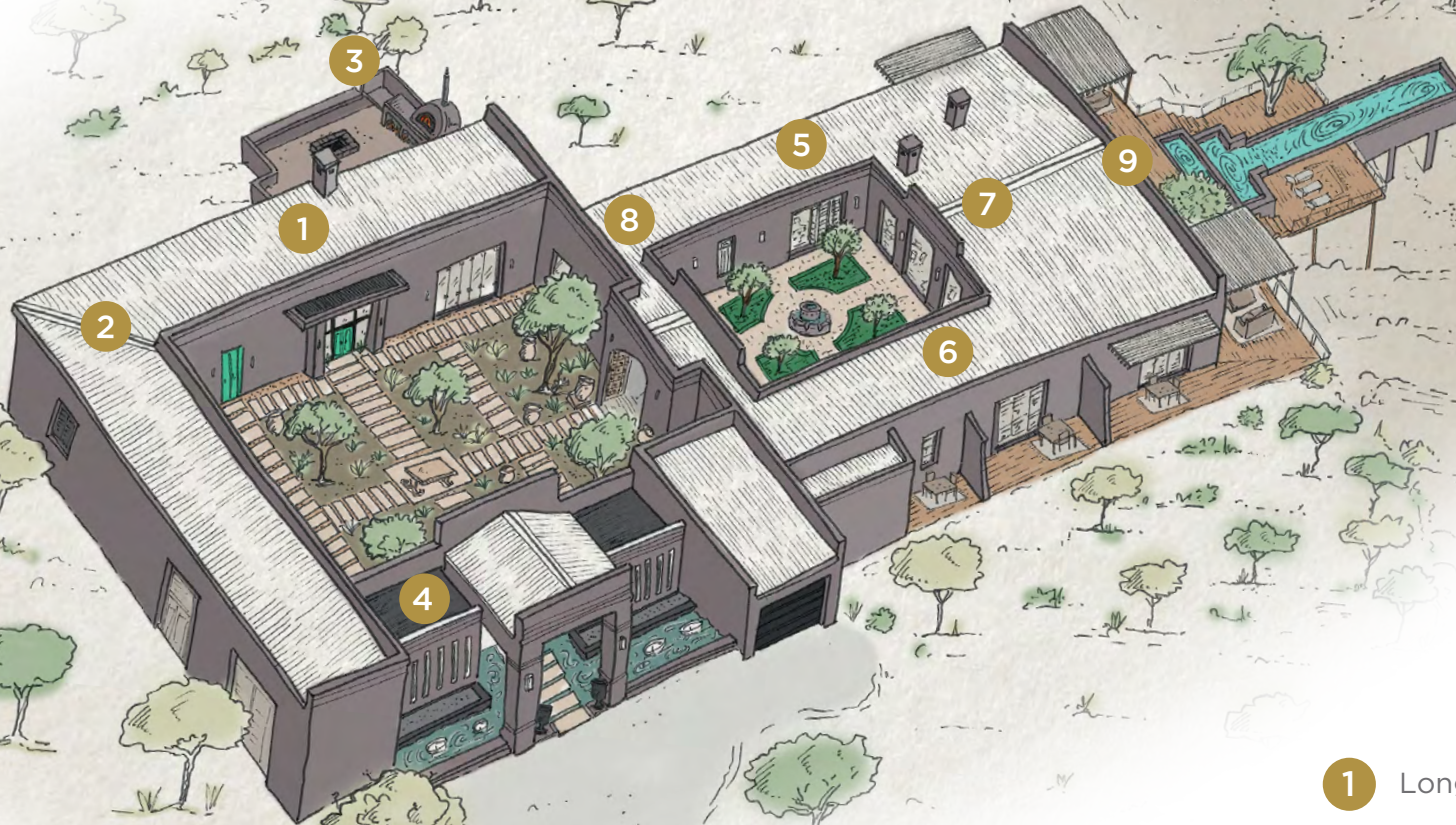
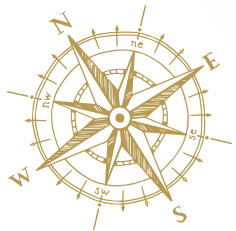

- 1 Long Room
- 2 Gym
- 3 Boma
- 4 Treatment Room
- 5 Bedrooms 1, 3 & 5
- 6 Bedrooms 2, 4 & 6
- 7 Living/Dining Room
- 8 Pilot's Room
- 9 Front Deck

| *Floor Plan of Africa House*





Bigger, Bolder, Brighter

Liz has given free rein to her creative impulses, and combined bold pops of colour with found treasures from her travels. This blend of the antique and the contemporary from every point of the compass could only work under Liz's guidance - and it all comes together wonderfully as an iconic expression of her signature style.

“
This is a place that holds many special memories for me and my family, and I'm excited to offer the magic of Africa House to people who share my passion for spending quality time with loved ones in unique environments.”

LIZ BIDEN





INTRODUCING THE *Africa House Guest Rooms*

Each of the six guest rooms at Africa House has a unique décor scheme, with a dominant colour that gives each room its name.

INTERLEADING ROOMS

Africa House features two sets of interleading rooms. The first set includes rooms 3 and 5, while the second set includes rooms 4 and 6. These interconnecting rooms allow families to stay close together while still enjoying their own private spaces.

Four of the rooms have king size beds (1, 2, 3 and 4), while rooms 5 and 6 each have two twin beds (which can be combined to create king size beds if required).

There is also a seventh room for accompanying private pilots, guides or nannies.

Room 1

THE TURQUOISE ROOM

Inspired by the vibrant hues found in the wings of the magnificent Malachite Kingfisher in full flight. Step into a world where tranquillity meets adventure as you immerse yourself in the calming embrace of this stunning room.

The walls adorned in shades of turquoise create a serene ambience reminiscent of the sparkling waters where the kingfisher reigns.

- En-suite bathroom
- Private deck with outside shower
- Air-conditioning
- A fully stocked maxibar
- TV
- Telephone
- Hairdryer
- International adaptors
- Wi-Fi



Room 2

THE ORANGE ROOM

Glowing incandescently like the vast canvas of the African sky after a magical day on safari, orange is a colour that immediately evokes one of the most magical moments in the bush as the sun sets and the Earth pivots into night.

- En-suite bathroom
- Private deck with outside shower
- Air-conditioning
- A fully stocked maxibar
- TV
- Telephone
- Hairdryer
- International adaptors
- Wi-Fi



Room 3

THE YELLOW ROOM

A room which evokes the golden hour in the bushveld, when every wildlife sighting is somehow more vital and more real.

- En-suite bathroom
- Private deck with outside shower
- Air-conditioning
- A fully stocked maxibar
- TV
- Telephone
- Hairdryer
- International adaptors
- Wi-Fi



Room 4

THE IMPALA LILY PINK ROOM

Impala lilies are a notable feature of the Greater Kruger bushveld, and one of its most distinctive blooms. Their delicate blush has been perfectly captured in the décor and colour scheme of this room, and the result is a sense of peace and contentment.

- En-suite bathroom
- Private deck with outside shower
- Air-conditioning
- A fully stocked maxibar
- TV
- Telephone
- Hairdryer
- International adaptors
- Wi-Fi



Room 5

THE NATURAL GREEN ROOM

In the emerald season - and throughout the year, if you know where to look - the bushveld is a remarkably green environment.

- En-suite bathroom
- Private deck with outside shower
- Air-conditioning
- A fully stocked maxibar
- TV
- Telephone
- Hairdryer
- International adaptors
- Wi-Fi



Room 6

THE BRIGHT GREEN ROOM

The bushveld always retains the ability to surprise - and the vivid colours in this room will do the same. Its ever-changing bright green and red colourways will continuously surprise you, energizing your connection with the world around you.

Each return to this invigorating space promises a fresh burst of inspiration.

- En-suite bathroom
- Private deck with outside shower
- Air-conditioning
- A fully stocked maxibar
- TV
- Telephone
- Hairdryer
- International adaptors
- Wi-Fi



Guide/Pilot's Room

UP WHERE THEY BELONG

The Guide/Pilot's Room provides a restful yet inspiring space for any private staff you may choose to bring with you, whether they are pilots, private guides or nannies.

- En-suite bathroom
- Private deck with outside shower
- Air-conditioning
- A fully stocked maxibar
- TV
- Telephone
- Hairdryer
- International adaptors
- Wi-Fi







Courtyard

MORE SPACE TO DREAM AND DO

The redesign of Africa House has involved the addition of a second, larger atrium which has more than doubled the size of the villa. This expansive, planted area bridges the gap between the beauty of the bush and the luxury of Africa House. Grouped around the new courtyard are the living and wellness spaces of the reimagined villa: the long room, with its dedicated areas for play, dining and living, and the spa treatment room and gym room.

The long room in turn links to the open-air boma, the perfect place to start the day with a cup of fresh coffee, end it with a sundowner, or enjoy a slice of hot, homemade pizza from the al fresco oven any time you like.







| *A Family Safari*

As an exclusive-use private villa, Africa House welcomes kids of all ages. It provides the perfect setting for multigenerational travel and precious family time. Nanny accommodation (in the guide/pilots' room) is also available should you need an extra pair of hands to ensure that everything goes smoothly.

WHY KIDS LOVE AFRICA HOUSE

- Friendly staff who genuinely enjoy spending time with younger guests
- Child-friendly game drives
- Pool table and games
- The long room where they can spend time with family and friends
- An amazing pool overlooking a dry river bed where animals pass by
- The Royal Rangers programme specifically designed for children to learn bush skills, such as tracking, birdwatching, and even some words in the local language, Shangaan

Going on safari has never been this much fun!

Activities

Activities at Africa House naturally focus on discovering the wonders of the surrounding bushveld, but the options extend beyond conventional (yet always wonderful) game drives.

- Daily game drives
- Soothing wellness treatments at the spa
- Photographic safaris
- Lazy days by the pool
- Guided bush walks
- Fitness room
- World-class dining experience
- Visits to Royal Malewane's Conservation and Research Centre

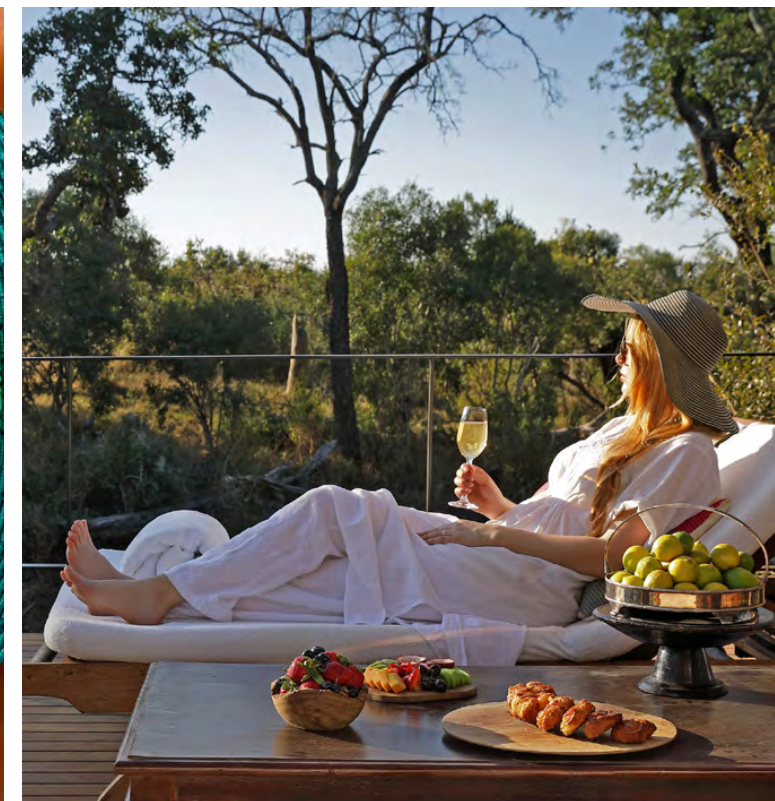

Excursions

If you want to venture further afield, our Reservations team can arrange the following activities at an additional charge:

- Helicopter flights over the Blyde River Canyon, the world's deepest green canyon
- Golf at Africa's most exclusive bushveld golf course - Leopard Creek
- Blyde River Canyon cruise
- A visit to the Timbavati Museum
- A visit to the Mololoholo Wildlife Rehabilitation Centre



The Most Qualified Guiding Team

IN SOUTH AFRICA

Royal Malewane is often referred to as the 'Harvard of the Bush'. That's because of the guiding team's unyielding passion for learning and their ambition not just to be the best, but to raise the standards of the industry as a whole. All the Guides at Royal Malewane hold the highest professional Field Guides Association of Southern Africa (FGASA) qualifications, as well as advanced rifle handling certificates.

These qualifications ensure that our guests enjoy an exceptional game viewing experience – not only while on game drive, but also on foot during guided bush walks. At the pinnacle of the professional guiding qualifications are the Special Knowledge & Skills (SKS) Qualifications such as Dangerous Game and Birding. Very few guides in Africa achieve these qualifications which require extensive knowledge as well as technical skills - the team at Royal Malewane have these attributes in abundance.

Our guiding team has over 300 years of African bush experience between them, and Royal Malewane is proud to have three of only seven living Master Trackers in the world and the only three working in the Greater Kruger Park region.



AFRICA HOUSE *Wellness*

Spending time in the African bushveld is undoubtedly good for your soul, and you can also use your time at Africa House to top up your wellness reserves.

Our experienced therapists offer a wide range of treatments, many of them drawing on traditional herbal medicine.

Choose from treatments designed to help you relax, rejuvenate or revitalise. Shed the stress of your journey to South Africa, fight fatigue and achieve inner peace with hands-on therapies that focus on different parts of your body.

Treatments can be enjoyed in the double treatment room at Africa House, in the privacy of your room or at the award-winning Royal Waters Spa at Malewane Lodge.



Sustainability

At The Royal Portfolio, sustainability is at the heart of everything we do – including at Africa House.

COMMUNITY

- We support community development to grow and uplift our team.
- We're committed to improving crèche facilities in nearby villages.
- Africa House guests have the chance to visit the local crèches we support.

ENVIRONMENT

- We're reducing the amount of water we use.
- We're limiting our carbon footprint by choosing energy-efficient devices.
- We're phasing out plastic water bottles in favour of reusable glass bottles.

CONSERVATION

- Thornybush's K9 anti-poaching dog unit is making the Great Kruger area safer for wildlife.
- The new Conservation & Research Centre (CRC) is providing researchers with facilities and a hub to share ideas.

HYDRONIC HEATING AND COOLING WATER SYSTEM

We've invested in an innovative, integrated heating system that uses solar energy and hydronics to heat water, pools, towel racks and underfloor heating, and run the air conditioning.

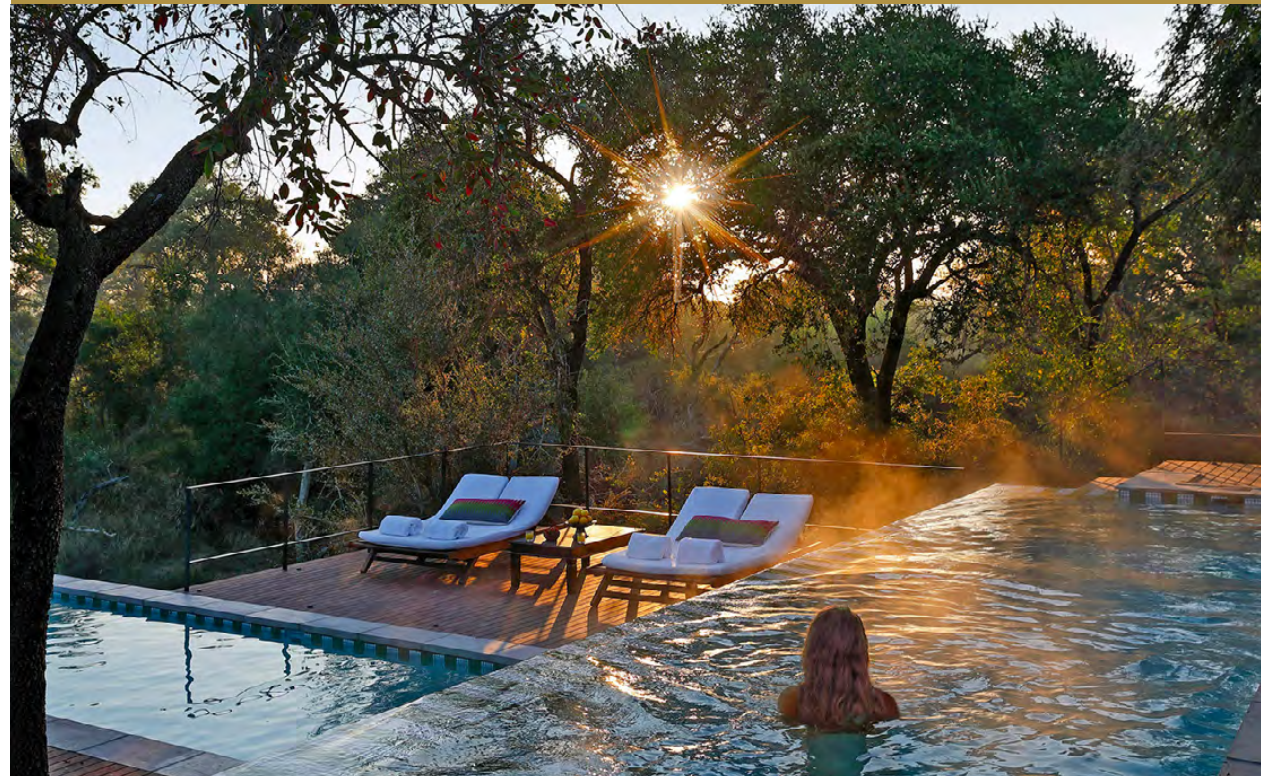



GETTING TO *Africa House*

TRAVEL BY AIR

From Johannesburg International Airport:

SA Airlink and CemAir fly daily to Hoedspruit Airport (HDS). Bookings can be made directly online.

Road transfers can be arranged by Royal Malewane and take approximately 35 minutes in a comfortable air-conditioned vehicle.

From Cape Town International Airport:

SA Airlink and CemAir fly daily to Hoedspruit Airport (HDS). Bookings can be made directly online.

Chartered Flights:

You can also charter your own flight directly to our private airstrip. Our Reservations Team can assist with domestic flights and private charters and road transfers.

AIRLINE DETAILS

CemAir:

www.flycemair.co.za/

+27 86 123 6247

SA Airlink:

www.flyairlink.com/en/za/

+27 11 451 7300

Royal Malewane Lodges Comparison

MALEWANE

A classic and traditional bush style lodge, brimming with old world elegance and timeless luxury. This is the original Biden Family homestead.

- Sleeps 20 guests across six Luxury Suites and two Royal Suites
- Luxury Suites welcome children over 10 years old
- Royal Suites welcome children of all ages and offers private services
- All suites enjoy direct access to Malewane's reception, dining areas, library, spa and gym via illuminated pathways
- Guide's room available
- Masiya bar and Wine Cellar
- The Waters of Royal Malewane Bush Spa

FARMSTEAD

A fresh, contemporary style Farmstead with sweeping vistas over the bushveld. A more intimate and private space that is both stylish and comfortable.

- Sleeps 6 guests across three Luxury Farm Suites
- All suites enjoy direct access to Farmstead's reception, dining area, spa, gym and Farmhouse via illuminated walkways
- Guide's room available
- Children over 10 years old are welcome
- Communal bar
- Treatment Room

WATERSIDE

A new modern luxury safari lodge that combines thatch, glass and steel. This spacious sanctuary brings a splash of colour to Royal Malewane.

- Sleeps 16 guests across four Luxury Suites, two Aloe Rooms and one Baobab Suite
- Children of all ages are welcome
- All suites enjoy direct access to Waterside's reception, dining areas, library, spa, fitness center and yoga room via illuminated pathways
- Guide's room available
- Outdoor bar
- Wine cellar
- Reflections Spa

Private Villa Options

AFRICA HOUSE

- Sleeps up to 12 guests
- A two-minute drive away from Malewane
- Private services include a private chef, and up to two private game vehicles
- Children of all ages are welcome

THE FARMHOUSE

- Sleeps 6 adults and 2 children
- Private services include a private chef and one private game vehicle
- Direct access to Farmstead and its facilities via illuminated pathways
- Children of all ages are welcome

WATERSIDE HOUSE

- Sleeps up to 8 guests
- Private services will be included in the rate from 1 March 2024
- All suites enjoy direct access to Waterside's reception, dining areas, library, spa, fitness center and yoga room
- Private Guide, tracker and own vehicle
- Children of all ages are welcome



THE ROYAL PORTFOLIO

HEAD OFFICE

Tel: +27 21 671 7068

Email: headoffice@trp.travel

RESERVATIONS

Tel: +27 21 671 5502

Email: reservations@trp.travel

ADDRESS

Suite 101 Intaba, 25 Protea
Road, Claremont, 7708,
South Africa

www.theroyalportfolio.com



THE SILO HOTEL



LA RESIDENCE



BIRKENHEAD HOUSE



PRIVATE RESIDENCES