

XUGANA ISLAND LODGE

Xugana Lagoon, Okavango Delta



Empowering Botswana Through Tourism



www.desertdelta.com

CAMP OKAVANGO | NXAMASERI ISLAND LODGE | XUGANA ISLAND LODGE | CAMP MOREMI | CAMP XAKANAXA
CHOBE GAME LODGE | SAVUTE SAFARI LODGE | CHOBE SAVANNA LODGE | LEROO LA TAU

MAY 2022

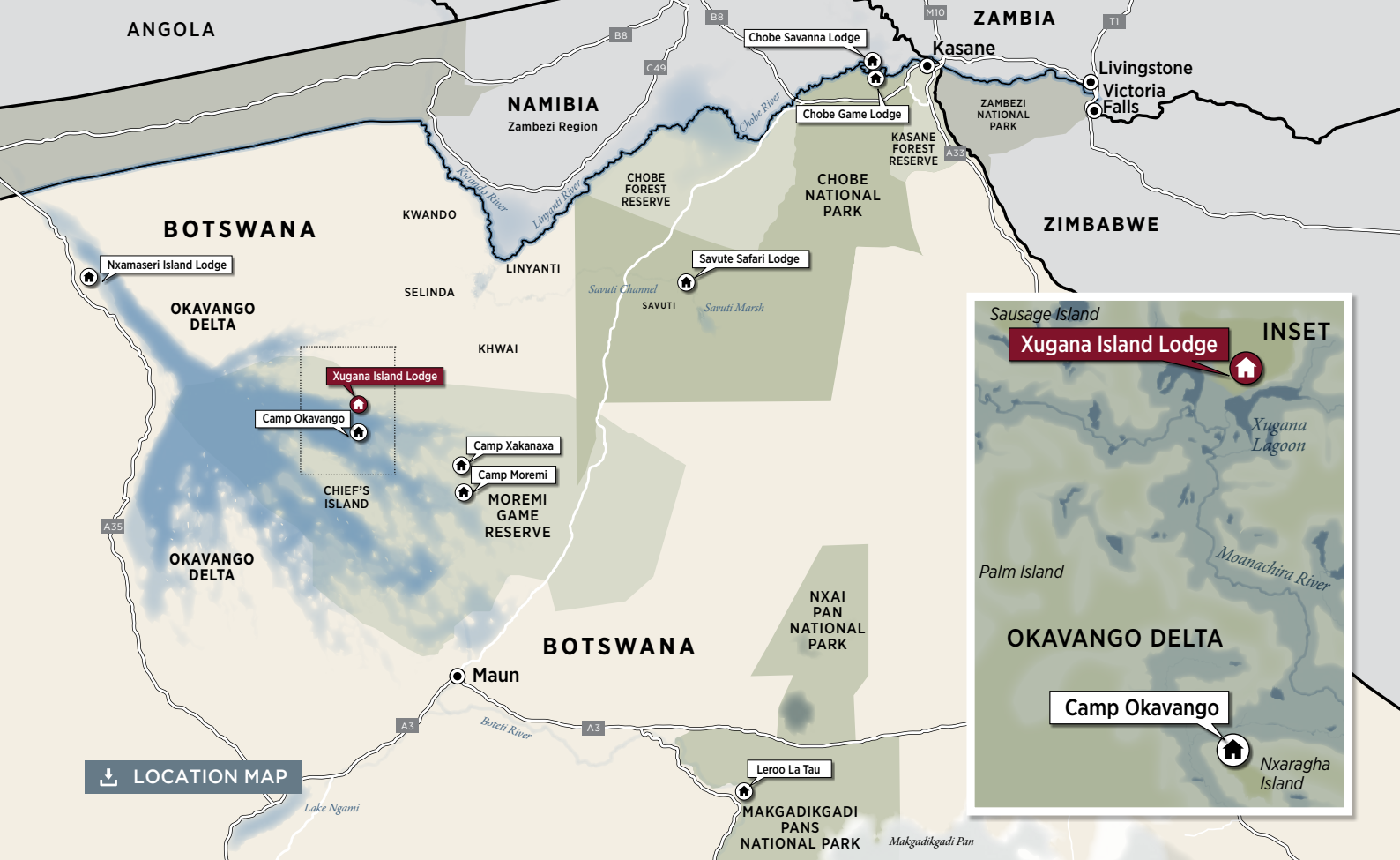

Xugana Lagoon is widely recognised as the most spectacular permanent water site in the entire Okavango Delta, which itself is Africa's largest and most awe-inspiring oasis. Owing to its remote delta location, Xugana Island Lodge is a year round water paradise offering guests the chance to experience the beauty of the Okavango Delta with its myriad of deep waterways, open floodplains and diverse wildlife inhabitants.



[CAMP LAYOUT](#)



THE CAMP

FACILITIES

ROOMS	8 Twin bedded reed chalets accommodating a maximum of 16 guests.
PILOT/GUIDE	1 x Pilot/Guide chalet (not the same standard as guest rooms).
RATES	Fully inclusive of all meals, scheduled safari activities, local drinks (including alcoholic drinks, excluding premium brands) and park entrance fees.
DINING	Various indoor and outdoor dining locations, including a floating deck (weather permitting).
CAMP FIRE	Located in the main area of the camp with magical views over the lagoon.
SWIMMING POOL	Set within the established gardens in the centre of the island - the perfect place to relax.
VIEWING DECK	Marvel at spectacular sunsets from the lagoon-side viewing deck.
BAR	Fully stocked bar.
CURIO SHOP	Accepts cash and credit card payments.
LAUNDRY	Daily, inclusive laundry service available.
WATER	Reverse osmosis water treatment plant supplies drinking water (bottled water on request).
ELECTRICITY	Operates on AC 220V generator power during the day and evening. The generator is switched off at night and inverted 12-volt DC lighting provides room and bathroom illumination overnight. 220V AC plug's are available in guest rooms.
WI-FI	Connection to Wi-Fi is available in the rooms only. Wi-Fi is via remote satellite link up and constant connectivity is not guaranteed.
TELEPHONE	No telephone communication available. The lodge has a satellite phone and radio for emergencies.
CHILDREN	Children from 6 years and older. See Desert & Delta Safaris child policy for more information.



CAMP IMAGES





ACCOMMODATION



The lodge accommodates only 16 guests in large, raised, reed and thatch lagoon-facing chalets, with en-suite facilities and private viewing decks optimally placed on the shaded fringe of the island.

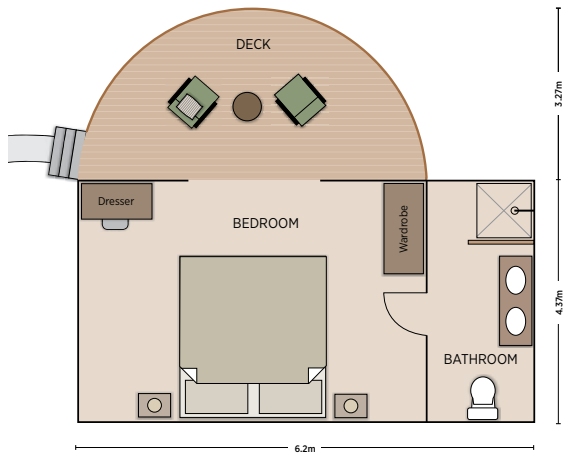

[CAMP IMAGES](#) [PLANS](#)





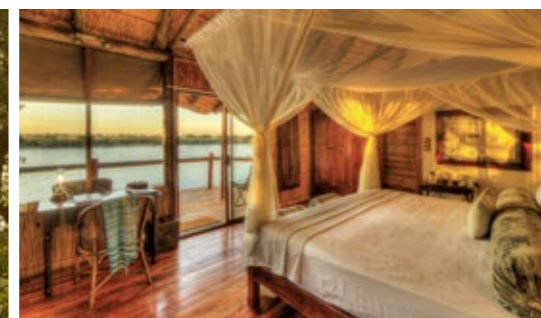
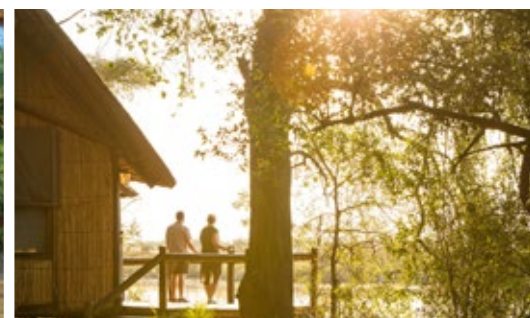

ROOM FACILITIES

RAISED DECKS	Each chalet is set on a raised teak deck.
PRIVATE VIEWING DECK	Lagoon facing decks on the fringe of the island.
EN-SUITE BATHROOM	En-suite showers, hand basin and toilet facilities.
FANS	Fans are available in all rooms - there is no air-conditioning in the rooms.
POWER	220V multi adaptor plugs are available for charging photographic equipment.
SAFE	A small pass-code protected safe for storing valuables.
FLASHLIGHT	For use in the rooms at night.
UMBRELLA	In case of rain.
AIR HORN	For use in case of an emergency.
HAIRDRYER	A small hairdryer is available in each room.
BATHROOM AMENITIES	A range of bathroom amenities including bio-degradable soaps, shower gels etc.
TEA & COFFEE FACILITIES	A small kettle with tea and coffee available.





ACTIVITIES

	MOTORISED BOAT SAFARIS	Guided excursions through the deeper channels and lagoons of the Okavango Delta in hard-bottom aluminum boats. The boats are equipped with comfortable seats, a foldaway canvas roof and life jackets.
	MOKORO (CANOE) EXCURSIONS	Guided mokoro excursions in traditional dug out canoes. Guests experience the shallower channels and floodplains of the Okavango Delta.
	GUIDED BUSH WALKS	Bush walks on the surrounding islands offer the opportunity to track the larger species that inhabit the water wilderness. Guided walks are conducted in small groups with two guides.
	FISHING	Optional fishing excursions to fish for bream (seasonal). All fishing equipment is available at the lodge.
	BIRD WATCHING	Birding is absolutely spectacular, especially during the summer months when the migrant birds come to breed.
	HELICOPTER FLIGHTS <i>(Optional Extra, surcharges apply)</i>	Scenic helicopter flights over the Okavango Delta are available at an additional charge.

EXPERIENCE IMAGES



TYPICAL DAY ON SAFARI

Please note the below suggested daily program is flexible based on the guests interests, travel times and availability of activities.

WINTER TIMES	SUMMER TIMES	ACTIVITY
05:30	05:00	Early morning wake-up call.
06:00	05:30	Light continental breakfast served in the dining area.
06:30	06:00	Leave for morning activity, (approximately 3 - 4 hours).
11:30	11:00	Brunch is served at the dining area.
SIESTA TIME		Relax and enjoy the lodge facilities and surroundings.
15:00	15:30	Afternoon tea is served on the open air patio.
15:30	16:00	Depart for afternoon activity (approximately 3 hours).
18:30	19:00	Arrive back at the lodge.
19:30	20:00	Dinner is served at the dining area.





ACCESS TO XUGANA ISLAND LODGE

Xugana Island Lodge is accessed by light aircraft. Upon arrival at the airstrip there is a boat transfer of approximately 20 minutes from the airstrip to the camp. The Xugana airstrip is privately owned by Desert & Delta Safaris, a Chobe Holdings Company. Flights to and from Xugana Island Lodge are scheduled based on the travellers itinerary.

AIRSTRIP DETAILS

STRIP GPS CO-ORDINATES	S19° 03' 00.00 E023° 05' 18.0
LENGTH	1020m
LICENSE	CAAB Licensed Class B airstrip accommodating aircrafts up to MAUW 5700kg's (Cessna Caravan).
PRIVATE CHARTERS	Prior consent from Desert & Delta Safaris is required before landing private aircraft on the airstrip.



Maun

ESTIMATED FLIGHT TIMES Between Camps & Airports

25	Camp Okavango					
30	5	Xugana Island Lodge				
20	10	10	Camp Moremi / Camp Xakanaxa			
40	30	25	25	Savute Safari Lodge		
30	45	45	40	50	Leroo La Tau	
70	60	60	55	30	65	Kasane

PLEASE NOTE: Drone use is strictly prohibited at Xugana Island Lodge due to the sensitive nature of the environment in which it operates.

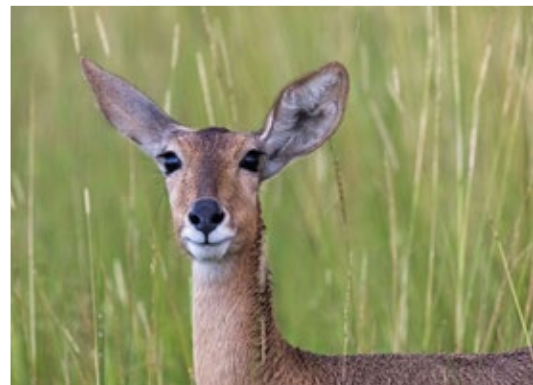

Empowering Botswana Through Tourism

[f](https://www.facebook.com/desertdelta) [t](https://twitter.com/desertdelta) [i](https://www.instagram.com/desertdelta) [y](https://www.youtube.com/desertdelta) www.desertdelta.com

RESERVATIONS OFFICE

TELEPHONE [+267] 680 1494
E-MAIL info@desertdelta.com

MARKETING OFFICE

TELEPHONE [+267] 686 1559
E-MAIL marketing@desertdelta.com
ADDRESS Private Bag 310,
Maun, Botswana

[View Desert & Delta Safaris Video](#)