



FACT FILE ZARAF A CAMP NORTHERN BOTSWANA

Zarafa Camp is an intimate, four room exquisite tented camp located on the 320,000 acre Selinda Reserve in northern Botswana, an area linking the Okavango Delta and the Chobe/Savute corridors. Few camps rival the location of this little gem, Botswana's first and only Relais & Chateaux property. Overlooking the crystal waters of Zibadianja Lagoon, the source of the famous Savute Channel, every area of camp has a magnificent view. The lagoon is also the water source for a tremendous population of wildlife – dry season sightings boast buffalo and elephant by the hundreds.

Zarafa Camp is the brainchild of the founders of Great Plains Conservation, who pooled their collective experience on safari to create what they deemed to be the best and most environmentally innovative camp. As a consequence, Zarafa may in fact be the "greenest" luxury safari camp on the continent. Only recycled hardwoods and canvas were used in the construction and all the camp's electricity comes from its solar farm while 'bio gas' plants recycle waste into usable cooking gas.

The guest tents, 1000 sq. ft in extent, are under beige, flowing canvas, with canopy ceilings and completely open (yet netted) sides. Entering through the heavy wood Lamu door transports guests to a lavish space of deep reds, browns, brass and copper, evoking richness and beauty. Each tent has a full lounge with desk and gas fireplace for winter. The large bedroom is connected to an open layout bathroom with impressive copper claw foot bath, indoor shower, separate loo and double basins.



 NATIONAL GEOGRAPHIC

UNIQUE LODGES
OF THE WORLD™



ZARAFSA CAMP NORTHERN BOTSWANA

Decking around the tent leads to the private plunge pool and full-body outdoor shower, all with views of pristine Botswana wilderness. Under an impressive canopy of African ebony trees, the camp has a sizable main lounge, with adjacent library and dining area. A curio shop satiates those who need retail therapy. In-room massage is also available. Zarafa has succeeded in successfully retaining a clearly African feel, while balancing that delicate relationship between personal and informal and romance and adventure. Zarafa Camp has no equal in terms of its environmental credentials and its careful appointments.

Selinda Reserve, at the crossroads of some of northern Botswana's most prolific wildlife areas, boasts staggering wildlife populations year-round. Home to some of the classic species, such as leopard, lion, elephant, buffalo, Red lechwe, zebra and giraffe, it is also a refuge for some of the more uncommon species such as African wild dog (which usually den each dry season near camp), cheetah, roan and sable. And for birders, it will not disappoint. Our nearby African skimmer colony is a highlight, as are the antics of the Black egret on the shores of Zibadianja Lagoon. From camp, hippos are visible in the Lagoon and elephant wander through regularly. Night noises will either lull you to sleep or wake you from a deep slumber. It is an exciting area, and guests are in the heart of a wilderness wonderland.



ZARAFSA CAMP NORTHERN BOTSWANA

ACTIVITIES

With a maximum of just eight guests, Zarafa Camp offers complete flexibility. Drives do focus on the most comfortable and productive times of day, early morning and late afternoon, but full day drives are also quite common at a guest's request. Picnic brunch can be delivered, and the vehicles are stocked with cold drinks. The camp has two custom built Land Cruisers specially designed for our conditions and photography (fold-down screens, raised roofs, photographic bars, multi-plug invertors) with seven individual bucket seats.

The HES Zib, Zarafa's special pontoon boat, is an utterly unique experience. The 275 sq. foot deck is complete with couches, a dining area and bar where guests can comfortably enjoy floating brunch or sundowners while watching hippos and elephants in the water. It is also an exceptional platform for birding. Fly-fishing and rod/reel kit is available for those who want to try their cast at the local bream. Walks can also be arranged and are led by licensed guides with firearm training. Power boating on the channels is available, water level dependent.

PHOTOGRAPHY

Each of Zarafa's guest tents has a professional Canon camera set, including a Canon 5D camera body and Canon 100-400mm and 28-135mm lenses. Photos will be downloaded to a USB flash stick on guest's departure. Each tent comes with a pair of Swarovski binoculars for guest use as well.

Telephone:	+27 (0) 87 354 6591
Facsimile:	+27 (0) 21 701 1073
After Hours Emergency:	+27 (0) 79 284 5945
Email:	res.manager@greatplainsconservation.com
Website:	www.greatplainsconservation.com
Total Number of Bedrooms:	4 double or twin configuration tents & 1 guide room.
Type of Lodge:	Safari Camp
Lodge Season & Opening:	Year Round
Ideal length of stay:	4 Nights

ZARAFa CAMP

NORTHERN BOTSWANA

GEOGRAPHY

ACCESS DIRECTIONS

- Light aircraft transfers from Kasane (50 mins) and Maun (45 min) airports;
- Private Air charter access available;
- Zarafa Camp is a 45-minute drive from its airstrip;
- Co-ordinates: S18 35' 22.86" : E23 30' 51.28"

TENT DETAILS

BEDROOM

- 1000 sq. foot Marquee style tents of canopied beige canvas on raised wood decks of 100-year-old teak railroad ties;
- Private decking leading to a private plunge pool;
- Lounge has couch and two chairs, plus desk and small library;
- Trunks house the binoculars and camera kit as well as an engel fridge with drinks of choice;
- Gas fireplace is between the bedroom and bath;
- Either twin or double bed configuration;
- Honeymoon tent is Tent 1. Closest to main area is Tent 2.

BATHROOM

- En-suite from the bedroom, there is a open-air concept bathroom with indoor shower, claw foot deep copper tub and double vanities;
- Separate flush loo room;
- Outdoor 'full-body' shower;
- Hot and cold running water;
- Soap, shampoo, conditioner and lotion and hairdryers provided.

CONSTRUCTION

- Elaborate canvas tent on raised wood decking.

TEMPERATURE CONTROL

- Ceiling fans, and unique bed cooling system for summer;
- Gas fireplace for winter;
- All the canvas is double-sided so that the rooms remain cool in summer and warm in winter.

MOSQUITO NETS

- Fly netting on all tent sides and over beds as well as ultrasound repellent device.

FOOD & DRINK

- All meals included;
- All drinks and beverages are included with the exception of imported champagnes and spirits;
- World-class (Relais & Chateaux recognised) Three delicious meals a day are provided. We are extremely flexible on timings. Picnic breakfasts or lunch (or both) are the norm due to very active game drives, often delivered to the bush!
- All dietary requirements are catered for from regular to vegan to children, prior warning requested.

USUAL BOARD BASIS

- Full board.

DINING STYLE

- Group meals and/or individual tables, a la carte (menu options).

DINING LOCATIONS

- Indoor and outdoor.



ZARAFANA CAMP NORTHERN BOTSWANA

ROOM SERVICE

- On request, for special occasions.

EXTRAS

LAUNDRY

- Included in nightly tariff - next day service, weather permitting.

CENTRAL FACILITIES/ COMMON AREAS

- Central Lounge with library;
- Dining room with small bar;
- Basic "jungle" gym;
- Large curio shop;
- Coffee/tea station;
- Expansive deck with fire pit & seating.

SHOP/BOUTIQUE

- Selling locally and regionally produced crafts, many of which support local community projects in the nearby Okavango panhandle.

SPA/GYM

- Yoga mats, weights and bands are provided in each suite;
- Spin bikes are available for use on your private deck;
- In-room massage is available at additional cost.

EQUIPMENT

Each guest tent has the following for guest use during their stay:

- Canon 5D camera body with 28-135mm and 100-400mm lenses;
- Swarovski 8 x 42 binoculars.

PRIVATE VEHICLE

- Available at additional cost, based on availability.

CHILDREN

- We look forward to having children stay with us that are 8 years and older;
- Families with children 8-11 could be accommodated in the same vehicle as other guests;
- Children under 8 will be considered, if the group books the entire camp on exclusive use;
- Young children must be supervised as the camp is open with high predator densities in and around camp and there is water surrounding camp;
- Children must be a minimum of 12 years old to participate in extensive walking activities (Young Explorers program excepted);
- Young Explorers program – thoughtfully designed to explore a range of experiences and topics from birding to cooking to art to tracking wildlife.

POWER & COMMUNICATIONS SOURCE

- The camp is run by an impressive solar farm of 170 panels;
- This system produces 220V, 24-hour electricity to the tents and main area;
- Universal plug points in each tent.

INTERNET & MOBILE

- Wi-fi available in guest tents;
- No mobile signal.

ZARAFI CAMP

NORTHERN BOTSWANA

HEALTH & SAFETY

MALARIA

- Minimal exposure – Malaria prophylaxis are recommended if guests are concerned; however, this is a remote area with little occurrence.

MEDICAL CARE

- Guests must hold comprehensive medical insurance and emergency evacuation insurance;
- Senior staff all has first aid training;
- Nearest decent medical facility is in Maun, and then Johannesburg.

RISK OF DANGEROUS ANIMALS

- Moderate due to high predator density area.

SECURITY MEASURES

- None. There are no populations nearby, and no uninvited guests.

FIRE SAFETY

- Fire extinguishers in every tent.

POSSIBILITY OF DISABLED ACCESS

- The camp layout is not conducive to wheelchair bound guests due to dirt pathways and uneven terrain;
- For the walking impaired, Tent 2 is in close proximity to the main area with minimal steps.

MONEY MATTERS

SAFES

- Provided in every room.

ACCEPTED PAYMENT ON LOCATION

- All-inclusive. Staff gratuities can be paid in Botswana Pula, South African Rands, US Dollars (2004 bills or later only) or GB Pounds;
- Visa and MasterCard credit cards are accepted (No Amex or Diners).

THE TEAM

LODGE OWNERS

Great Plains Conservation.



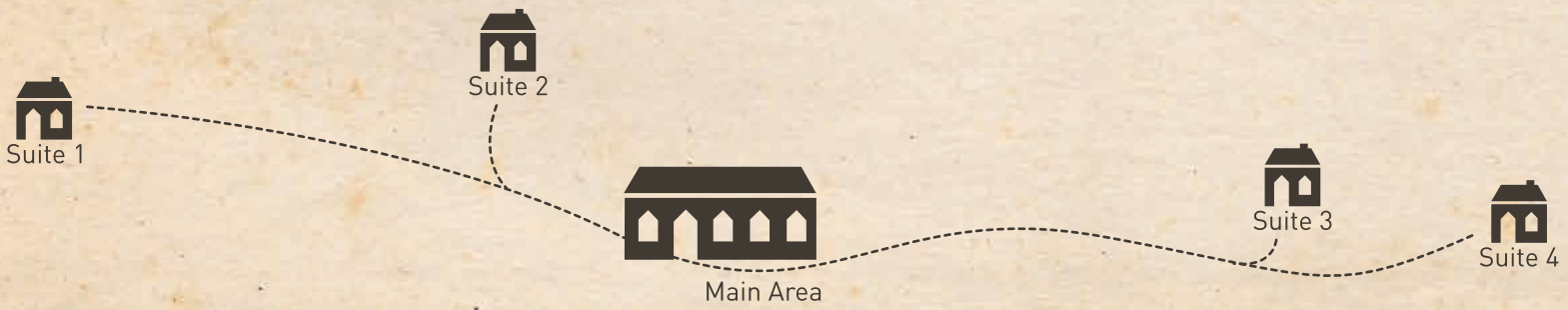
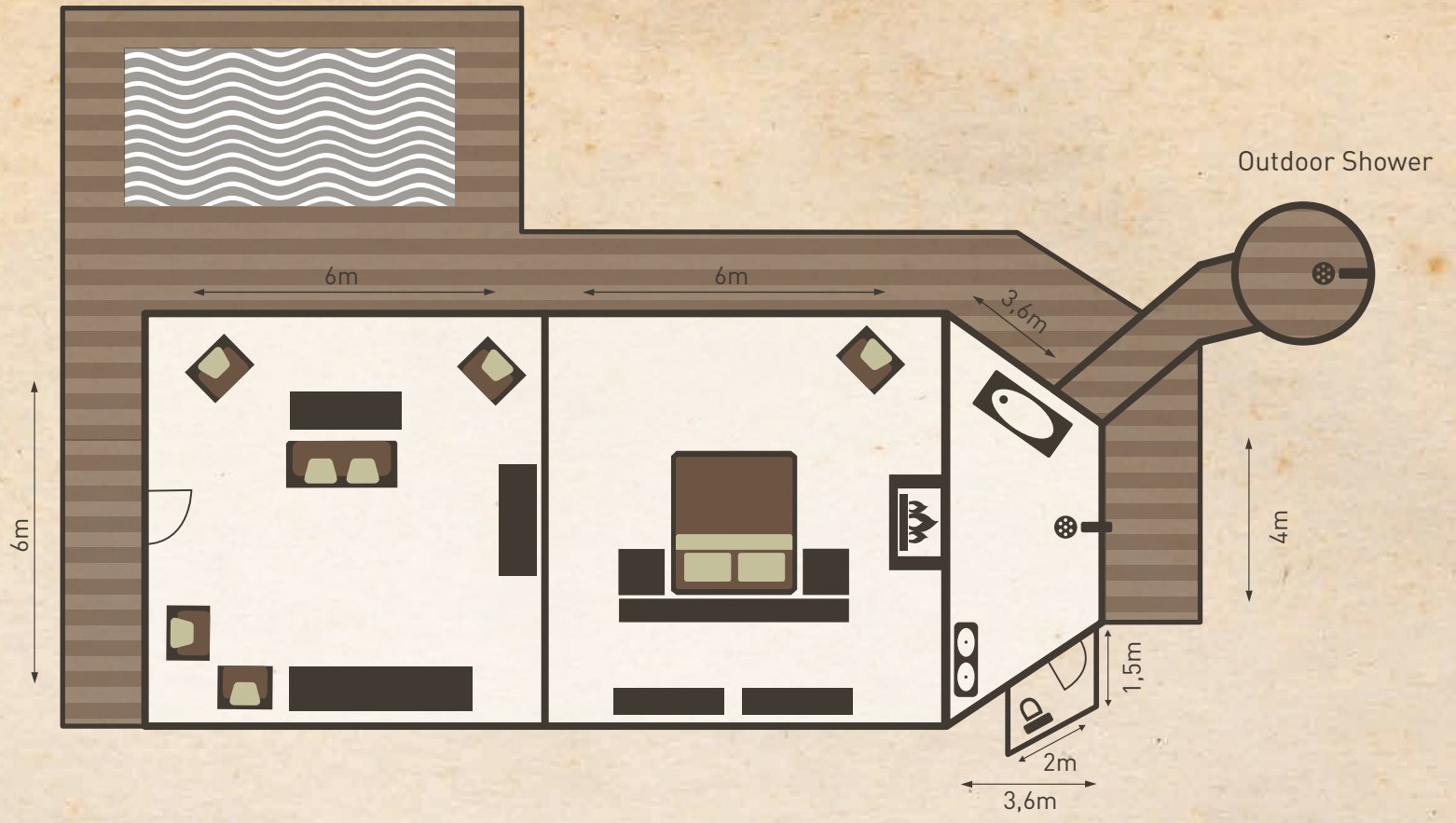

GREAT PLAINS CONSERVATION

QUICK CAMP FACTS

	BOTSWANA CAMPS						KENYA CAMPS		
ACTIVITY	ZARAFA CAMP	ZARAFA DHOW SUITES	SELINDA CAMP	DUBA EXPEDITION	SELINDA EXPLORERS	SELINDA ADVENTURE TRAIL	OL DONYO LODGE	MARA PLAINS	MARA EXPEDITION
Day Drives	•	•	•	•	•		•	•	•
Night Drives	•	•	•	•	•		•	•	•
Guided Walks	•	•	•	•	•	•	•		
Boating #	•	•	•	•					
Mokoro #									
Canoeing #					•	•			
Main Swimming Pool		•	•				•		
Private Plunge Pools	•						•		
Horseback Riding							•		
Cultural Interaction *							•	•	•
Hot-Air Ballooning *								•	•
Spa/Massage *	•	•	•				•		
Gym	•	•							
Fishing (Seasonal)	•	•	•	•	•				
Mountain Biking							•		
Hide			•				•		

(*) This activity is available for an additional fee | (#) This activity is water level dependent

