



## FACT FILE ZARAFSA DHOW SUITES NORTHERN BOTSWANA



The Zarafa Dhow Suites is an intimate, two room exquisite tented villa located on the 320,000 acre Selinda Reserve in northern Botswana, an area linking the Okavango Delta and the Chobe/Savute corridors. Few properties rival the location of this little gem built entirely under canvas, as one of the largest tents ever built on the continent. The Suites are located adjacent to Zarafa Camp, Botswana's first and only Relais & Chateaux property. Overlooking the crystal waters of Zibadianja Lagoon, the source of the famous Savute Channel, every area of camp has a magnificent view. The lagoon is also the water source for a tremendous population of wildlife – dry season sightings boast buffalo and elephant by the hundreds.

Zarafa Camp is the brainchild of the founders of Great Plains Conservation, who pooled their collective experience on safari to create what they deemed to be the best and most environmentally innovative camp. Zarafa means “the beloved one” or “the lovely one” in Arabic. The name comes from a giraffe, which was presented to Charles X of France in 1826 by the Viceroy of Egypt. She travelled from Africa in a traditional Dhow boat, and it was on this journey that she was given her name reflecting her true elegance and splendor.

The villa, 210 square metre (2,260 sq ft) in extent, is under beige, flowing canvas, with canopy ceilings and completely open (yet netted) sides. Entering through the heavy wood Lamu door transports guests to a lavish space of deep reds, browns, brass and copper, evoking richness and beauty. Central to the Dhow Suites are a full lounge and dining area fitted dining table, coffee table with cappuccino machines and a full-length leather couch and chairs.

Two large bedrooms are connected to either side of the main area designed with an open layout bathroom with impressive copper claw foot bath, indoor shower, separate loo and double basins and even an open fire, with copper flue, to heat the room in winter.

A large decking area fronts onto the suites with a 5 x 2.5 metre swimming pool, exercise bike and full-body outdoor showers for each room, all with views of pristine Botswana wilderness.

The adjoining main camp has a curio shop for those who need retail therapy and an in-room massage is also available.



FACT FILE  
ZARAFKA DHOW SUITES  
NORTHERN BOTSWANA



The Dhow Suites successfully retain a clearly African feel, while balancing that delicate relationship between personal and informal and romance and adventure. There is no equal in terms of its environmental credentials and its careful appointments.

Selinda Reserve, at the crossroads of some of northern Botswana's most prolific wildlife areas, boasts staggering wildlife populations year-round. Home to some of the classic species, such as leopard, lion, elephant, buffalo, Red lechwe, zebra and giraffe, it is also a refuge for some of the more uncommon species such as African wild dog (which usually den each dry season near camp), cheetah, roan and sable. And for birders, it will not disappoint. Our nearby African skimmer colony is a highlight, as are the antics of the Black egret on the shores of Zibadianja Lagoon. From the Dhow Suites, hippos are visible in the Lagoon and elephant wander through regularly. Night noises will either lull you to sleep or wake you from a deep slumber. It is an exciting area, and guests are in the heart of a wilderness wonderland.



# ZARAF A DHOW SUITES NORTHERN BOTSWANA



## ACTIVITIES

The Dhow Suites offer complete flexibility with your own private guide and vehicle. Drives do focus on the most comfortable and productive times of day, early morning and late afternoon, but full day drives are also quite common at a guest's request. Picnic brunch can be delivered, and the vehicles are stocked with cold drinks. There is a custom built Land Cruiser specially designed for our conditions and photography (fold-down screens and raised roofs) with four individual bucket seats.

The HES Zib, Zarafa's special pontoon boat, is an utterly unique experience and available to all guests. The 275 sq. foot deck is complete with couches, a dining area and bar where guests can comfortably enjoy a floating brunch or sundowners while watching hippos and elephants in the water. It is also an exceptional platform for birding. Fishing equipment is available for those who want to try their luck catching the local bream. Walks can also be arranged and are led by licensed guides with firearm training. For stargazers, the Suites come with its own Swarovski telescope for use on the private deck.

## PHOTOGRAPHY

The Suites have a professional Canon camera set, including two Canon 5D camera bodies with Canon 100-400mm and 20-105mm lenses. Photos will be downloaded to a storage device on guest's departure. Each room also comes with a pair of Swarovski binoculars for guest use as well.

Telephone:	+27 (0) 87 354 6591
Facsimile:	+27 (0) 21 701 1073
After Hours Emergency:	+27 (0)79 284 5945
Email:	res.manager@greatplainsconservation.com
Website:	www.greatplainsconservation.com
Total Number of Bedrooms:	2 double or twin
Type of Lodge:	Safari Camp
Lodge Season & Opening:	Year Round
Ideal length of stay:	4 Nights

# ZARAF A DHOW SUITES NORTHERN BOTSWANA



## GEOGRAPHY

### ACCESS DIRECTIONS

- Light aircraft transfers from Kasane (50 mins) and Maun (45 min) airports.
- Private Air charter access available.
- The Zarafa Dhow Suites are a 45-minute drive/boat from its airstrip.
- Co-ordinates: S18 35' 22.86" : E23 30' 51.28"

## TENT DETAILS

### BEDROOM

- 2,260 sq. foot "marquis" style tent of canopied beige canvas on raised wood deck of 100-year-old teak railroad ties.
- Private deck leading to a private swimming pool.
- Lounge has couch and two chairs, plus coffee station and dining table.
- A fridge holds a wide selection of beverages, wine and spirits.
- Swarovski telescope, binoculars and camera.
- Gas fireplace is between the bedroom and bath.
- Either twin or double bed configuration.

### BATHROOM

- En-suite from the bedroom, there is an open-air concept bathroom with indoor shower, claw foot deep copper tub and double vanities.
- Separate flush loo room.
- Outdoor 'full-body' shower.
- Hot and cold running water.
- Soap, shampoo, conditioner and lotion and hairdryers provided.

### CONSTRUCTION

- Elaborate canvas tent on raised wood decking.

## TEMPERATURE CONTROL

- Unique bed cooling system for summer.
- Gas fireplace for winter.

## MOSQUITO NETS

- Fly netting on all room sides and over beds.

## FOOD & DRINK

- All meals included.
- All drinks and beverages are included with the exception of imported champagnes.
- World-class (Relais & Chateaux recognised).
- Three delicious meals a day are provided. We are extremely flexible on timings. Picnic breakfasts or lunch (or both) are the norm due to very active game drives, often delivered to the bush!
- All dietary requirements are catered for from regular to vegan to children, prior warning requested.

## USUAL BOARD BASIS

- Full board

## DINING STYLE

- Private a la carte (menu options)

## DINING LOCATIONS

- Indoor and outdoor
- Room Service
- As standard

## EXTRAS

### LAUNDRY

- Included in nightly tariff - next day service, weather permitting



# ZARAF A DHOW SUITES

## NORTHERN BOTSWANA



### CENTRAL FACILITIES/ COMMON AREAS

- Central Lounge and dining room with small bar
- 5m Swimming pool
- Coffee/tea station
- Expansive deck with fire pit & seating

### SHOP/BOUTIQUE

- A shop is situated at Zarafa Camp and can be visited throughout the day selling locally and regionally produced crafts, many of which support local community projects in the nearby
- Okavango panhandle.

### SPA/GYM

- Yoga mats and bands are provided in each suite.
- In-room massage is available at additional cost.
- Spinning exercise bike.

### EQUIPMENT

- Each room has the following for guest use during their stay:
- Canon 5D camera body with 24 - 105mm and 100-400mm lenses
- Swarovski telescope (one for the Suites)
- Swarovski 8 x 42 binoculars

### PRIVATE VEHICLE

- Available at standard

### CHILDREN

- We look forward to having children stay with

us that are 8 years and older.

- Children must be a minimum of 12 years old to participate in extensive walking activities (kid's program excepted)
- Children's program – thoughtfully designed to explore a range of experiences and topics from birding to cooking to art to tracking wildlife.

### POWER & COMMUNICATIONS

#### SOURCE

- The Dhow Suites are operated by an impressive solar farm.
- This system produces 220V, 24-hour electricity to the tents and main area.
- Universal plug points in each tent.

#### INTERNET & MOBILE

- Neither is available.

### HEALTH & SAFETY

#### MALARIA

- Minimal exposure – Malaria prophylaxis are recommended if guests are concerned; however, this is a remote area with little occurrence.

#### MEDICAL CARE

- Guests must hold comprehensive medical insurance and emergency evacuation insurance.
- Senior staff all has first aid training.
- Nearest decent medical facility is in Maun, and then Johannesburg.



# ZARAFI DHOW SUITES NORTHERN BOTSWANA



## **RISK OF DANGEROUS ANIMALS**

- Moderate due to high predator density area.

## **SECURITY MEASURES**

- None. There are no populations nearby, and no uninvited guests.

## **FIRE SAFETY**

- Four fire extinguishers.

## **POSSIBILITY OF DISABLED ACCESS**

- The Dhow Suites layout is not conducive to wheelchair bound guests due to stair access and steps on the main decking.

## **MONEY MATTERS**

### **SAFES**

- Provided in every room.

### **ACCEPTED PAYMENT ON LOCATION**

- All-inclusive.
- Staff gratuities can be paid in Botswana Pula, South African Rands, US Dollars (check with your agent the minimum year accepted at date of departure), Euros or GB Pounds.

## **THE TEAM**

### **LODGE OWNERS**

- Great Plains Conservation

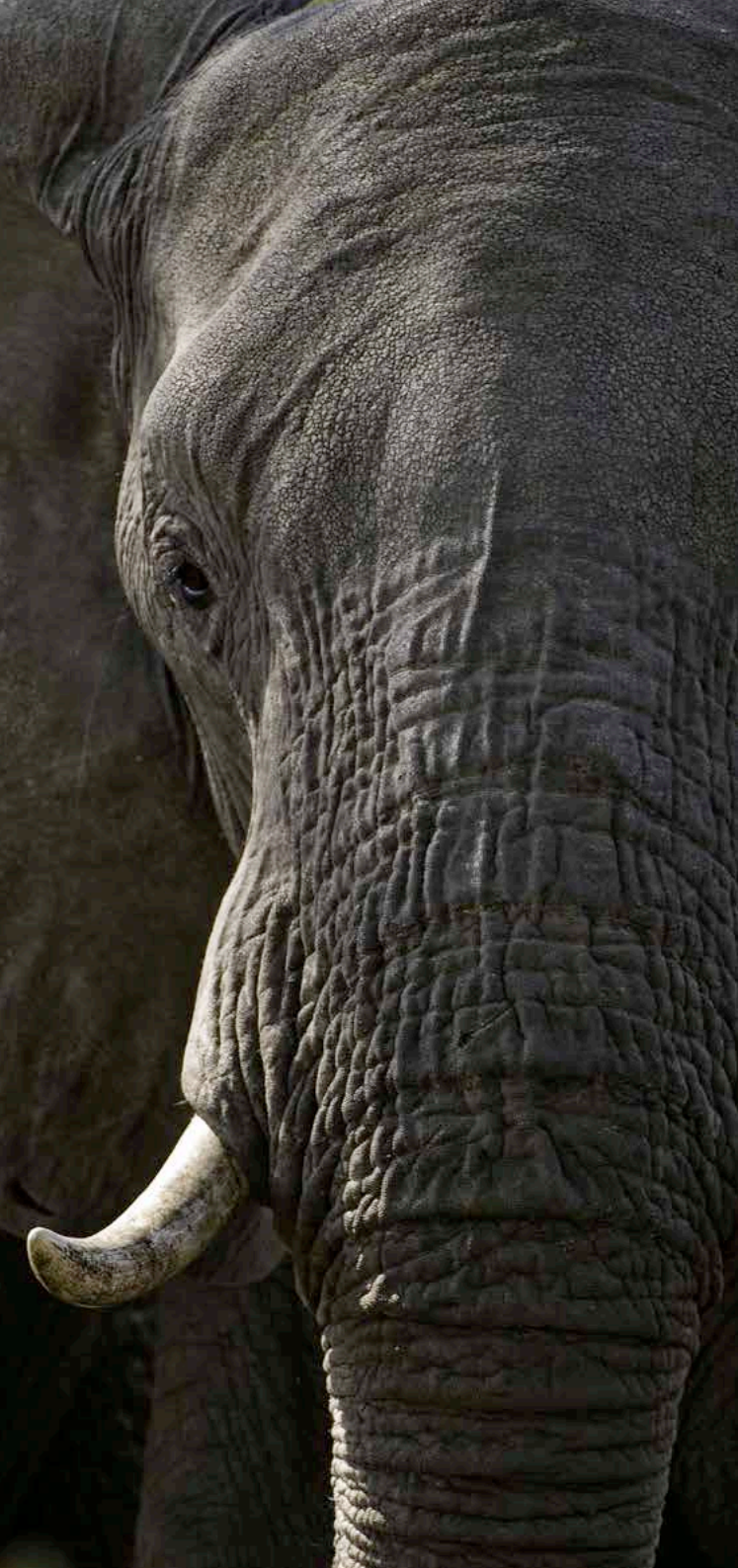

# ZARAFI DHOW SUITES NORTHERN BOTSWANA



## CAMP LAYOUT

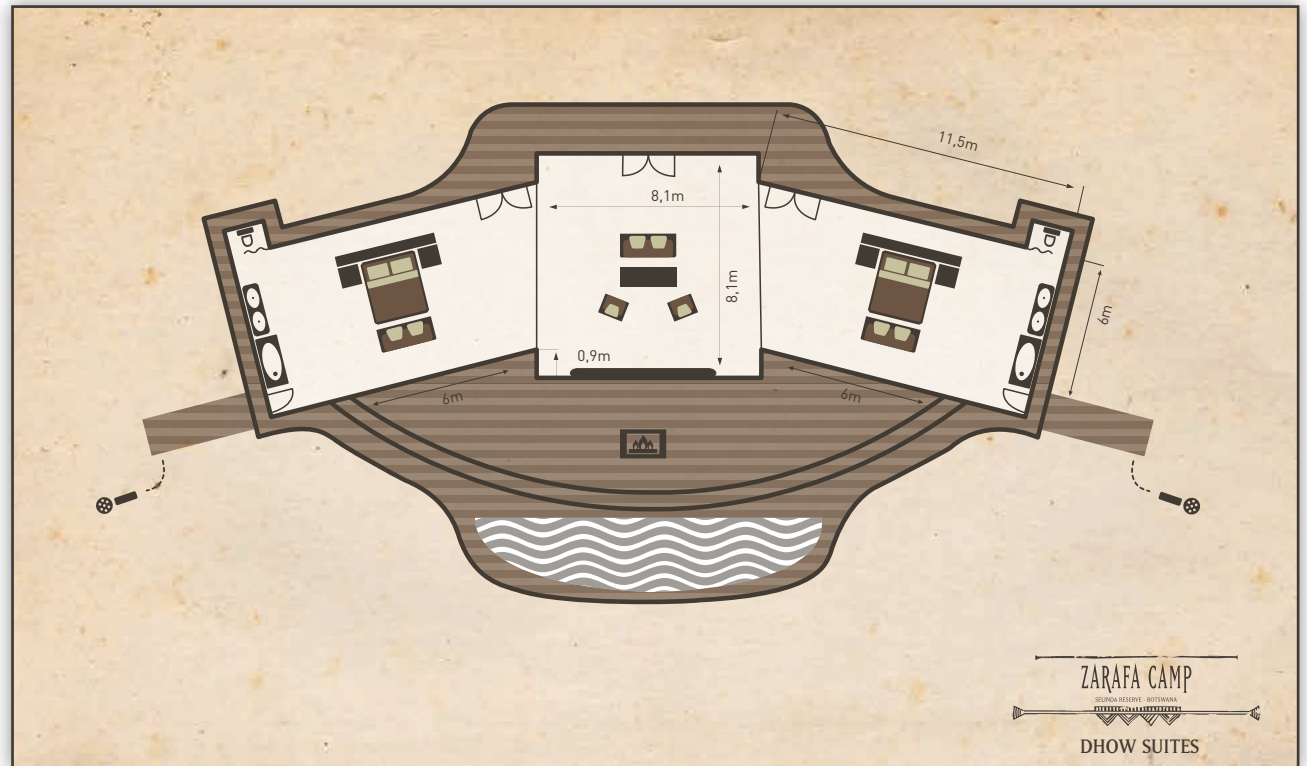

# GREAT PLAINS CONSERVATION

## QUICK CAMP FACTS



ACTIVITY	BOTSWANA CAMPS							KENYA CAMPS		
	ZARAFA CAMP	ZARAFA DHOW SUITES	SELINDA CAMP	DUBA PLAINS	DUBA EXPEDITION	SELINDA EXPLORERS	SELINDA CANOE TRAIL	OL DONYO LODGE	MARA PLAINS	MARA TOTO
Day Drives	•	•	•	•	•	•		•	•	•
Night Drives	•	•	•	•	•	•		•	•	
Guided Walks	•	•	•	•	•	•	•	•		
Boating	•	•	•	•	•					
Mokoro										
Canoeing						•	•			
Main Swimming Pool		•	•	•				•		
Private Plunge Pools	•							•		
Horseback Riding								•		
Cultural Interaction *								•	•	•
Hot-Air Ballooning *									•	•
Spa/Massage *	•	•	•	•				•		
Gym	•	•								
Fishing (Seasonal)	•	•	•	•	•	•	•			
Mountain Biking								•		
Hide			•					•		

[\*] This activity is available for an additional fee.