



RICHARD'S RIVER CAMP

— Masai Mara • Kenya —

FACT SHEET



^ RIVER CAMP



www.richardscamp.com



LOCATION

Richard's River Camp is located in the Masai Mara - and sits on the border of the Mara North Conservancy and the Olare Orok Conservancy.

ACCESS DIRECTIONS

Scheduled light aircraft transfer to the nearest airstrip, Mara North Conservancy, from Nairobi's Wilson domestic airport (1 hr 15 mins) and other locations in Kenya. Private charters can also land at MNC airstrip.

- River Camp is a 40 minute drive from the airstrip.
- The River camp co-ordinates are 1°17'20.40" South and 35°12'26.54" East.

CAMP INFORMATION

Perfectly situated on the banks of the Njageteck River and surrounded by 70 acres of private land, the camp allows for total privacy and exclusivity. The Ngoyanai springs provide permanent water, drawing in large numbers of animals to the area around camp both day and night.

This camp is also particularly known for its resident lion pride which can often be seen hunting right in front of the camp, and most always can be heard roaring during the night.

The camp mess and dining area is central to its layout - with tent nos 1 & 2 & the family tent (units 3 & 4) to the left of it and tents 5,6,7 & 8 to the right. All tents and seating areas look out across the Njageteck River in front of the camp. Very close to the mess area is a guest toilet, the boutique, the dining tent and the outside seating/dining areas.

ACCOMMODATION

With only 6 tents and one large family tent, this camp is ideal for individuals as well as exclusive groups who wish to experience the Masai Mara in a personal intimate setting. Beautifully appointed with furnishings and fabrics collected by Liz on her travels - the result is a casually luxurious tented camp, combining exceptional wildlife with a contemporary 'Out of Africa' experience.

tent details

Each canvas tent is a customized design which allows for significant size, air flow and light. Raised on concrete platforms with low wooden steps, the tent walls are high with netted windows and a low roof

pitch, therefore creating a fantastic airflow and good ventilation throughout. The tents are beige in color and the ceilings have been covered with hand printed fabric which makes the tent interiors brighter.

Each tent comprises of a large bedroom area, behind which there is a dressing room followed by the bathroom. The dressing rooms can accommodate up to two extra beds each should it be required; therefore each standard tent can sleep up to four people. The family tent (two normal tent units which are inter-connected by a central living area) can sleep up to eight people quite comfortably. The actual dimensions and layout for both standard and family tent are attached within this fact sheet.

bathroom details

Each tent is en-suite with a flush loo and shower area.

- Hot and cold running water.
- Soap, shampoo and conditioner provided.
- Power system does not support hairdryers, shavers or any high wattage device.

Tent no. 8 is usually reserved as the 'Honeymooners' tent as it is furthest away from the rest of the camp therefore making it a bit more secluded and private.



CAMP FACILITIES

WiFi

Wireless internet is only available in the mess tent and dining area.

Laundry service

Laundry service is inclusive in the rate. It is collected each day and returned the following day, weather permitting.

Elizabeth Fusco Designs shop

The camp shop is located near the mess tent and sells locally produced crafts as well as designs by Liz Fusco.

EXTRAS

Exclusive vehicle

We take a maximum of 7 guests per car on shared game drives, however a private car can be organized at an extra charge per car, per day (please enquire regarding the cost of this). We strongly recommend an exclusive vehicle for groups or families with young children.

Balloon safaris

A once-in-a-lifetime experience ending with a champagne breakfast on the Mara plains. Can be arranged at an additional cost, in advance.

Cultural visits

Visits to a nearby local Masai village can be organized at an additional cost of \$20 per person.

ADDITIONAL INFORMATION

Security measures

Night guards will remain by the fire all night and will escort guests to and from their tents in the evenings and early mornings. They are also on hand throughout the night should guests require any assistance.

Power source

Our solar sytem provides 24hr silent power to all the tents. The power system does not support any other high-wattage devices (e.g hairdriers).

Medical care

All guests must hold comprehensive medical insurance and emergency evacuation insurance. The nearest medical facility is Nairobi.

Money

Credit card payments are accepted in camp for shop purchases. Staff gratuities can be paid in Kenyan Shillings, US Dollars or GB Pounds (cash).

Owned by

Richard Roberts and Liz Fusco.

Camp managers

Finlay Marrian and Hannah Geddes.

Camp staff

Most of our staff are of the Masai tribe and their families live within the Mara. The guides at the camps are also Masai and therefore know everything there is to know about the area. Our chefs have been trained in international cuisine at various kitchens across Kenya and have amassed a wide range of culinary skills and cooking methods.

CONTACT DETAILS

Nairobi Office- Reservations:

Blixen Court, Office no. 9, Lower Plains Road (off Karen Road), Karen, Nairobi, Kenya.

P.O. Box 24479 - 00502 Nairobi, Kenya.

t: + 254 (0) 712362941 e: reservations@richardscamp.com

Website: www.richardscamp.com

RIVER CAMP TENT LAYOUT

Details: each tent takes up to 2 extra beds in the dressing room unit, therefore each tent sleeps up to 4 people comfortably.

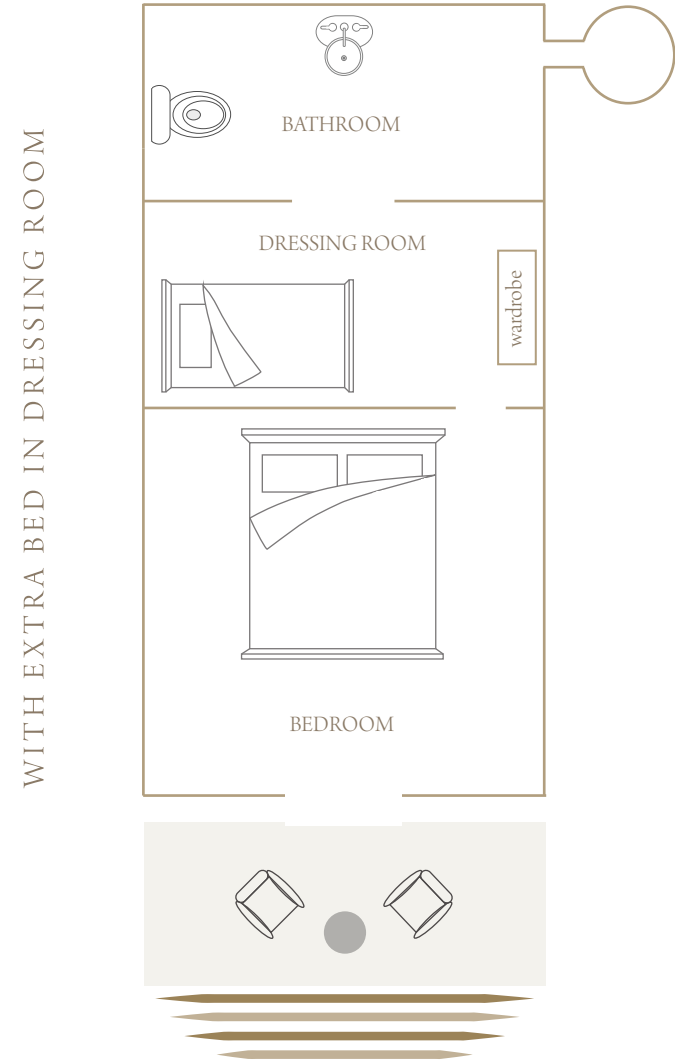
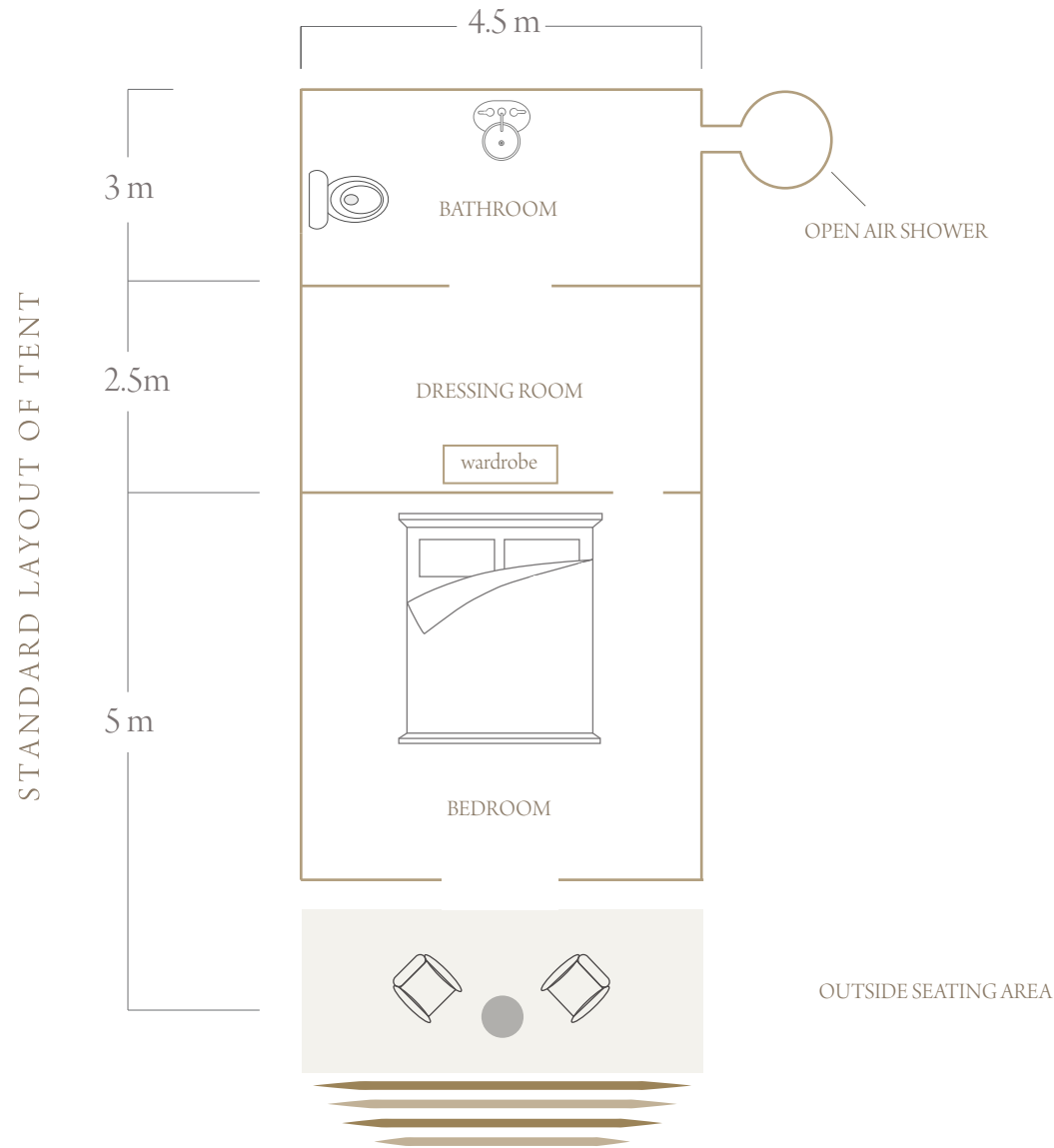

RIVER CAMP "FAMILY TENT" LAYOUT

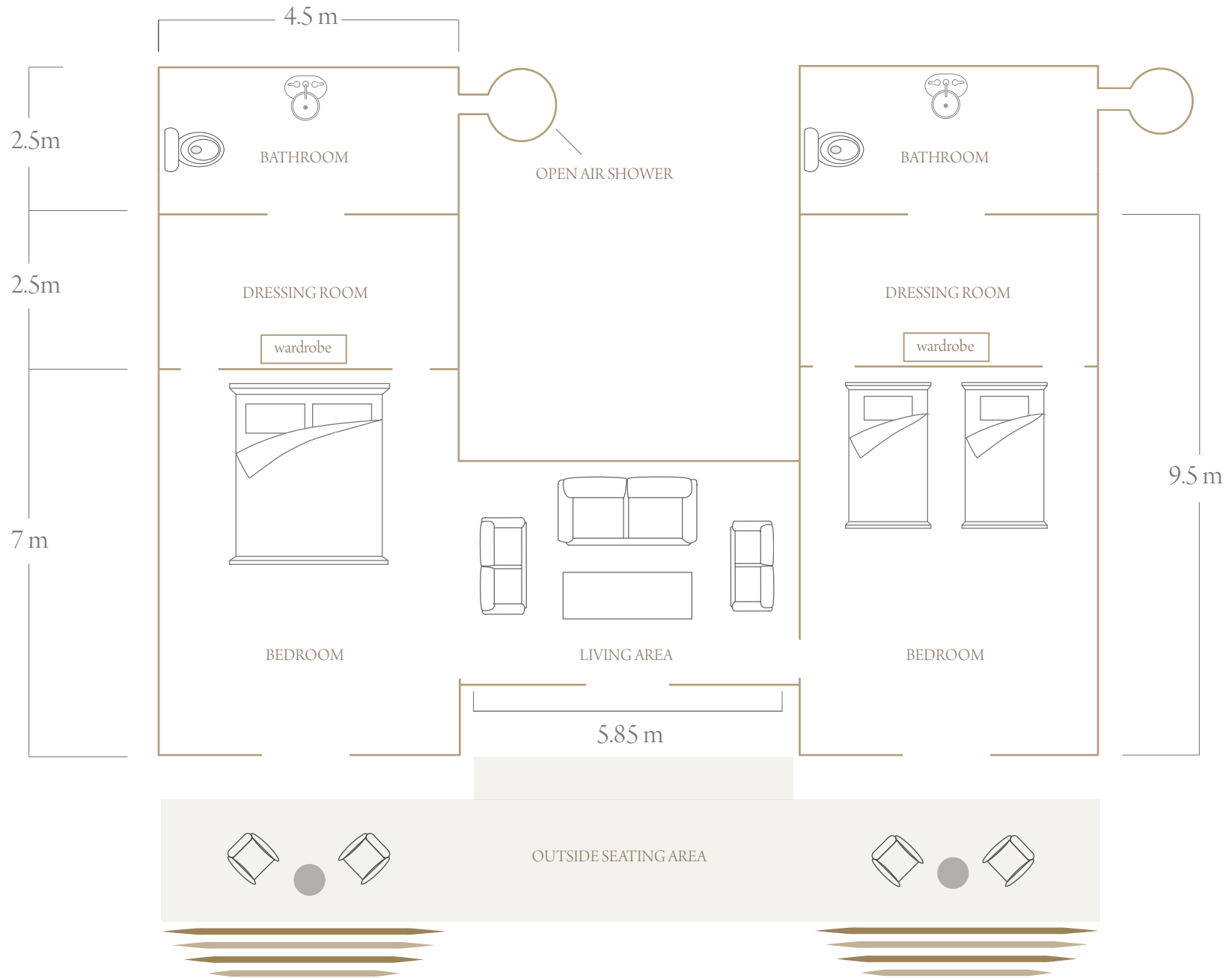

RIVER CAMP "FAMILY TENT" LAYOUT *with extra beds*

Details: each tent takes up to 2 extra beds in the dressing room unit, therefore the Family Tent sleeps up to 8 people comfortably.

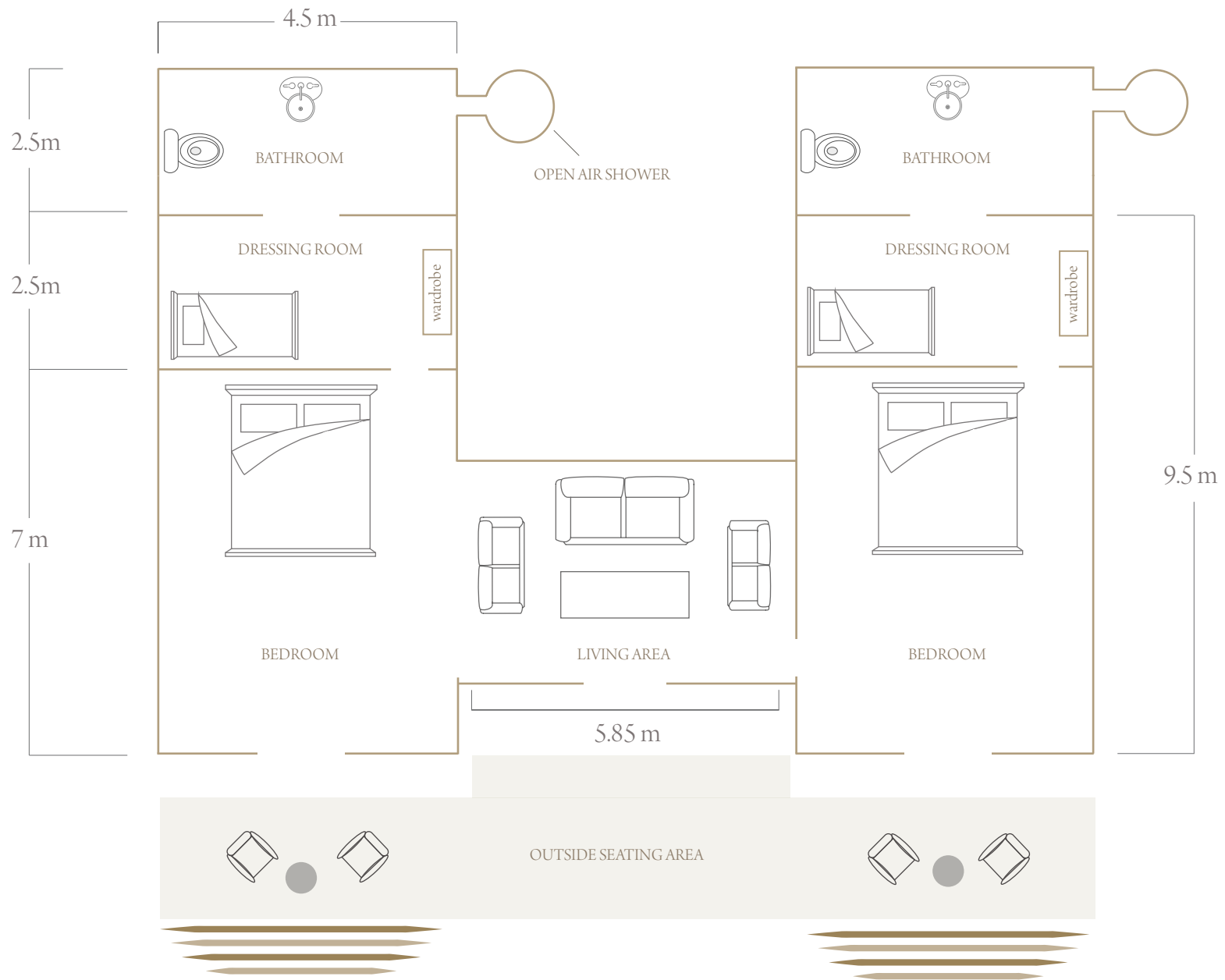

RICHARD'S RIVER CAMP LAYOUT

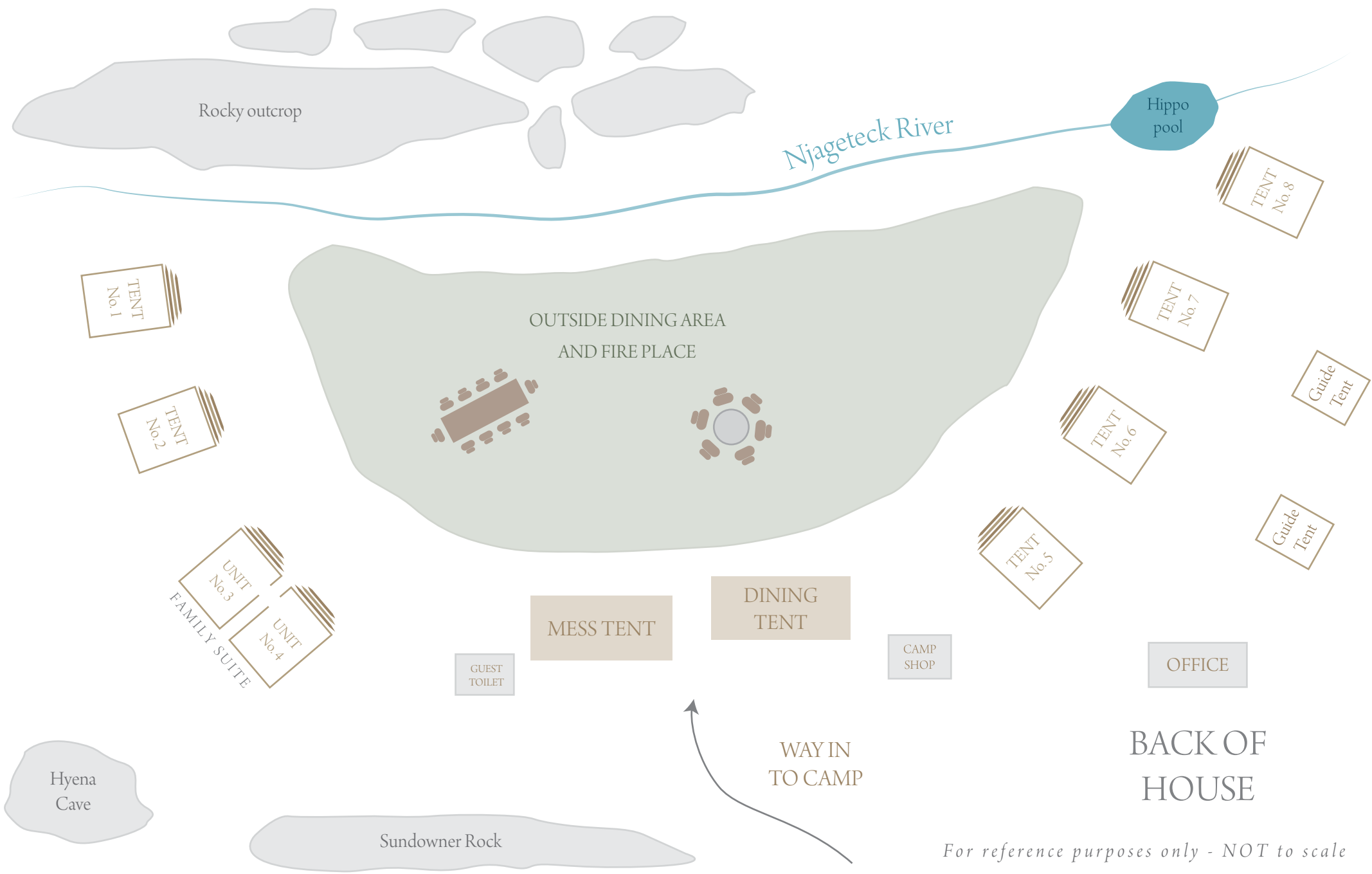



For reference purposes only - NOT to scale

KENYA



TANZANIA

 RICHARD'S CAMPS
 MARA NORTH AIRSTRIP



THE MASAI MARA