



ROVOS RAIL

JOURNEY
INFORMATION

African Golf Collage

2014 & 2015

Fact Sheets

Golf Course Information

Train Specifications

General Information

Terms & Conditions

The Most Luxurious Train in the World

ROVOS RAIL FACT SHEET

PRETORIA HQ 1 Transnet Ave, Capital Park 0001 • PO Box 2837 Pretoria 0001 South Africa • T: +27 (0) 12 315 8242 F: +27 (0) 12 323 0843
 CAPE TOWN 1 Adderley St, Cape Town 8002 • PO Box 50241 Waterfront 8002 South Africa • T: +27 (0) 21 421 4020 F: +27 (0) 21 421 4022
 ST JAMES MANOR Guesthouse - 108 Main Road, St James, Cape Town 7945 South Africa • T: +27 (0) 21 788 4543 F: +27 (0) 21 788 9590
 ST JAMES SEAFORTH Guesthouse - 96 Main Road, St James, Cape Town 7945 South Africa • T: +27 (0) 21 788 6778 F: +27 (0) 21 788 2428
 ST JAMES HOMESTEAD Guesthouse - 1 Ley Road, St James, Cape Town 7945 South Africa • T: +27 (0) 21 788 9250 F: +27 (0) 21 788 6185
 ROVOS RAIL E: reservations@rovos.co.za W: www.rovos.com • ST JAMES E: guesthouses@rovos.co.za W: www.stjamesguesthouses.com



AFRICAN GOLF COLLAGE - 2014 - PRETORIA to CAPE TOWN

9 days • 22-30 May • 6-14 November

This panoramic nine-day sojourn winds its way from Pretoria to Cape Town and includes a golfing and non-golfing itinerary. After a game drive in the famous Kruger Park*, guests head to Zululand for game viewing at Hluhluwe – the oldest reserve in Africa. The train then travels the coast along St Lucia Wetland Park to Durban* for a city tour and through the Valley of a Thousand Hills to Ardmore Ceramics. Enjoy a tour of Bloemfontein then continue overnight along the imposing Drakensberg Mountains to Port Elizabeth* for Addo Elephant Park. Then it's on to Oudtshoorn for an ostrich-farm visit followed by an impressive rail descent through the Outeniqua Mountains to George*. After visiting the natural paradise of Knysna*, the train traverses the spectacular Garden Route to the winelands for a brandy distillery visit and across the Cape Fold Mountains before this magnificent expedition ends in Cape Town. *Golfers play Leopard Creek at Kruger, Durban Country Club (or Beachwood), Humewood in Port Elizabeth and Fancourt and Ernie Els Oubaai in George. Available in reverse. See Golf Safari.

GOLFERS Collage		NON-GOLFERS Collage	
10h00	DAY 1 Depart Rovos Rail Station in Pretoria and traverse the Highveld to the spectacular Drakensberg Mountains.	10h00	THURSDAY Depart Rovos Rail Station in Pretoria and traverse the Highveld to the spectacular Drakensberg Mountains.
08h00	DAY 2 Tee off at Leopard Creek near Kruger with lunch. Board vehicles to rejoin train at Komatipoort and depart.	08h00 17h00	FRIDAY Game drive in the Kruger Park with lunch. Rejoin the train at Komatipoort and depart for Zululand.
09h30 13h00	DAY 3 Game drive in the Hluhluwe Reserve in Zululand. Lunch is served as the train travels south alongside the St Lucia Wetland Park to Durban for the overnight stop.	09h30 13h00	SATURDAY Game drive in the Hluhluwe Reserve in Zululand. Lunch is served as the train travels south alongside the St Lucia Wetland Park to Durban for the overnight stop.
08h00 16h00	DAY 4 Tee off at Durban Country Club. After lunch, enjoy a one-hour scenic drive along the Midlands Meander to join the train at Lions River. Traverse the Drakensberg via Bethlehem.	08h00 10h00 16h00	SUNDAY Disembark for a short city tour of Durban. Traverse the Valley of a Thousand Hills to Ardmore Ceramics for a two-hour afternoon visit. Return to the train. Traverse the Drakensberg.
09h00 13h00	DAY 5 Disembark for a city tour of Bloemfontein. Travel to Alicedale across the Drakensberg Mountains.	09h00 13h00	MONDAY Disembark for a city tour of Bloemfontein. Travel to Coerney across the Drakensberg Mountains.
07h00	DAY 6 One-hour transfer from Alicedale to Humewood Course. Enjoy a game and lunch before joining the train in Port Elizabeth. Experience the train being turned around at 14h15 then depart for Oudtshoorn via Willowmore.	08h30 11h30 14h15	TUESDAY Game drive at Addo Elephant Park. Rejoin the train and depart for Port Elizabeth. Experience the train being turned around then depart for Oudtshoorn via Willowmore.
09h00 10h30	DAY 7 Arrive Oudtshoorn. Transfer to George along Montagu Pass. Tee off at Fancourt followed by dinner at the estate.	09h00 18h30	WEDNESDAY Two-hour ostrich-farm visit. Traverse Montagu Pass. Disembark for dinner at Fancourt Estate.
07h00 13h00	DAY 8 Transfer to Ernie Els Oubaai for tee off at 08h00. Depart George and travel along the Garden Route via the Outeniqua Mountains to the coast for Riversdale.	08h00 13h00	THURSDAY Morning at leisure in Knysna or ferry ride to Featherbed. Depart George and travel the Garden Route via the Outeniqua Mountains to the coast for Riversdale.
11h00 17h00	DAY 9 Two-hour tour of the KWV Brandy Distillery, Worcester. Arrive at Platform 23 at Cape Town Station.	11h00 17h00	FRIDAY Two-hour tour of the KWV Brandy Distillery, Worcester. Arrive at Platform 23 at Cape Town Station.

MEALS ON THE TRAIN (unless adjusted) Breakfast 07h00-10h00 • Lunch 13h00 • Tea 16h30 • Dinner 19h30.

RACK RATE ONE WAY per person sharing includes accommodation, meals, all alcoholic and other beverages, 24-hour full room service and limited laundry while on board the train, as well as excursions accompanied by a qualified tour guide (where applicable) and government tax. Golf activities: green fees, carts, halfway house and beverages.

Pullman Suite R47 500	Deluxe Suite R71 000	Royal Suite R95 000	Single Supplement +50%
------------------------------	-----------------------------	----------------------------	-------------------------------

DEPARTURE DATES ARE SPECIFIC. Excursions may be changed according to schedule achieved. Times are approximate and cannot be guaranteed. Please check schedule with reservations@rovos.co.za or on www.rovos.com
BOOKING Upon **written request** via email or fax and subject to availability, we will **provisionally** book your place on the chosen tour. No deposits are required. Space is allocated and held BUT if definite suites are required by another client, the holding agent/guest will be asked to confirm with a deposit payment (see below) or release the suite. Upon receipt of a **written confirmation** via email or fax and a **completed Reservation Form**, final confirmation details and an invoice will be sent to you. Upon receipt of the **relevant payment**, your booking on the chosen tour will be **confirmed**.
TRAVEL & CANCELLATION INSURANCE ARE COMPULSORY We offer insurance to South African residents. For international guests we suggest you contact your local travel agent or credit card service provider for assistance.
PASSPORTS & VISAS The onus is on guests to ensure passports and visas, as may be required, are valid prior to departure for Africa. Visas available through booking agents; please check with relevant embassies for requirements.
HEALTH Passengers are advised to take anti-malarial precautions and vaccinations **as might be prescribed**. A Yellow Fever or Medical Exemption Certificate is essential if travelling to/from Zambia and Tanzania.

ROVOS RAIL FACT SHEET

PRETORIA HQ 1 Transnet Ave, Capital Park 0001 • PO Box 2837 Pretoria 0001 South Africa • T: +27 (0) 12 315 8242 F: +27 (0) 12 323 0843
 CAPE TOWN 1 Adderley St, Cape Town 8002 • PO Box 50241 Waterfront 8002 South Africa • T: +27 (0) 21 421 4020 F: +27 (0) 21 421 4022
 ST JAMES MANOR Guesthouse - 108 Main Road, St James, Cape Town 7945 South Africa • T: +27 (0) 21 788 4543 F: +27 (0) 21 788 9590
 ST JAMES SEAFORTH Guesthouse - 96 Main Road, St James, Cape Town 7945 South Africa • T: +27 (0) 21 788 6778 F: +27 (0) 21 788 2428
 ST JAMES HOMESTEAD Guesthouse - 1 Ley Road, St James, Cape Town 7945 South Africa • T: +27 (0) 21 788 9250 F: +27 (0) 21 788 6185
 ROVOS RAIL E: reservations@rovos.co.za W: www.rovos.com • ST JAMES E: guesthouses@rovos.co.za W: www.stjamesguesthouses.com



AFRICAN GOLF COLLAGE - 2014 - CAPE TOWN to PRETORIA

9 days • 17-25 November

This panoramic nine-day sojourn winds its way from Cape Town to Pretoria and includes a golfing and non-golfing itinerary. From the Mother City, the train travels the Cape winelands for a wine tasting before traversing the spectacular Garden Route to George*. After visiting the natural paradise of Knysna*, travel the breathtaking Montagu Pass to Oudtshoorn for an ostrich-farm visit. Continue to Port Elizabeth* for the ecologically diverse Addo Elephant Park before climbing the imposing Drakensberg Mountains. Tour Bloemfontein then descend through the Valley of a Thousand Hills to Durban*. Enjoy a tour before traversing KwaZulu-Natal's lush cane fields to Swaziland for a game drive at Mkhaya. After morning game viewing at the famous Kruger Park*, guests enjoy the majestic climb over the Drakensberg before descending into the Highveld to journey's end at Rovos Rail Station in Pretoria. *Golfers play Ernie Els Oubaai and Fancourt in George, Humewood in Port Elizabeth, Durban Country Club (or Beachwood) and Leopard Creek at Kruger. Available in reverse. **See Golf Safari.**

GOLFERS Collage		NON-GOLFERS Collage	
09h20 16h00	DAY 1 Depart Cape Town Station, Platform 23. Arrive Ashton for a wine tasting at Zandvliet Estate.	09h20 16h00	MONDAY Depart Cape Town Station, Platform 23. Arrive Ashton for a wine tasting at Zandvliet Estate.
10h00 18h30	DAY 2 Arrive in George. Transfer to Fancourt for tee off at 11h00. Disembark for dinner at Fancourt Estate.	10h00 16h00	TUESDAY Morning at leisure in Knysna or ferry ride to Featherbed. Return to train. 18h30 transfer to Fancourt for dinner.
07h30 13h00	DAY 3 Tee off at Ernie Els Oubaai Golf Club. Transfer to Oudtshoorn. Enjoy lunch on board as the train travels the Outeniqua Mountains to Port Elizabeth.	08h00 11h00 13h00	WEDNESDAY Depart George and travel to Oudtshoorn. Enjoy a visit to an ostrich farm. Traverse the Outeniqua Mountains to Port Elizabeth.
07h30 13h00	DAY 4 Tee off at Humewood Golf Course in Port Elizabeth. Transfer to Coerney to join train. Traverse the Fish River Valley through the Drakensberg Mountains.	08h30 13h00	THURSDAY Game drive in the Addo Elephant Park. Depart for Rosmead and traverse the Fish River Valley through the Drakensberg Mountains.
14h00 17h30	DAY 5 Travel the Drakensberg to Bloemfontein for a city tour. Travel the border of Lesotho's mountain kingdom and descend the escarpment via Bethlehem to Ladysmith.	14h00 17h30	FRIDAY Travel the Drakensberg to Bloemfontein for a city tour. Travel the border of Lesotho's mountain kingdom and descend the escarpment via Bethlehem to Ladysmith.
07h00 10h45 17h00	DAY 6 Traverse the Valley of a Thousand Hills to Lions River. Transfer to Durban Country Club for tee off at 12h00. Join train in Durban. Depart for Swaziland at 19h00.	07h00 15h00 19h30	SATURDAY Travel the Valley of a Thousand Hills to Lions River. Disembark in Durban for an afternoon city tour. Enjoy dinner as the train travels to Swaziland.
15h00 18h00	DAY 7 Game drive at Mkhaya Reserve in Swaziland. Travel north to Komatipoort, South Africa.	15h00 18h00	SUNDAY Game drive at Mkhaya Reserve in Swaziland. Travel north to Komatipoort, South Africa.
07h00 13h00	DAY 8 Transfer to Leopard Creek for tee off at 07h30. Enjoy lunch as the train travels across the Drakensberg Mountains to Waterval Onder for the overnight stop.	06h00 13h00	MONDAY Game drive in the Kruger Park with brunch. Enjoy lunch as the train travels across the Drakensberg Mountains to Waterval Onder for the overnight stop.
07h00 15h00	Day 9 The train descends the escarpment to the farming and coal-mining areas of the Highveld. Arrive at journey's end at Rovos Rail Station, Pretoria.	07h00 15h00	TUESDAY The train descends the escarpment to the farming and coal-mining areas of the Highveld. Arrive at journey's end at Rovos Rail Station, Pretoria.

MEALS ON THE TRAIN (unless adjusted) Breakfast 07h00-10h00 • Lunch 13h00 • Tea 16h30 • Dinner 19h30.

RACK RATE ONE WAY per person sharing includes accommodation, meals, all alcoholic and other beverages, 24-hour full room service and limited laundry while on board the train, as well as excursions accompanied by a qualified tour guide (where applicable) and government tax. Golf activities: green fees, carts, halfway house and beverages.

Pullman Suite R47 500 **Deluxe Suite** R71 000 **Royal Suite** R95 000 **Single Supplement** +50%

DEPARTURE DATES ARE SPECIFIC. Excursions may be changed according to schedule achieved. Times are approximate and cannot be guaranteed. Please check schedule with reservations@rovos.co.za or on www.rovos.com
BOOKING Upon **written request** via email or fax and subject to availability, we will **provisionally** book your place on the chosen tour. No deposits are required. Space is allocated and held BUT if definite suites are required by another client, the holding agent/guest will be asked to confirm with a deposit payment (see below) or release the suite. Upon receipt of a **written confirmation** via email or fax and a **completed Reservation Form**, final confirmation details and an invoice will be sent to you. Upon receipt of the **relevant payment**, your booking on the chosen tour will be **confirmed**.

TRAVEL & CANCELLATION INSURANCE ARE COMPULSORY We offer insurance to South African residents. For international guests we suggest you contact your local travel agent or credit card service provider for assistance.

PASSPORTS & VISAS The onus is on guests to ensure passports and visas, as may be required, are valid prior to departure for Africa. Visas available through booking agents; please check with relevant embassies for requirements.

HEALTH Passengers are advised to take anti-malarial precautions and vaccinations **as might be prescribed**.

A Yellow Fever or Medical Exemption Certificate is essential if travelling to/from Zambia and Tanzania.

ROVOS RAIL FACT SHEET

PRETORIA HQ 1 Transnet Ave, Capital Park 0001 • PO Box 2837 Pretoria 0001 South Africa • T: +27 (0) 12 315 8242 F: +27 (0) 12 323 0843
 CAPE TOWN 1 Adderley St, Cape Town 8002 • PO Box 50241 Waterfront 8002 South Africa • T: +27 (0) 21 421 4020 F: +27 (0) 21 421 4022
 ST JAMES MANOR Guesthouse - 108 Main Road, St James, Cape Town 7945 South Africa • T: +27 (0) 21 788 4543 F: +27 (0) 21 788 9590
 ST JAMES SEAFORTH Guesthouse - 96 Main Road, St James, Cape Town 7945 South Africa • T: +27 (0) 21 788 6778 F: +27 (0) 21 788 2428
 ST JAMES HOMESTEAD Guesthouse - 1 Ley Road, St James, Cape Town 7945 South Africa • T: +27 (0) 21 788 9250 F: +27 (0) 21 788 6185
 ROVOS RAIL E: reservations@rovos.co.za W: www.rovos.com • ST JAMES E: guesthouses@rovos.co.za W: www.stjamesguesthouses.com



AFRICAN GOLF COLLAGE - 2015 - PRETORIA to CAPE TOWN

9 days • 21-29 May • 5-13 November

This panoramic nine-day sojourn winds its way from Pretoria to Cape Town and includes a golfing and non-golfing itinerary. After a game drive in the famous Kruger Park*, guests head to Zululand for game viewing at Hluhluwe – the oldest reserve in Africa. The train then travels the coast along St Lucia Wetland Park to Durban* for a city tour and through the Valley of a Thousand Hills to Ardmore Ceramics. Enjoy a tour of Bloemfontein then continue overnight along the imposing Drakensberg Mountains to Port Elizabeth* for Addo Elephant Park. Then it's on to Oudtshoorn for an ostrich-farm visit followed by an impressive rail descent through the Outeniqua Mountains to George*. After visiting the natural paradise of Knysna*, the train traverses the spectacular Garden Route to the winelands for a brandy distillery visit and across the Cape Fold Mountains before this magnificent expedition ends in Cape Town. *Golfers play Leopard Creek at Kruger, Durban Country Club (or Beachwood), Humewood in Port Elizabeth and Fancourt and Ernie Els Oubaai in George. *Available in reverse. See Golf Safari.*

GOLFERS Collage		NON-GOLFERS Collage	
10h00	DAY 1 Depart Rovos Rail Station in Pretoria and traverse the Highveld to the spectacular Drakensberg Mountains.	10h00	THURSDAY Depart Rovos Rail Station in Pretoria and traverse the Highveld to the spectacular Drakensberg Mountains.
08h00	DAY 2 Tee off at Leopard Creek near Kruger with lunch. Board vehicles to rejoin train at Komatipoort and depart.	08h00 17h00	FRIDAY Game drive in the Kruger Park with lunch. Rejoin the train at Komatipoort and depart for Zululand.
09h30 13h00	DAY 3 Game drive in the Hluhluwe Reserve in Zululand. Lunch is served as the train travels south alongside the St Lucia Wetland Park to Durban for the overnight stop.	09h30 13h00	SATURDAY Game drive in the Hluhluwe Reserve in Zululand. Lunch is served as the train travels south alongside the St Lucia Wetland Park to Durban for the overnight stop.
08h00 16h00	DAY 4 Tee off at Durban Country Club. After lunch, enjoy a one-hour scenic drive along the Midlands Meander to join the train at Lions River. Traverse the Drakensberg via Bethlehem.	08h00 10h00 16h00	SUNDAY Disembark for a short city tour of Durban. Traverse the Valley of a Thousand Hills to Ardmore Ceramics for a two-hour afternoon visit. Return to the train. Traverse the Drakensberg.
09h00 13h00	DAY 5 Disembark for a city tour of Bloemfontein. Travel to Alicedale across the Drakensberg Mountains.	09h00 13h00	MONDAY Disembark for a city tour of Bloemfontein. Travel to Coerney across the Drakensberg Mountains.
07h00	DAY 6 One-hour transfer from Alicedale to Humewood Course. Enjoy a game and lunch before joining the train in Port Elizabeth. Experience the train being turned around at 14h15 then depart for Oudtshoorn via Willowmore.	08h30 11h30 14h15	TUESDAY Game drive at Addo Elephant Park. Rejoin the train and depart for Port Elizabeth. Experience the train being turned around then depart for Oudtshoorn via Willowmore.
09h00 10h30	DAY 7 Arrive Oudtshoorn. Transfer to George along Montagu Pass. Tee off at Fancourt followed by dinner at the estate.	09h00 18h30	WEDNESDAY Two-hour ostrich-farm visit. Traverse Montagu Pass. Disembark for dinner at Fancourt Estate.
07h00 13h00	DAY 8 Transfer to Ernie Els Oubaai for tee off at 08h00. Depart George and travel along the Garden Route via the Outeniqua Mountains to the coast for Riversdale.	08h00 13h00	THURSDAY Morning at leisure in Knysna or ferry ride to Featherbed. Depart George and travel the Garden Route via the Outeniqua Mountains to the coast for Riversdale.
11h00 17h00	DAY 9 Two-hour tour of the KWV Brandy Distillery, Worcester. Arrive at Platform 23 at Cape Town Station.	11h00 17h00	FRIDAY Two-hour tour of the KWV Brandy Distillery, Worcester. Arrive at Platform 23 at Cape Town Station.

MEALS ON THE TRAIN (unless adjusted) Breakfast 07h00-10h00 • Lunch 13h00 • Tea 16h30 • Dinner 19h30.

RACK RATE ONE WAY per person sharing includes accommodation, meals, all alcoholic and other beverages, 24-hour full room service and limited laundry while on board the train, as well as excursions accompanied by a qualified tour guide (where applicable) and government tax. Golf activities: green fees, carts, halfway house and beverages.

Pullman Suite R50 400	Deluxe Suite R75 600	Royal Suite R99 800	Single Supplement +50%
------------------------------	-----------------------------	----------------------------	-------------------------------

DEPARTURE DATES ARE SPECIFIC. Excursions may be changed according to schedule achieved. Times are approximate and cannot be guaranteed. Please check schedule with reservations@rovos.co.za or on www.rovos.com
BOOKING Upon **written request** via email or fax and subject to availability, we will **provisionally** book your place on the chosen tour. No deposits are required. Space is allocated and held BUT if definite suites are required by another client, the holding agent/guest will be asked to confirm with a deposit payment (see below) or release the suite. Upon receipt of a **written confirmation** via email or fax and a **completed Reservation Form**, final confirmation details and an invoice will be sent to you. Upon receipt of the **relevant payment**, your booking on the chosen tour will be **confirmed**.

TRAVEL & CANCELLATION INSURANCE ARE COMPULSORY We offer insurance to South African residents.

For international guests we suggest you contact your local travel agent or credit card service provider for assistance.

PASSPORTS & VISAS The onus is on guests to ensure passports and visas, as may be required, are valid prior to departure for Africa. Visas available through booking agents; please check with relevant embassies for requirements.

HEALTH Passengers are advised to take anti-malarial precautions and vaccinations **as might be prescribed**.

A Yellow Fever or Medical Exemption Certificate is essential if travelling to/from Zambia and Tanzania.

ROVOS RAIL FACT SHEET

PRETORIA HQ 1 Transnet Ave, Capital Park 0001 • PO Box 2837 Pretoria 0001 South Africa • T: +27 (0) 12 315 8242 F: +27 (0) 12 323 0843
 CAPE TOWN 1 Adderley St, Cape Town 8002 • PO Box 50241 Waterfront 8002 South Africa • T: +27 (0) 21 421 4020 F: +27 (0) 21 421 4022
 ST JAMES MANOR Guesthouse - 108 Main Road, St James, Cape Town 7945 South Africa • T: +27 (0) 21 788 4543 F: +27 (0) 21 788 9590
 ST JAMES SEAFORTH Guesthouse - 96 Main Road, St James, Cape Town 7945 South Africa • T: +27 (0) 21 788 6778 F: +27 (0) 21 788 2428
 ST JAMES HOMESTEAD Guesthouse - 1 Ley Road, St James, Cape Town 7945 South Africa • T: +27 (0) 21 788 9250 F: +27 (0) 21 788 6185
 ROVOS RAIL E: reservations@rovos.co.za W: www.rovos.com • ST JAMES E: guesthouses@rovos.co.za W: www.stjamesguesthouses.com



AFRICAN GOLF COLLAGE - 2015 - CAPE TOWN to PRETORIA

9 days • 16-24 November

This panoramic nine-day sojourn winds its way from Cape Town to Pretoria and includes a golfing and non-golfing itinerary. From the Mother City, the train travels the Cape winelands for a wine tasting before traversing the spectacular Garden Route to George*. After visiting the natural paradise of Knysna*, travel the breathtaking Montagu Pass to Oudtshoorn for an ostrich-farm visit. Continue to Port Elizabeth* for the ecologically diverse Addo Elephant Park before climbing the imposing Drakensberg Mountains. Tour Bloemfontein then descend through the Valley of a Thousand Hills to Durban*. Enjoy a tour before traversing KwaZulu-Natal's lush cane fields to Swaziland for a game drive at Mkhaya. After morning game viewing at the famous Kruger Park*, guests enjoy the majestic climb over the Drakensberg before descending into the Highveld to journey's end at Rovos Rail Station in Pretoria. *Golfers play Ernie Els Oubaai and Fancourt in George, Humewood in Port Elizabeth, Durban Country Club (or Beachwood) and Leopard Creek at Kruger. Available in reverse. **See Golf Safari.**

GOLFERS Collage		NON-GOLFERS Collage	
09h20 16h00	DAY 1 Depart Cape Town Station, Platform 23. Arrive Ashton for a wine tasting at Zandvliet Estate.	09h20 16h00	MONDAY Depart Cape Town Station, Platform 23. Arrive Ashton for a wine tasting at Zandvliet Estate.
10h00 18h30	DAY 2 Arrive in George. Transfer to Fancourt for tee off at 11h00. Disembark for dinner at Fancourt Estate.	10h00 16h00	TUESDAY Morning at leisure in Knysna or ferry ride to Featherbed. Return to train. 18h30 transfer to Fancourt for dinner.
07h30 13h00	DAY 3 Tee off at Ernie Els Oubaai Golf Club. Transfer to Oudtshoorn. Enjoy lunch on board as the train travels the Outeniqua Mountains to Port Elizabeth.	08h00 11h00 13h00	WEDNESDAY Depart George and travel to Oudtshoorn. Enjoy a visit to an ostrich farm. Traverse the Outeniqua Mountains to Port Elizabeth.
07h30 13h00	DAY 4 Tee off at Humewood Golf Course in Port Elizabeth. Transfer to Coerney to join train. Traverse the Fish River Valley through the Drakensberg Mountains.	08h30 13h00	THURSDAY Game drive in the Addo Elephant Park. Depart for Rosmead and traverse the Fish River Valley through the Drakensberg Mountains.
14h00 17h30	DAY 5 Travel the Drakensberg to Bloemfontein for a city tour. Travel the border of Lesotho's mountain kingdom and descend the escarpment via Bethlehem to Ladysmith.	14h00 17h30	FRIDAY Travel the Drakensberg to Bloemfontein for a city tour. Travel the border of Lesotho's mountain kingdom and descend the escarpment via Bethlehem to Ladysmith.
07h00 10h45 17h00	DAY 6 Traverse the Valley of a Thousand Hills to Lions River. Transfer to Durban Country Club for tee off at 12h00. Join train in Durban. Depart for Swaziland at 19h00.	07h00 15h00 19h30	SATURDAY Travel the Valley of a Thousand Hills to Lions River. Disembark in Durban for an afternoon city tour. Enjoy dinner as the train travels to Swaziland.
15h00 18h00	DAY 7 Game drive at Mkhaya Reserve in Swaziland. Travel north to Komatipoort, South Africa.	15h00 18h00	SUNDAY Game drive at Mkhaya Reserve in Swaziland. Travel north to Komatipoort, South Africa.
07h00 13h00	DAY 8 Transfer to Leopard Creek for tee off at 07h30. Enjoy lunch as the train travels across the Drakensberg Mountains to Waterval Onder for the overnight stop.	06h00 13h00	MONDAY Game drive in the Kruger Park with brunch. Enjoy lunch as the train travels across the Drakensberg Mountains to Waterval Onder for the overnight stop.
07h00 15h00	Day 9 The train descends the escarpment to the farming and coal-mining areas of the Highveld. Arrive at journey's end at Rovos Rail Station, Pretoria.	07h00 15h00	TUESDAY The train descends the escarpment to the farming and coal-mining areas of the Highveld. Arrive at journey's end at Rovos Rail Station, Pretoria.

MEALS ON THE TRAIN (unless adjusted) Breakfast 07h00-10h00 • Lunch 13h00 • Tea 16h30 • Dinner 19h30.

RACK RATE ONE WAY per person sharing includes accommodation, meals, all alcoholic and other beverages, 24-hour full room service and limited laundry while on board the train, as well as excursions accompanied by a qualified tour guide (where applicable) and government tax. Golf activities: green fees, carts, halfway house and beverages.

Pullman Suite R50 400 **Deluxe Suite** R75 600 **Royal Suite** R99 800 **Single Supplement** +50%

DEPARTURE DATES ARE SPECIFIC. Excursions may be changed according to schedule achieved. Times are approximate and cannot be guaranteed. Please check schedule with reservations@rovos.co.za or on www.rovos.com
BOOKING Upon **written request** via email or fax and subject to availability, we will **provisionally** book your place on the chosen tour. No deposits are required. Space is allocated and held BUT if definite suites are required by another client, the holding agent/guest will be asked to confirm with a deposit payment (see below) or release the suite. Upon receipt of a **written confirmation** via email or fax and a **completed Reservation Form**, final confirmation details and an invoice will be sent to you. Upon receipt of the **relevant payment**, your booking on the chosen tour will be **confirmed**.

TRAVEL & CANCELLATION INSURANCE ARE COMPULSORY We offer insurance to South African residents. For international guests we suggest you contact your local travel agent or credit card service provider for assistance.

PASSPORTS & VISAS The onus is on guests to ensure passports and visas, as may be required, are valid prior to departure for Africa. Visas available through booking agents; please check with relevant embassies for requirements.

HEALTH Passengers are advised to take anti-malarial precautions and vaccinations **as might be prescribed**.

A Yellow Fever or Medical Exemption Certificate is essential if travelling to/from Zambia and Tanzania.

Train Specifications

Royal Suites ±16 SQ METRES

DOUBLE BED 189L x 189w
TWIN BEDS 189L x 94w

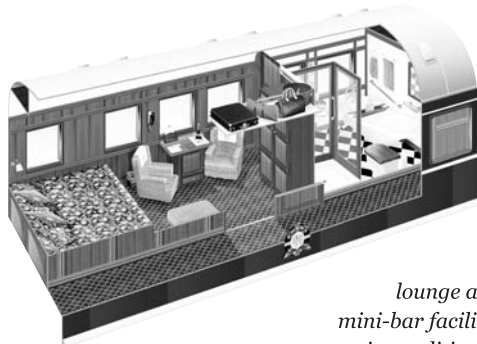

*lounge area
mini-bar facilities
air-conditioning
bathroom with bath and shower
luggage shelf, cupboards and safe*



Public Areas

LOUNGE CAR



DINING CAR

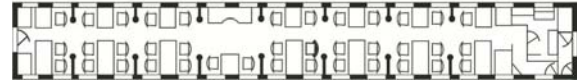

OBSERVATION CAR

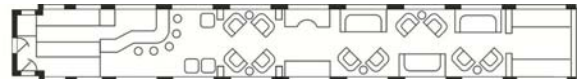

CLUB LOUNGE CAR

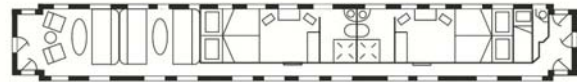

Deluxe Suites ±10 SQ METRES

LENGTHWAYS DOUBLE BED
Double 189L x 189w
Twin 189L x 94w

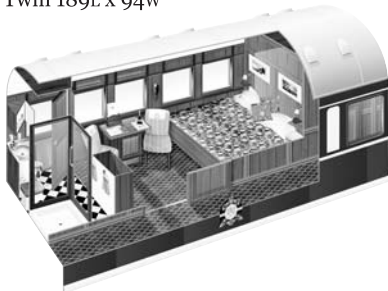

CROSSWISE DOUBLE BED
189L x 160w

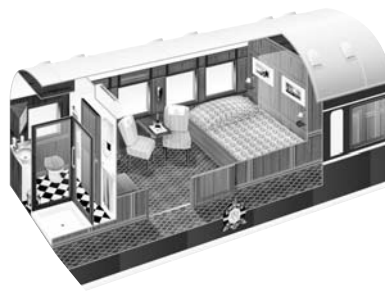

L-TWIN BEDS
189L x 90w

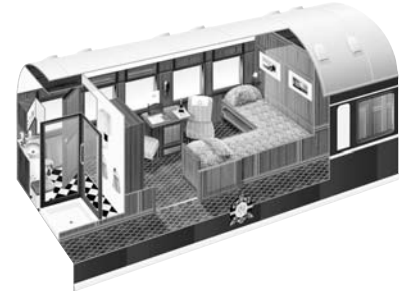

*Mini-bar facilities, air-conditioning, bathrooms with shower,
luggage shelf, cupboards and safe*

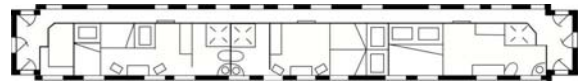

Pullman Suites ±7 SQ METRES

DAYTIME SOFA COUCH
189L x 90w

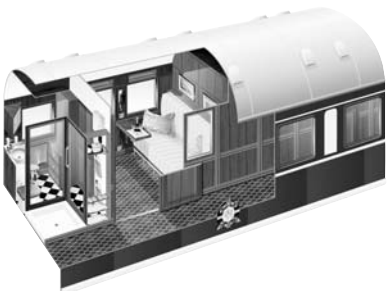

NIGHT-TIME UPPER AND LOWER BED
Lower 189L x 90w
Upper 189L x 60w

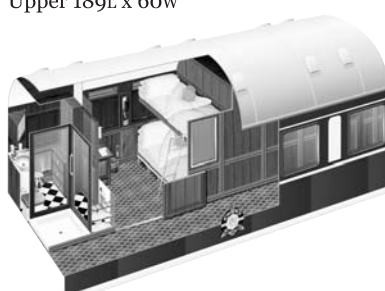

NIGHT-TIME DOUBLE BED
189L x 150w

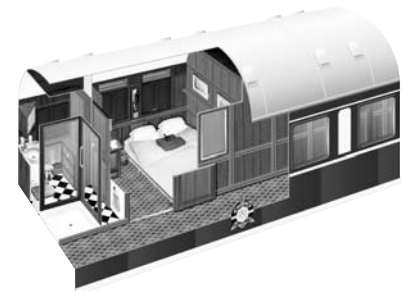

*Mini-bar facilities, air-conditioning, bathrooms with shower,
luggage shelf, cupboards and safe*



ROVOS RAIL FACT SHEET

PRETORIA HQ 1 Transnet Ave, Capital Park 0001 • PO Box 2837 Pretoria 0001 South Africa • T: +27 (0) 12 315 8242 F: +27 (0) 12 323 0843
 CAPE TOWN 1 Adderley St, Cape Town 8002 • PO Box 50241 Waterfront 8002 South Africa • T: +27 (0) 21 421 4020 F: +27 (0) 21 421 4022
 ST JAMES MANOR Guesthouse - 108 Main Road, St James, Cape Town 7945 South Africa • T: +27 (0) 21 788 4543 F: +27 (0) 21 788 9590
 ST JAMES SEAFORTH Guesthouse - 96 Main Road, St James, Cape Town 7945 South Africa • T: +27 (0) 21 788 6778 F: +27 (0) 21 788 2428
 ST JAMES HOMESTEAD Guesthouse - 1 Ley Road, St James, Cape Town 7945 South Africa • T: +27 (0) 21 788 9250 F: +27 (0) 21 788 6185
 ROVOS RAIL E: reservations@rovos.co.za W: www.rovos.com • ST JAMES E: guesthouses@rovos.co.za W: www.stjamesguesthouses.com



GENERAL INFORMATION

Booking

Upon **written request** via email or fax and subject to availability, we will **provisionally** book your place on the chosen tour. No deposits are required. Space is allocated and held BUT if definite suites are required by another client, the holding agent/guest will be asked to confirm with a deposit payment (see below) or release the suite. Upon receipt of a **written confirmation** via email or fax and a **completed Reservation Form**, final confirmation details and an invoice will be sent to you. Upon receipt of the **relevant payment**, your booking on the chosen tour will be **confirmed**.

Payment Schedule

- **Individuals and Small Groups – less than 10 guests:** A 25% deposit is required to confirm the reservation. Final payment is due no later than 8 weeks prior to departure (12 weeks for Cairo journey).
- **Groups – more than 10 guests**

% A NON-REFUNDABLE DEPOSIT/INCREMENTAL PAYMENT OF THE TOUR PRICE REQUIRED	12 MONTHS OUT -48wks	9 MONTHS OUT -36wks	6 MONTHS OUT -24wks	4 MONTHS OUT -16wks	3 MONTHS OUT -12wks	2 MONTHS OUT -8wks
Cape Town, Victoria Falls, Durban			10%	10%		100%
Golf Safari, African Collage, Namibia, Dar es Salaam		10%	20%	20%		100%
Cairo Journey	25%	50%	75%		100%	

Cancellation Policy

Cancellation insurance is compulsory and will not be waived. We offer insurance to South African residents. For international guests we suggest you contact your local travel agent for assistance. Please bring a copy of your travel insurance policy stating clearly the company, policy number and 24-hour medical emergency telephone number.

CANCELLATIONS OF CONFIRMED BOOKINGS RECEIVED PRIOR TO DEPARTURE ARE SUBJECT TO A FEE OF THE PER PERSON TOUR PRICE	MORE THAN 12 WEEKS BEFORE	BETWEEN 12 & 8 WEEKS BEFORE	MORE THAN 8 WEEKS BEFORE	BETWEEN 8 & 4 WEEKS BEFORE	WITHIN 4 WEEKS BEFORE
Cape Town, Victoria Falls, Durban			5%	25%	100%
Golf Safari, African Collage, Namibia, Dar es Salaam	10%	25%		50%	100%
Cairo Journey	All payments are non-refundable				

Scheduling Times, Routes and Excursions

We cannot be held liable for any delays due to trains not running to schedule. Off-train excursions cannot be guaranteed and will only be undertaken if time and circumstances permit. Departure and arrival times are approximate and cannot be guaranteed. We reserve the right to alter our routing at any time between departure and arrival points.

Passports & Visas

The onus is upon the client to ensure that passports and visas, as may be required, are valid. We travel through South Africa, Swaziland, Namibia, Zimbabwe, Botswana, Zambia, Tanzania, Uganda, the Sudan and Egypt on the various trips. Please check with the relevant consulates in good time regarding applications or enquire with us at Rovos Rail. Visitors to South Africa are required to have at least three blank VISA pages in their passports to receive an entry visa. Passports must be valid for at least six months from the guests' return-home date.

CONSULATES in South Africa	WEBSITE ADDRESS	CONSULATES in South Africa	WEBSITE ADDRESS
RSA DEPT OF HOME AFFAIRS	www.home-affairs.gov.za	ZAMBIA	www.zambiapretoria.net
SWAZILAND	www.swazihighcom.co.za	TANZANIA	www.tanzania.org.za
NAMIBIA	www.namibia.org.za	UGANDA	www.uganda.org.za
BOTSWANA	www.botswanaconsulate.co.za	SUDAN	www.sudani.co.za
ZIMBABWE	www.zimbabweconsulate.co.za	EGYPT	www.egypt.visahq.com

Health

- Please ensure you have filled out the **Reservation Form** to indicate if you have any medical conditions, physical disabilities or allergies. There is a basic First Aid Kit on board. We have a doctor on board on the Dar es Salaam trip.
- Anti-malaria precautions are recommended. Malaria areas: Swaziland, Kruger Park, Northern Botswana, Zimbabwe, Zambia and Tanzania. Recommended immunisations (not required): Hepatitis A, Polio, Tetanus, Cholera (low risk).
- A **Yellow Fever/Medical Exemption Certificate** is **essential** if travelling to/from **Zambia & Tanzania**. Although all countries travelled through don't require this, countries guests return to after the trip often require them.
- Please consult your clinic or doctor. TRAVEL DOCTOR AFRICA *local* 0861 300 911 or *international* +27 11 214 9030.

Currency

- South Africa – Rands only. We accept all major credit cards on the train.
- Outside of South Africa – Any off-train expenses or excursions booked while on the train are to be paid with US Dollars. Hotels and major dealers accept credit cards except in the Sudan.
- US Dollars printed before year 2001 won't be accepted. Low denominations recommended for shopping/gratuities. Larger denominations recommended for exchanging money to local currency (especially in Tanzania) as you get a better rate. The Gift Shop on board might exchange money if currency is available – it is not normally catered for.

Gratuities

Gratuities for the staff are at your discretion. If you wish to show your appreciation in this manner, there is a suitably marked envelope in your suite that you can hand directly to the Train Manager who will distribute any amounts on a pro-rata basis amongst the staff on board. An amount between US\$10 and US\$20 per person per night is suggested.

Children

Please be sensitive to the adult nature and atmosphere of the train by keeping your children respectful and quiet. Long journeys are not recommended for under 13s. There are no child-minding facilities or activities for children on board.

Locomotion

Use of steam has become increasingly difficult over the years as more and more water and coaling facilities have been scrapped. Diesel or electric locomotives are used while steam is used in and around the area of Rovos Rail Station.

The Track

The track over which we travel is inconsistently maintained. If you wake at night imagining the train is travelling at high speed, be assured it is the state of the track below that is creating that impression. We restrict the train to 60km/h and over the bad sections reduce speed to as little as 20km/h. If you find it noisy, earplugs are available.

Cuisine

Meals are served in one sitting only in the charming Victorian atmosphere of the dining cars and are complemented by a selection of fine South African wines. Breakfast: 07h00-10h00 • Lunch: 13h00 • Tea: 16h30 • Formal Dinner: 19h30. All meals are served at these times unless otherwise stated in the timetable. A gong heralds lunch and dinner.

Dietary Requirements

We will do our best to cater for dietary requirements provided a detailed request has been made on the **Reservation Form**. If a special request has not been made, the chefs will endeavour to prepare suitable meals with the ingredients available on board. We regret we are unable to provide meals requiring strict religious observance in the preparation.

Dress

For days on the train dress is smart casual. Evening attire is more formal – for the gentlemen a jacket and tie is a minimum requirement while for ladies we suggest cocktail/evening dresses or suits. Please include warm clothing for cold mornings and evenings. With regard to off-train excursions, we strongly recommend comfortable walking shoes, sun lotion and hats as well as warm clothing for the game drives, which are on open vehicles and can get very cold.

Mobile Devices and Internet

In maintaining the spirit of travel of a bygone era, there are no radios or television sets on board. The use of mobile phones, laptops and essentially anything that has the ability to disturb other passengers is confined to the privacy of your suites only. The reception is poor while the train is moving. It is advised to contact your service provider to ensure the correct settings for network services are activated. Internet is available at our Cape Town Lounge, Rovos Rail Station, Tau Game Lodge and Victoria Falls Hotel and at most of the accommodation used on the Cairo journey.

Smoking

On board the train, smoking is allowed in the Club Lounge only. Please note on the **Reservation Form** provided if you are smoking or non-smoking so that the appropriate room might be requested at the hotels. Smoking is allowed in the privacy of your suite, but please be mindful that the train is generally made up of wood; please don't throw flammable items such as cigarette or cigar butts off the train as bush fires in Africa are a constant and dangerous hazard.

Laundry

There is a limited laundry service on board comprising household washers, dryers and steam irons. The turnaround is 48 hours so we are not able to handle a week's worth of washing. Please note that while we are providing a complimentary service we cannot be held responsible for items that may be damaged or lost in the process. There are no dry-cleaning facilities en route or on board the train.

Luggage

Each suite has a luggage rack that runs its length providing ample space for storage. On selected annual journeys, guests are provided with a Rovos Rail tog bag that can be used for overnight trips or hand luggage on aircraft. On the Cairo journey, luggage will be limited to the requirements of each aircraft – enquire with reservations@rovos.co.za.

Gift Shop

There is a small gift shop on the train and at Rovos Rail Station. Due to the varying exchange rates, credit cards are preferred. The host/ess on duty has a basic First Aid Kit and personal essentials (toothbrushes, razors, earplugs etc.). He/she will also fulfil any administrative requirements and check your onward arrangements. Stamps are available for sale and postcards may be posted in the post box at the entrance to the Observation Car or at Rovos Rail Station.

Special Occasions

We would like to celebrate your special occasion with you. Upon boarding the train, please advise the Train Manager.

Books, Magazines and Games

There are board games, playing cards, a card table (dependent), books and magazines available for your use in the Lounge and Observation Cars whilst on board the train.

Electrical Current and Adaptors

220V AC 50Hz 3-point round-pronged wall plugs, 110V/220V 2-pin plugs for shavers. International adaptors available.

Safes

An electronic safe is provided in the cupboard in each suite.

Telephone

There is an internal telephone system on board. Numbers are listed on the provided Guest List.

Temperature and Air-conditioning

All public cars are fitted with gas-filled air-conditioning systems. Each suite has an individual air-conditioner with individual temperature controls that can also be set to heat mode. Fresh-air intake is solved by opening a window. Windows should be closed while operating the air-conditioning unit. Electric under-blankets are fitted on the bed.

AVERAGE TEMPS	JAN/FEB		MAR/APR		MAY/JUN		JUL/AUG		SEP/OCT		NOV/DEC		Rainfall Months	TIME ZONE
AREA	Min	Max	Min	Max	Min	Max	Min	Max	Min	Max	Min	Max		
Cape Town, RSA	16°C	27°C	12°C	25°C	6°C	20°C	0°C	18°C	9°C	21°C	13°C	25°C	May-Sept	GMT+2
Pretoria, RSA	12°C	29°C	12°C	27°C	5°C	22°C	2°C	16°C	10°C	27°C	16°C	28°C	Oct-Mar	GMT+2
Gaborone, Botswana	20°C	31°C	14°C	28°C	5°C	23°C	4°C	25°C	16°C	29°C	20°C	30°C	Nov-Feb	GMT+2
Vic Falls, Zimbabwe	18°C	29°C	14°C	29°C	6°C	25°C	6°C	28°C	13°C	31°C	19°C	32°C	Dec-Mar	GMT+2
Lusaka, Zambia	17°C	26°C	15°C	28°C	8 °C	24°C	8°C	25°C	14°C	30°C	19°C	33°C	Dec-Mar	GMT+2
DAR, Tanzania	24°C	32°C	23°C	31°C	20°C	29°C	18°C	29°C	19°C	30°C	21°C	30°C	Mar-May	GMT+3
Entebbe, Uganda	18°C	29°C	18°C	28°C	17°C	27°C	17°C	27°C	17°C	28°C	17°C	28°C	Mar-May	GMT+3
Khartoum, Sudan	17°C	32°C	22°C	39°C	27°C	42°C	26°C	38°C	26°C	39°C	19°C	33°C	Jul-Sep	GMT+3
Cairo, Egypt	9°C	20°C	11°C	27°C	17°C	33°C	22°C	34°C	18°C	32°C	11°C	24°C	Dec-Jan	GMT+2

ROVOS RAIL FACT SHEET

PRETORIA HQ 1 Transnet Ave, Capital Park 0001 • PO Box 2837 Pretoria 0001 South Africa • T: +27 (0) 12 315 8242 F: +27 (0) 12 323 0843
 CAPE TOWN 1 Adderley St, Cape Town 8002 • PO Box 50241 Waterfront 8002 South Africa • T: +27 (0) 21 421 4020 F: +27 (0) 21 421 4022
 ST JAMES MANOR Guesthouse - 108 Main Road, St James, Cape Town 7945 South Africa • T: +27 (0) 21 788 4543 F: +27 (0) 21 788 9590
 ST JAMES SEAFORTH Guesthouse - 96 Main Road, St James, Cape Town 7945 South Africa • T: +27 (0) 21 788 6778 F: +27 (0) 21 788 2428
 ST JAMES HOMESTEAD Guesthouse - 1 Ley Road, St James, Cape Town 7945 South Africa • T: +27 (0) 21 788 9250 F: +27 (0) 21 788 6185
 ROVOS RAIL E: reservations@rovos.co.za W: www.rovos.com • ST JAMES E: guesthouses@rovos.co.za W: www.stjamesguesthouses.com



TERMS & CONDITIONS

HOW TO MAKE A PROVISIONAL RESERVATION

Upon **written request** via email or fax and subject to availability, we will **provisionally** book your place on the chosen tour. No deposits are required. Space is allocated and held BUT if definite suites are required by another client, the holding agent/guest will be asked to confirm with a deposit payment (see below) or release the suite.

HOW TO CONFIRM YOUR BOOKING

Upon receipt of a **written confirmation** via email or fax and a **completed Reservation Form**, final confirmation details and an invoice will be sent to you. Upon receipt of the **relevant payment**, your booking on the chosen tour will be **confirmed**.

PAYMENT SCHEDULE

- **Individuals and Small Groups – less than 10 guests:** A 25% deposit is required to confirm the reservation. Final payment is due no later than 8 weeks prior to departure (12 weeks for Cairo journey).
- **Groups – more than 10 guests**

% A NON-REFUNDABLE DEPOSIT/INCREMENTAL PAYMENT OF THE TOUR PRICE REQUIRED	12 MONTHS OUT -48wks	9 MONTHS OUT -36wks	6 MONTHS OUT -24wks	4 MONTHS OUT -16wks	3 MONTHS OUT -12wks	2 MONTHS OUT -8wks
Cape Town, Victoria Falls, Durban			10%	10%		100%
Golf Safari, African Collage, Namibia, Dar es Salaam		10%	20%	20%		100%
Cairo Journey	25%	50%	75%		100%	

CANCELLATION POLICY *Cancellation insurance is compulsory and will not be waived*

CANCELLATIONS OF CONFIRMED BOOKINGS RECEIVED PRIOR TO DEPARTURE ARE SUBJECT TO A FEE OF THE PER PERSON TOUR PRICE	MORE THAN 12 WEEKS BEFORE	BETWEEN 12 & 8 WEEKS BEFORE	MORE THAN 8 WEEKS BEFORE	BETWEEN 8 & 4 WEEKS BEFORE	WITHIN 4 WEEKS BEFORE
Cape Town, Victoria Falls, Durban			5%	25%	100%
Golf Safari, African Collage, Namibia, Dar es Salaam	10%	25%		50%	100%
Cairo Journey	All payments are non-refundable				

RATE INCLUDES

- Three meals daily and all alcoholic and other beverages
- Excursions accompanied by a qualified tour guide
- Entrance fees to places of interest
- 24-hour full room service and bar facilities
- Limited laundry service
- Government tax

RATE EXCLUDES Staff gratuities and off-train beverages

INCLUDED in off-train accommodation on annual journeys:

- Accommodation • Meals at the lodges, hotels, clubs or resorts
- Water and limited wine selection at certain establishments

EXCLUDED from off-train accommodation on annual journeys:

- Off-train beverages (dependent) • Off-train laundry
- Telephone calls • Memorabilia purchases

PRICES We will do our utmost to keep to the prices that are published. However, if increases are forced on us we reserve the right, prior to confirmation, to amend the tour price.

SCHEDULING TIMES & ROUTES We cannot be held liable for any delays due to trains not running to schedule. Excursions cannot be guaranteed and will only be undertaken if time and circumstances permit. The departure and arrival times are approximate and cannot be guaranteed. We reserve the right to alter our routing any time between departure and arrival points.

OF SPECIAL NOTE Although certain limited insurances have been arranged, neither Rovos Rail Tours (Pty) Ltd, nor its servants, agents or employees, shall be liable for any loss or damage to passengers' luggage or effects. Insofar as one of the tours may include a visit to a game reserve and whilst attacks by wild animals are extremely rare, similarly neither Rovos Rail, nor its servants, agents or employees, accept any liability whatsoever for any injury or incidents to passengers or their belongings. The passenger hereby waives any claim which he/she may have against Rovos Rail Tours (Pty) Ltd, its servants, agents, employees or subcontractors (all of the aforementioned being collectively referred to as 'Rovos Rail') for any injury and/or loss of any nature whatsoever (including, without limiting the generality of the foregoing, consequential loss) arising for any reason of any nature whatever directly or indirectly out of any aspect of the tour including, without limiting the generality of the foregoing, any form of transport used for the purpose of the tour. This waiver shall be binding on the passenger's executors, heirs, trustees and dependants. The passenger records that all the services and facilities provided to the passenger are accepted voluntarily and with full knowledge that they may expose the passenger to injury, danger or loss. The passenger further records that any statement, representation or information given to him/her by Rovos Rail shall, unless given in writing, not prejudice this waiver in any manner whatsoever. The passenger indemnifies Rovos Rail in respect of any claim that may be made by any third party against it arising out of any claim in respect of which the passenger gives the aforementioned waiver. This agreement shall be governed solely by laws of the Republic of South Africa.

WHETHER THE PASSENGER RETURNS A SIGNED COPY OF THESE CONDITIONS OR NOT, THE CONDITIONS WILL BE DEEMED TO HAVE BEEN ACCEPTED AND WILL BE IN FORCE UPON CONFIRMATION OF THE BOOKING.

I, or the person/s on whose behalf I am making this booking, have read and accepted the conditions above.

Date of Trip:	Route:	Signature:
Name:		