

# One&Only

CAPE TOWN

*South Africa*



## PREMIER MARINA TABLE MOUNTAIN ROOM

All 23 Premier Marina Table Mountain Rooms on the fourth and fifth floors in the crescent-shaped Marina rise building, offering enhanced exceptional views from a large private balcony of Cape Town's iconic Table Mountain. Each has undergone an extensive interior refurbishment, crafted using thoughtful textures and organic materials, working to create not only a space, but a whole experience and story. Enter and be greeted by warm lighting, an earthy colour scheme and a mud cloth adorned entrance, whose fabric inspired by the traditional Mali creates an authentically African welcome. The space is a perfect blend of nature and design, modernity, and tradition. Every element was carefully considered, such as the painstakingly hand-painted dome shaped gemstone depiction piece above the curved headboard of the bed, the handmade ceramics representing the textures and colours of Table Mountain and the beaded pots representative of the vessels carried on the heads of the people of Africa, transporting the lifeblood of earth - water - to their families. With either either an inviting king bed or two queen beds, these spacious rooms are also able to inter-lead, creating for the ideal, luxury living that allows for all to enjoy the space as a family-style room. Each room offers a generous bathroom with a rain shower, a freestanding egg-shaped bath, dual marble vanities and a private water closet. The bathrooms are connected to a stylish closet, that includes a full-length mirror and multiple amenities.

### ALL ROOM RATES ARE INCLUSIVE OF THE FOLLOWING

- Full Concierge service
- Personalised welcome drink upon arrival
- Breakfast spread & a la carte hot meals in Ochre Restaurant daily
- Complimentary wireless internet throughout the resort
- Use of the exclusive Spa Thermal Suites
- Use of the state-of-the-art Fitness Centre
- Secure underground parking
- Transfers to and from the V&A Waterfront
- Housekeeping service twice daily at your convenience
- One&Only bottled mineral water daily (sparkling/still dependent on preference)

### FOR THE FAMILY

- Age-appropriate welcome gifting
- Complimentary dining for children under 12 years when ordering from the KidsOnly menu
- Complimentary use of KidsOnly Club facilities, including a daily programme of supervised activities for 4-11-year-olds
- Babysitting facilities (on request at an additional charge)
- Baby convenience items and toiletries available upon request
- Complimentary use of: Baby cot, highchair, bottle warmer, sterilizer and microwave

### ROOM FACILITIES

- Either one King bed or two Queen beds (not interchangeable)
- Private balcony
- 55-inch flat screen TV
- Bathroom with dual marble vanity, rain shower and egg-shaped oversized bathtub
- Nespresso Machine
- A selection of teas and Nespresso coffees
- Luxury bathrobes and slippers
- Personal in-room safe
- Full-sized amenities



## PREMIER MARINA TABLE MOUNTAIN ROOM FLOOR PLAN

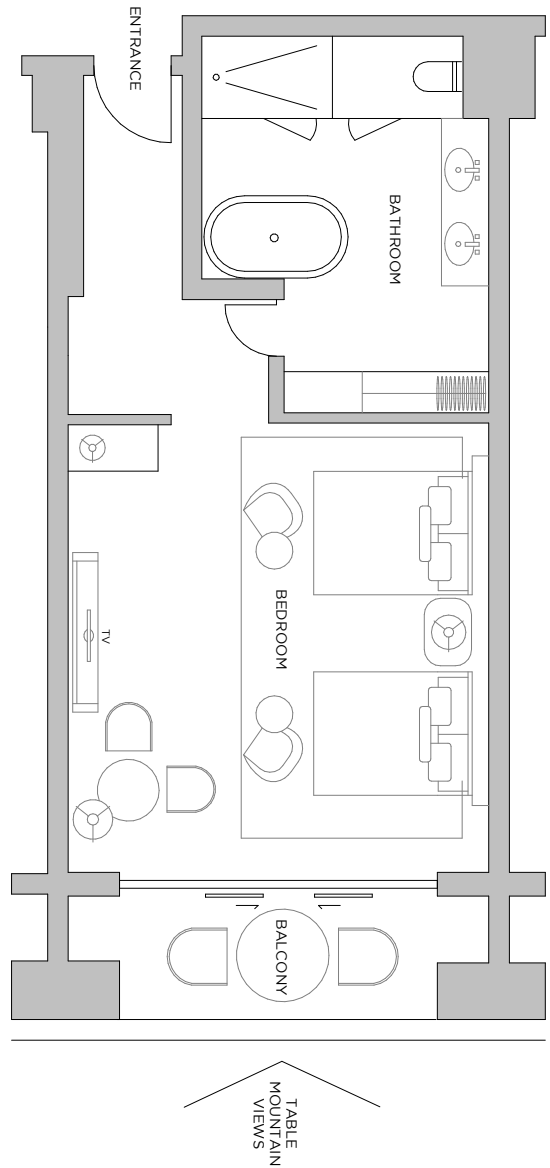
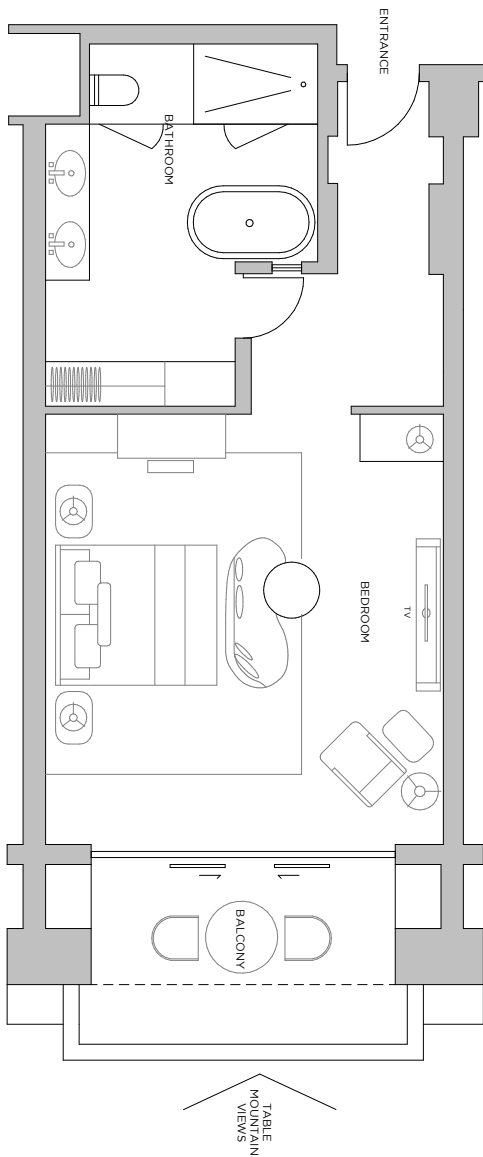

oneandonlycapetown.com

+27 21 431 5800 reservations@oneandonlycapetown.com  
 Dock Road, Victoria & Alfred Waterfront, Cape Town, South Africa