

LODGE FACT SHEET 2024

MORE Family Collection; Monwana Game Lodge Pg1 | Residence Pg2
Highlights; Location and Info Pg2 | Architectural Layouts Pg3 | Reference Table Pg5

Monwana Lodge | Tel: +27 (0)13 591 5455

MORE Family Collection - Head Office/Reservations | Tel: +27 (0)11 880 9992 | Email: res@more.co.za

www.more.co.za

MORE Family Collection owns and manages a collection of luxury safari lodges, boutique hotels, and exclusive-use residences in South Africa and Zimbabwe offering seamless itineraries between our properties. Led by custodian and CEO Robert More, ours is a fourth-generation family business - our origin dates to 1933 when our great grandfather Guy Aubrey Chalkley purchased the land that Lion Sands Game Reserve was later established on. We now have four luxury lodges at Lion Sands.

Our footprint is in four unique safari reserves - Sabi Sand, Kruger, Thornybush, and Victoria Falls - and our hotels in the vicinity of two Natural Wonders of the World, namely Table Mountain and Victoria Falls. Our properties include Lion Sands Game Reserve (Mpumalanga), Marataba Luxury Lodges and Monwana Game Lodge (Limpopo), Cape Cadogan Boutique Hotel and More Quarters Neighbourhood Hotel (Cape Town), Stanley & Livingstone Boutique Hotel and Ursula's Homestead (Victoria Falls). We are committed to protecting the environment, community development, sustainability principles, and delivering on our purpose of creating life-enriching experiences for our guests.

About Monwana

Thornybush Nature Reserve is part of the Greater Kruger National Park, one of Africa's oldest and richest protected wilderness areas. It is home to the famed Big Five (lion, leopard, elephant, rhino and buffalo), and countless other beautiful creatures in their natural habitats. The reserve has many species of large mammals and is well-known for the quality and quantity of its sightings of Africa's most elusive cat - the leopard.

Being part of a private 14,000-hectare reserve means that guests enjoy personal, uncrowded, unrushed, and close contact sightings. The wildlife density on this tract of land is quite extraordinary, thanks to the rivers, landscapes and vegetation, and the unfenced border with the Greater Kruger National Park.

Morning and afternoon game drives and our guided bush walks bring our guests closer to this amazing natural world. Our highly qualified field guides and trackers share their diverse knowledge and we throw in a few surprises along the way.

About the Lodge

Monwana Game Lodge embodies the spirit of *coming home*, home to the body, mind and soul in this incredible natural world that allows for breathing space and reconnection. Monwana is a luxurious lodge, which promises an utterly customised private safari experience in Africa.

The main lodge has double volume vertical space, massive cathedral windows and doors that open wide so one feels part of the bush. The main lodge is designed as a space to socialise or find a spot to call your own, whatever is preferred. There is a lounge, bar, wine cellar, boutique store, a large wraparound deck, a spa, fitness centre, and a lap pool.

Monwana's environment is always intimate and private and each of the Suites occupies its own unique space in the African bush, where you will feel as if it's just you in this vast natural habitat. We know how magical the atmosphere is and have created spaces for you to enjoy it. Recline on the deck, take a shower in the open or cool off in your private plunge pool.

Our Suites

We have six spacious **Suites** - four Suites that can cater for two adults; and two **Family Suites** with a 2nd en-suite bedroom that can comfortably accommodate two adults and up to three children.

All Suites have their own private shaded deck, with an incredible bush view that can be enjoyed from the heated plunge pool and outdoor shower. There is central air-conditioning and overhead ceiling fans to ward off the summer heat, while underfloor heating and heated towel rails in the bathroom take the edge off a chilly winter's evening. With the highest quality linen, towels, gowns and luxurious amenities, to ensure our guests feel pampered and spoiled.

About the Residence

Monwana Residence is a large exclusive use living space, with sweeping views over the bushveld, with two en-suite bedrooms that caters for four adults and two children. The Residence includes a fully equipped interactive kitchen, lounge, and dining area. The wide deck, barbeque area, and fire deck are perfect for relaxing after a fantastic day in nature. There is a dedicated team that includes a private chef and residence butler, plus private game viewing vehicle and dedicated field guide team, making for a memorable African adventure experience.

As part of this intimate residence environment, additional guests can be accommodated at one of the luxury suites.

Highlights

- Thornybush Nature Reserve shares an unfenced border with the Greater Kruger National Park with an abundance of non-migratory species, including the Big 5, that guarantees an exceptional safari experiences all year round
- There is an active waterhole and a dry riverbed in front of the lodge that sees the passage of a diversity of wildlife
- An intimate lodge environment that caters for a maximum of 24 guests
- Exceptional, FGASA-accredited Field Guides and highly knowledgeable Trackers
- Only six people per safari vehicle
- A private open safari vehicle is allocated to Monwana Residence guests, and to families travelling with children staying in a Family Suite
- Exceptional dining in beautiful locations – no two dining experiences are ever the same
- Our food ethos is designed around an authentic and informal bistro ambience, with fresh, healthy, sustainably and ethically sourced produce
- All dietary needs are accommodated - Vegan, Vegetarian, Reducetarian, Halal etc - and Kosher can be arranged with advance notice (at an additional cost)
- Wine tasting experiences in our amply stocked wine cellar
- A spa with a range of therapeutic treatments, and a fitness centre that offers weightlifting, cardio, and yoga
- Daily scheduled flights from Johannesburg and Cape Town to Hoedspruit Airport
- Federal Air daily shuttle flights from major game reserves
- For Federal Air shuttle flights and private charters, the closest airstrip to Monwana is the Thornybush Airstrip
- Easily accessible by road from Johannesburg and Nelspruit
- Seamless itineraries can be arranged between the MORE Family Collection properties

Location

Monwana Lodge is located on Guernsey Road in Thornybush Nature Reserve, a private 14,000-hectare reserve that shares an unfenced border with the Greater Kruger National Park in the Limpopo Province of South Africa.

GPS co-ordinates: 24°24'50"S | 31°09'30"E

Weather

The average maximum temperatures range from 24°C/75°F in July to 33°C/90°F in January, with the lowest average minimum occurring in July at 8°C/46°F • The average annual rainfall is 350mm (14in), most of which occurs during midsummer (December – February) • Rain is usually in the form of thundershowers, where a downpour is experienced, very seldom lasting longer than a few hours.

Best Time to Travel

A year-round safari destination • The animals in Thornybush Reserve are non-migratory, and variation in the safari experience is season-, rather than location-, related • The best period for birdwatching is from October to April.

Health Info: Malaria

Thornybush Nature Reserve is located in a low-risk malaria area, but we do recommend that you consult with your doctor regarding anti-malarial prophylactics before visiting.

Monwana Lodge Layout

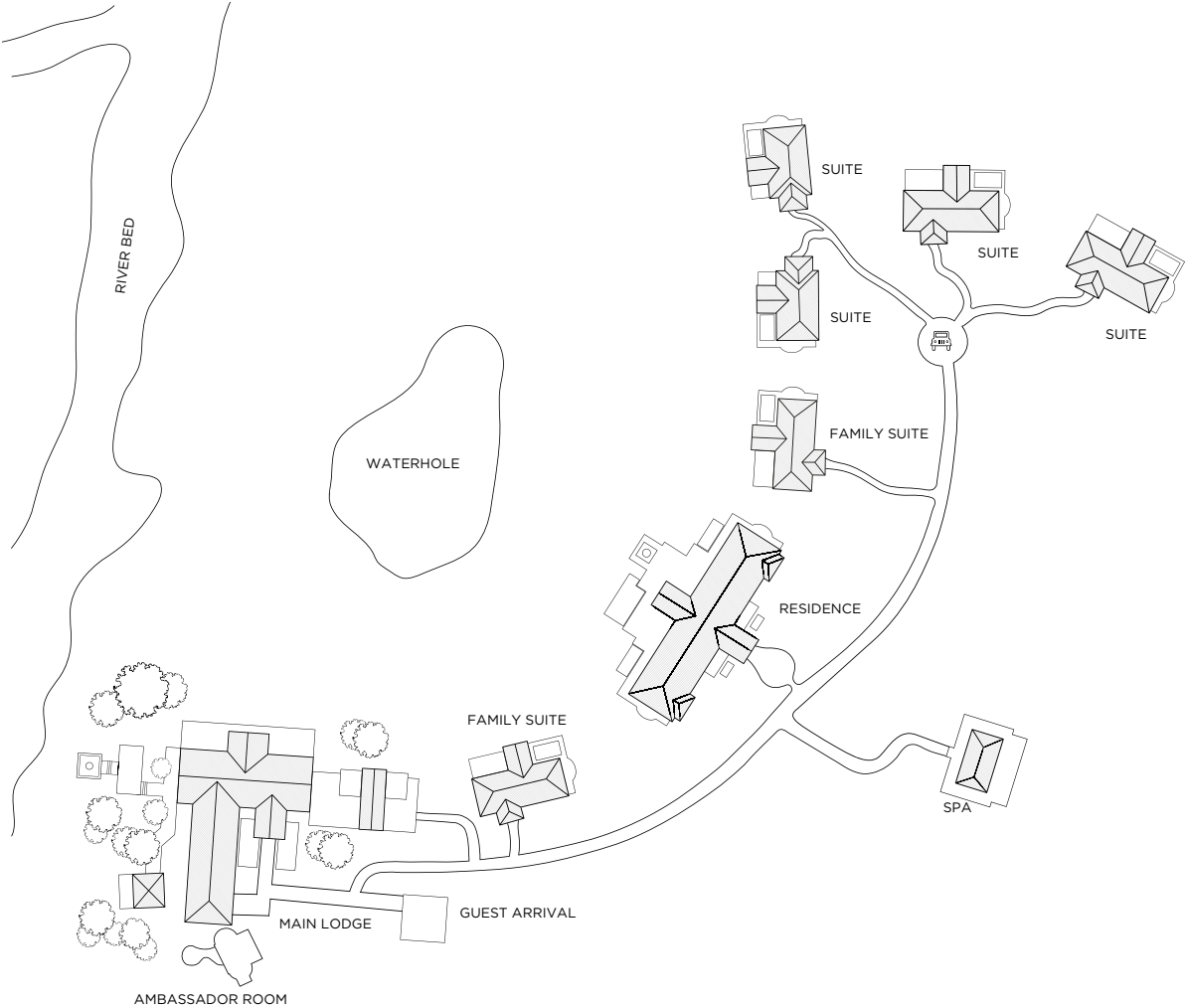

Suite Layout

Internal suite area - 1 055ft² | 98m²
 Covered terrace - 215ft² | 20m²
 Open deck area - 375ft² | 35m²
 Total - 1 647ft² | 153m²

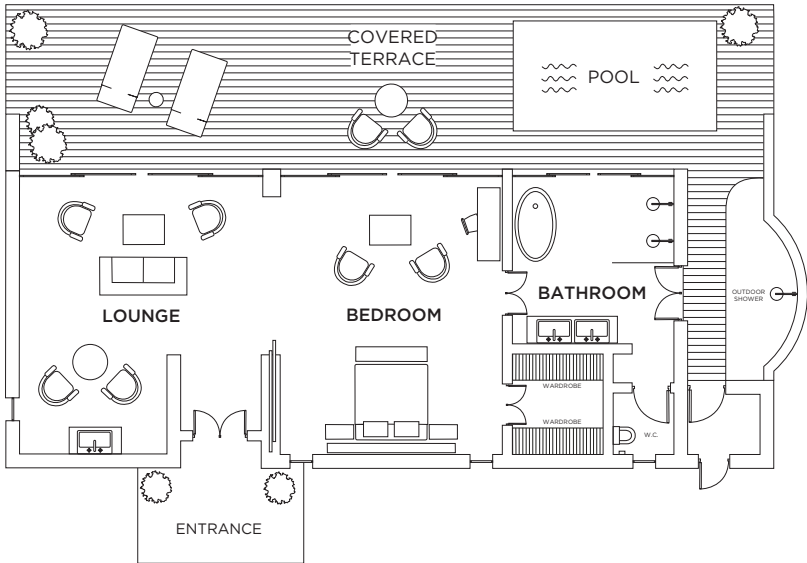

Family Suite Layout (2-bedroom)

Internal suite area - 1 055ft² | 98m²

Covered terrace - 215ft² | 20m²

Open deck area - 375ft² | 35m²

Total - 1 647ft² | 153m²

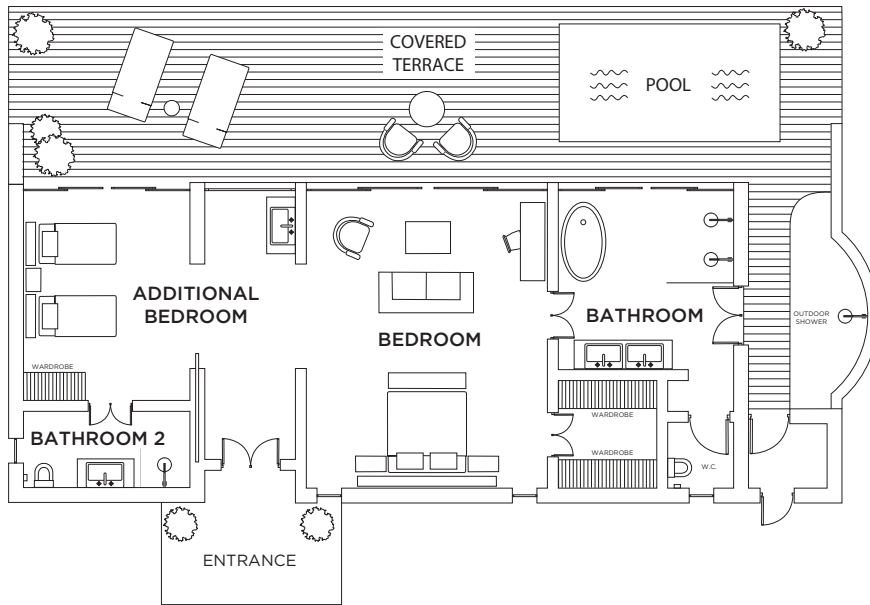

Monwana Residence Layout

Internal area - 3 337ft² | 310m²

Covered terrace - 861ft² | 80m²

Open deck area - 1 399ft² | 130m²

Total - 5 597ft² | 520m²

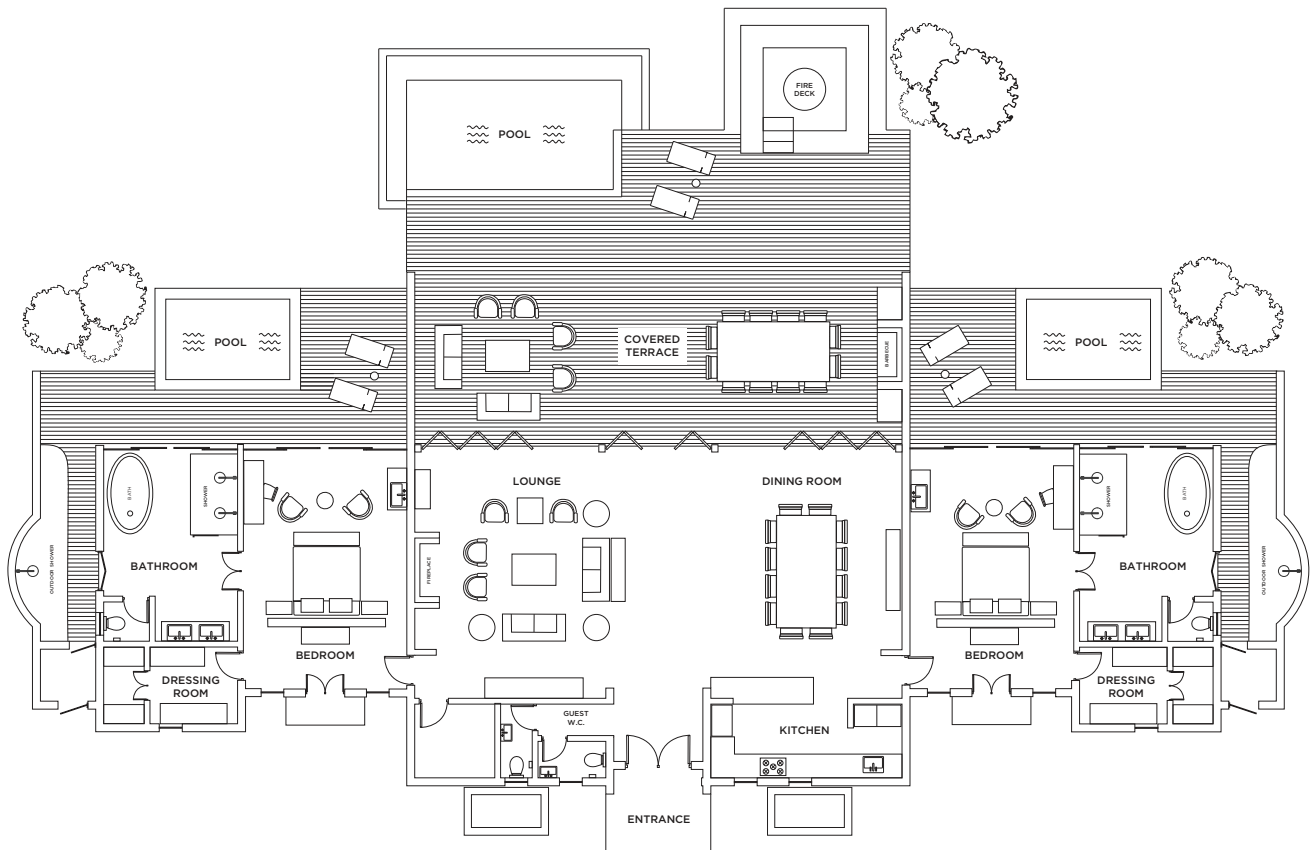

Reference Table - Monwana Game Lodge and Monwana Residence

Reference	Monwana Game Lodge and Monwana Residence
Suites	4 Suites 2 Family Suites 1 Monwana Residence
Size of suites	Suites: 1 055 ft ² /98 m ² Family Suites: 1 055ft ² /98m ² Residence: 3 337 ft ² /310 m ²
Guests	24
Children	Yes: >10 years Family Suites (max 2 adults and 3 children) Monwana Residence (4 adults and 2 children)
Children on safari	Twice-daily game drives (>10 years) In line with reserve protocols, no person below the age of 16 may participate on guided bush walks
Children activities	No
Childminding	Yes (additional cost)
Single traveller supplement	Yes (50% supplement)
Central guest pool	Yes (12m lap pool)
Private plunge pool	Yes (heated)
Air conditioning	Yes
Room fans	Yes
Mosquito nets	Yes
Outdoor shower	Yes
Underfloor Heating	Yes
Indoor showers	Yes
Separate WC	Yes
Free Wi-Fi	Yes (all areas)
Satellite television	No
In-room telephone	Yes (direct dial)
Mobile coverage	Fair
In-room safe	Yes
Personal bar	Yes
Hairdryer	Yes
Laundry service	Yes (included)
Conference facilities	No
Spa	Yes
Fitness Centre	Yes
Suitable for disabled guests	No
Distance between rooms	20-25m/60-75ft
Closest airport	Hoedspruit Eastgate Airport (HDS) (45 minutes away)
Helipad	Yes
Chartered Flights	Can be arranged
Guests per open safari vehicle	6
Private open safari vehicle	Monwana Residence (included) Suites (additional cost, subject to availability) Family Suites (included)
Languages of field rangers	English, Afrikaans, Shangaan, Zulu
Gratuity recommendation	ZAR750* per room per day Monwana Residence ZAR1500* per day *Specific allocations clarified on request
Kosher dining	Booked with prior notice and at an additional cost
Power	220V AC
Credit cards	Mastercard, Visa, Amex
Cheques	Not accepted